

Installation Guide

Mounting Kit – Philips MX800/MP20/30/40/50/60/70 on Left Side and EGM on Top of Datex-Ohmeda Avance

The purpose of this guide is to describe:

1. Attachment of Top Plate.
2. Attachment of Camlock Mounting Plate.
3. Attachment of table top mount.
4. Attachment of Down Post.
5. Mounting of M-Series Arm.



WARNING: USE OF MOUNTING HARDWARE AND MONITORING COMPONENTS OTHER THAN THOSE DESCRIBED IN THIS DOCUMENT MAY RESULT IN SERIOUS INJURY DUE TO TIPPING OF THE ANESTHESIA MACHINE.

WARNING: ALL DEVICES AND MOUNTING EQUIPMENT SHOULD BE POSITIONED INWARD, CLOSE TO THE ANESTHESIA MACHINE, DURING TRANSPORT.

Installer: When installation is completed, provide these instructions and all related documentation to the end user for future reference.

Parts Reference

The parts list below includes the parts and hardware that will be used in this installation procedure (see photo for parts; hardware not shown).

Item #	Description	Qty
1	Top Plate/Camlock Rail Assembly	1
2	M6 x 12mm Flat Head Machine Screw (FHMS)	4
3	Camlock Mounting Plate	1
4	M6 x 10mm Flat Head Machine Screw (FHMS)	3
5	M4 x 20mm PHMS	2
6	#6-32 x 3/8" PHMS	1
7	M-Series Arm with Table Top Mounting Adapter	1
8	M6 x 8mm Flat Head Machine Screw (FHMS)	2
9	M6 x 12mm FHMS	1
10	Down Post, 6"	1
11	#10-32 x 3/8" Socket Head Cap Screw (SHCS)	3
*12	Spacer, MP20/30	1
*13	M6 x 16mm Pan Head Machine Screw (PHMS)	2
14	5/32" Hex Wrench	1
15	1/8" Hex Wrench	1

* See "Mounting MP20/30 on non-Table Top Mount" (page 6) for use of these parts.

Top Plate/Camlock Rail Assembly



Camlock Mounting Plate



M-Series Arm with Table Top Mounting Adapter



6" Down Post



*MP20/30 Spacer

Tools Required: Phillips screwdriver (not provided), 5/32" and 1/8" hex wrenches (provided).

Attaching Top Plate/Camlock Rail Assembly

1. Remove all instruments attached to top of machine. Locate the four (4) threaded inserts in top of the machine shown below left. **Installation Note:** Threaded inserts may be covered by plastic hole covers. Remove hole covers as required.
2. Align Top plate with threaded inserts and fasten Plate to machine with four (4) M6 x 12mm FHMS (below right).

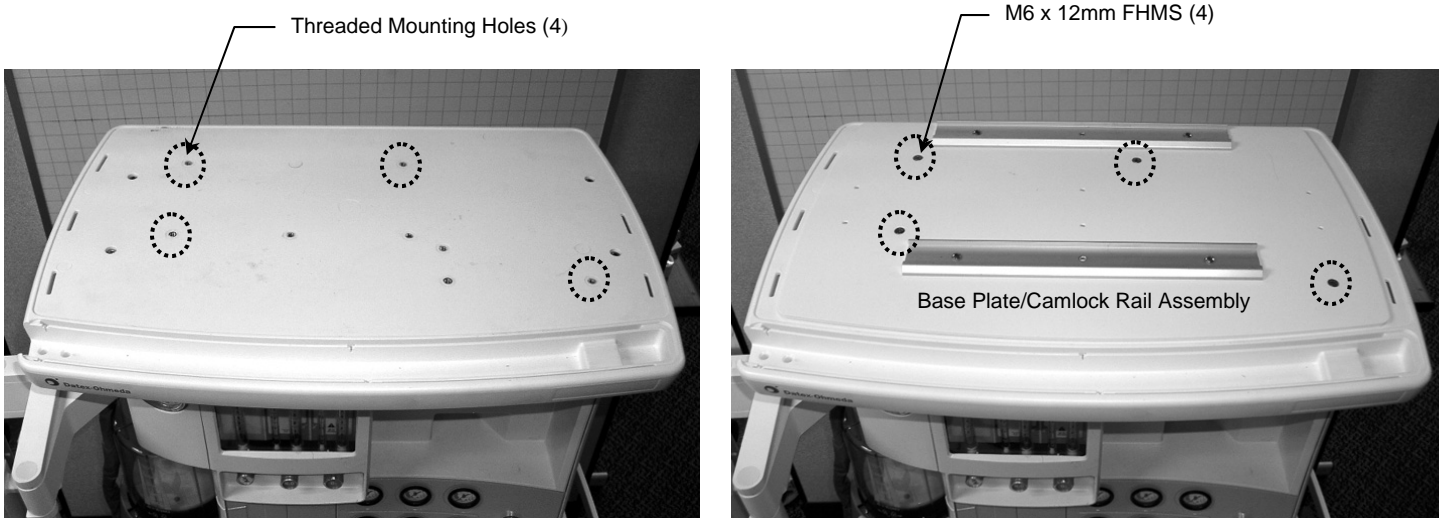

Attaching Table Top Mount to Camlock Mounting Plate

Installation Note: Table Top Mount is supplied by Philips.

1. Fasten Table Top Mount to Camlock Mounting Plate with three (3) M6 x 10mm FHMS.

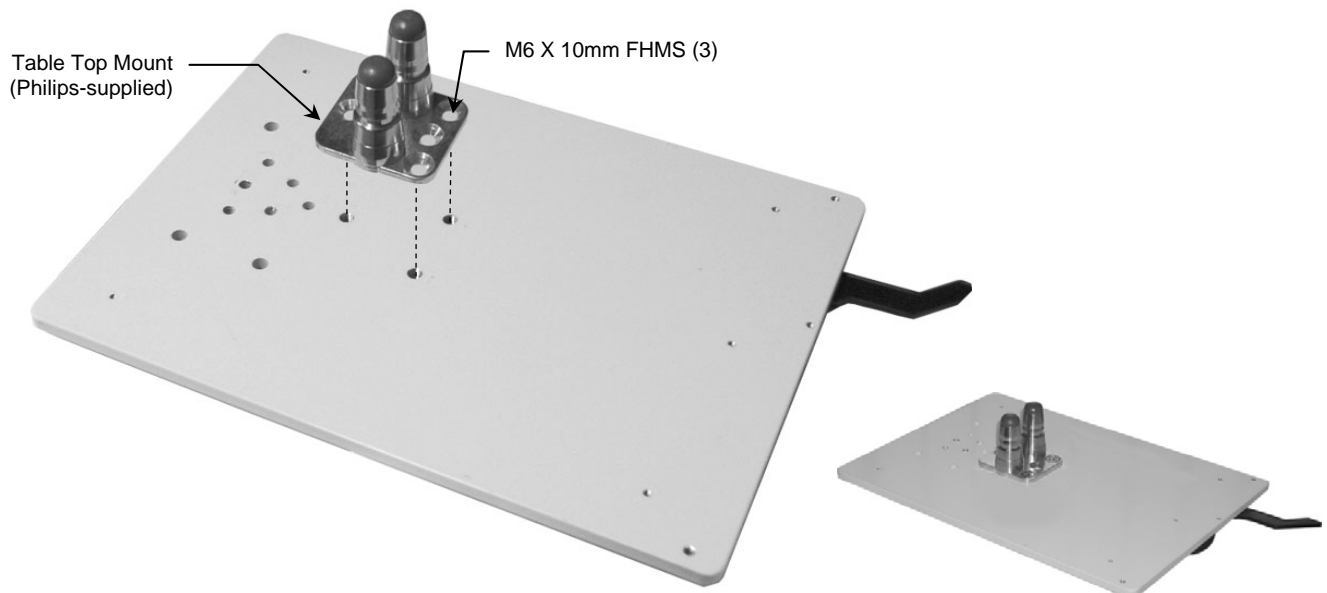

Mounting Camlock Mount in Camlock Rails

1. Insert the four (4) feet (bottom of Camlock Mount) into the Camlock Rails (photo below left).

Installation Note: Camlock Lever must be in the "unlocked" position when mounting feet in Rails. After inserting the feet, lock the Mount in place by moving the Camlock Lever from right to left.

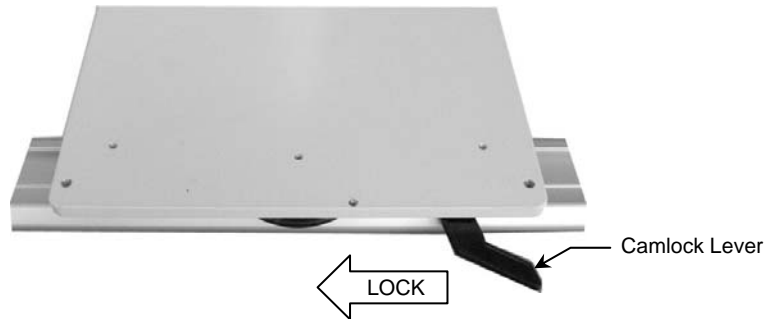
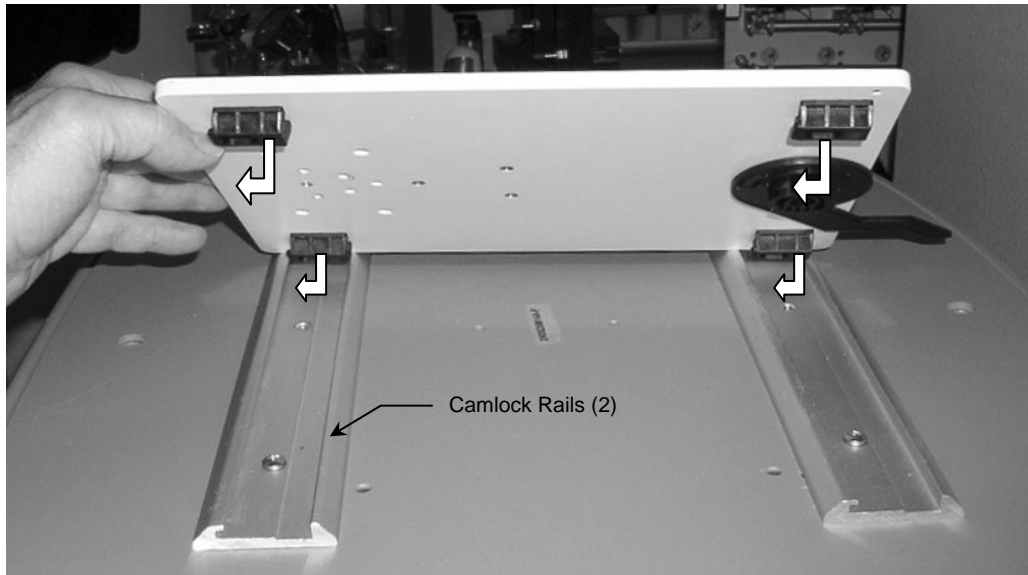

2. To prevent the Camlock Lever from being unlocked, insert one (1) #6-32 x 3/8" PHMS in the threaded hole to the right of the Lever (below right). To further secure the Camlock Mount in the Rails, insert one (1) M4 x 20mm PHMS in each of the two (2) threaded holes at the rear corners of the Mount (below right). Stop tightening these screws when they make contact with the bottom of the Rail.

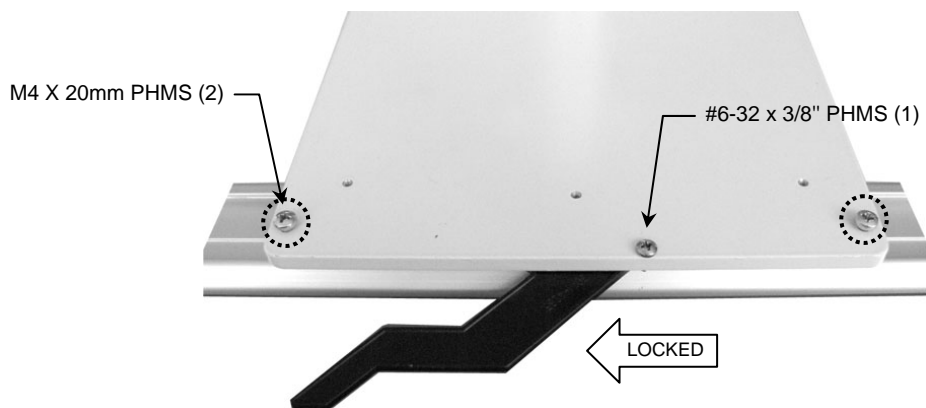

Attaching the *Philips Table Top Mount to Mounting Adapter on M-Series Arm

Installation Note: Do not attach the Table Top Mount to the Arm/Mounting Adapter if you will be mounting an MP20/30 monitor equipped with the mounting interface shown in below. See "Mounting MP20/30 on non-Table Top Mount" (page 6) for instructions specific to this type of mounting interface.

Do Not Attach Table Top Mount if MP20/30 Monitor is Equipped with This Mounting Interface



1. Fasten the Philips-supplied Table Top Mount to the Mounting Adapter (front end of Arm) with one (1) M6 x 12mm FHMS and two (2) M6 x 8mm FHMS.

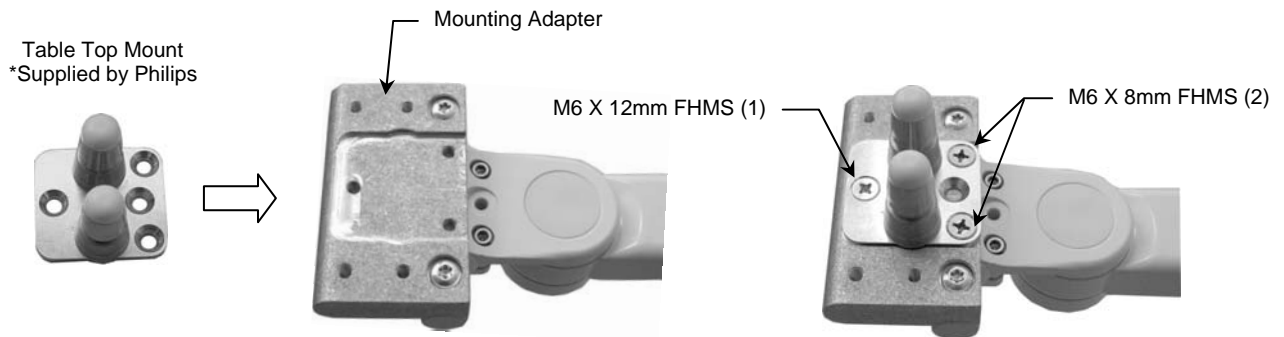

*Attaching the Down Post to the Arm

*The Down Post is used for mounting the Flexible Module Server (FMS). Skip this procedure if your IntelliVue monitoring system does not require a Down Post or FMS.

1. Remove the plastic bolt cap from the bottom of the Swivel Cup (front end of Arm).
2. Align the three (3) mounting holes in the Lower Post Disc with the three (3) threaded holes in the Swivel Cup.
3. Using the 5/32" hex key provided, fasten the Post to the Swivel Cup with three (3) #10-32 x 3/8" SHCS.

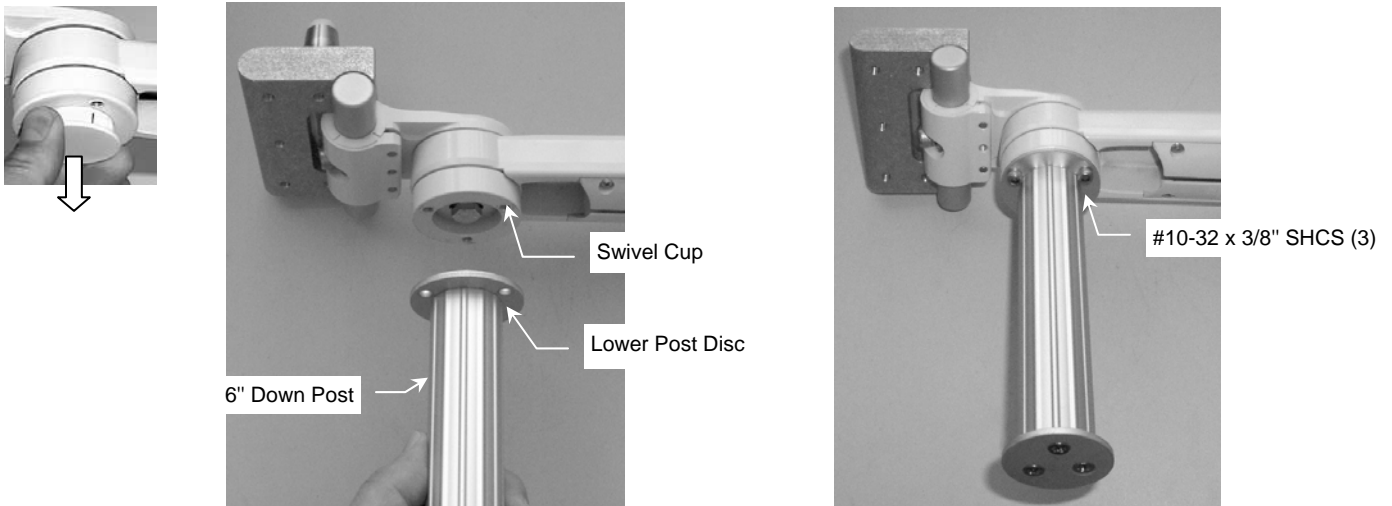

Mounting the M-Series Arm on the Left Side of the Avance

1. Guide the Slide (rear of Arm) into the top of the left-side channel and lower the Arm to the bottom of the channel. Using the 1/8" key provided, tighten two (2) socket set screws at the bottom of the Slide.

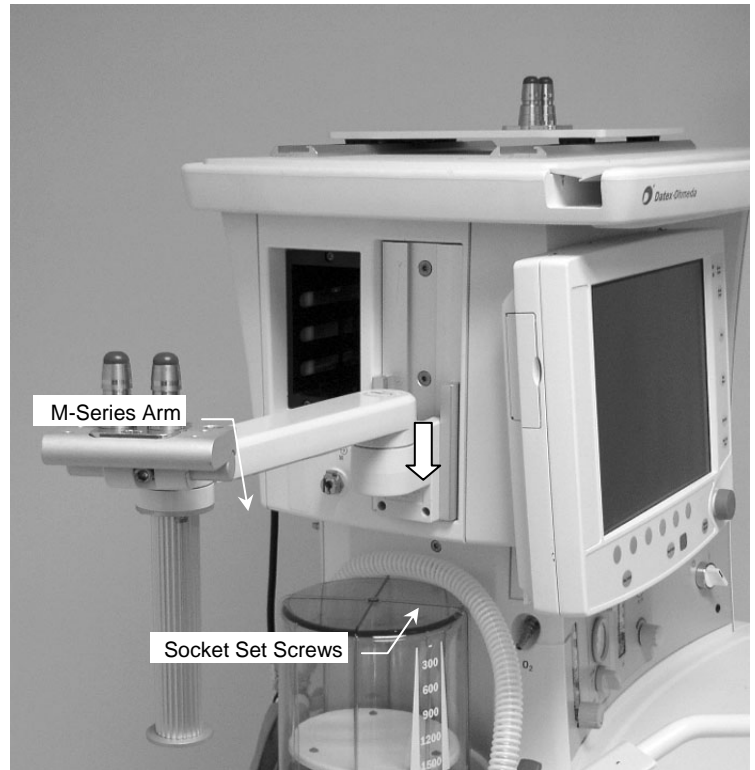

Mounting Instruments on Table Top Mounts

Mount monitor and EGM in accordance with Philips Table Top Mount instructions.



Mounting MP20/30 on non-Table Top Mount

MP20/30 non-Table Top Mount

1. Fit Spacer into recessed area on top of Mounting Adapter (below). Ensure Spacer remains between Mounting Adapter and monitor.
2. Insert two (2) M6 x 16mm PHMS through bottom of Mounting Adapter and thread into mounting holes in bottom of monitor (right).

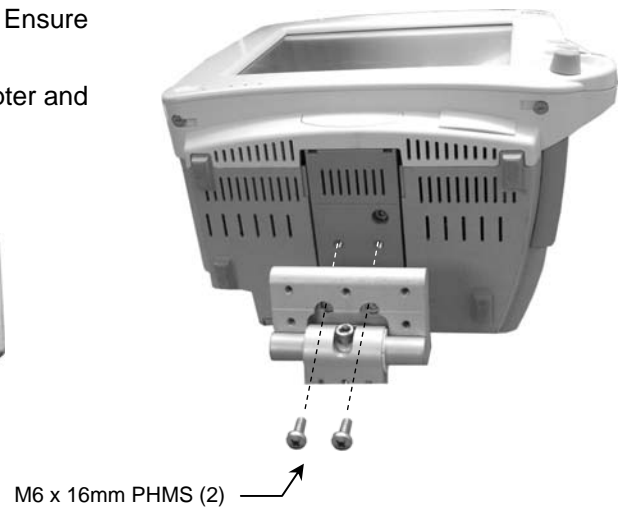
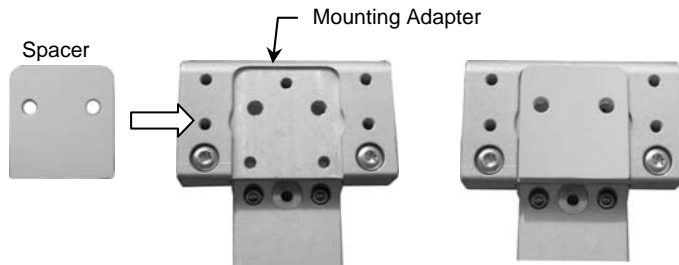

Mounting the Flexible Module Server (FMS) on the Down Post

Installation Note: This procedure is not required if Down Post has not been installed.

1. Attach the FMS to the Down Post by placing the Clamp around the Down Post and tightening the knob.

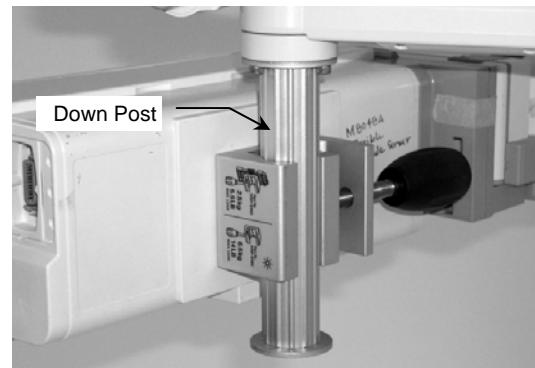
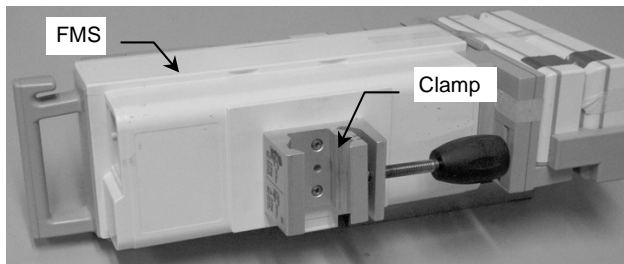

M-Series Arm Operation and Adjustment

Adjusting Swivel Tension

1. Using a 1/2" socket wrench, tighten or loosen the Swivel Tension Nut for desired resistance.

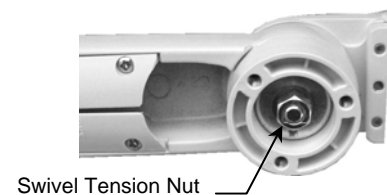

Adjusting Tilt Tension

1. Using the 5/32" hex wrench supplied, equally tighten or loosen the two (2) tilt tension screws.

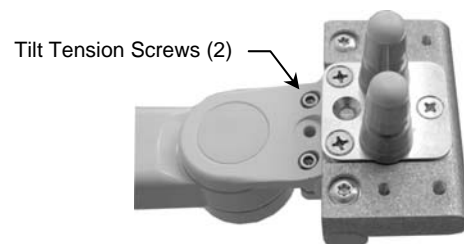

Adjusting Pivot Tension

1. Using a 1/2" [13 mm] socket wrench, loosen or tighten the Pivot Tension Bolt.

Cable Management

Two cable management features allow convenient placement and flow of cables:

1. An open cavity beneath the arm (with flexible cable covers) allows management of cables between the front and rear of the arm.
2. A "pass-through" channel at the rear of the slide allows cables to pass behind the arm within the Channel.

Note: If cable connectors are too large to fit through the pass-through, try placing the cables in the "pass-through" before installing the arm in the Channel. Contact GCX for optional Channel Covers available to further manage the flow of cables in the Channel.

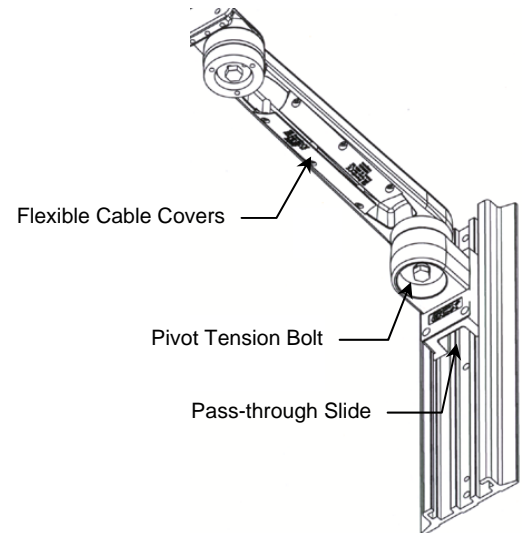

Routine Maintenance

Periodically check all mounting hardware. Tighten as necessary for optimal operation.

Cleaning the Mounting Assembly

1. The mounting assembly may be cleaned with most mild, non-abrasive solutions commonly used in the hospital environment (e.g. diluted bleach, ammonia, or alcohol solutions).
2. The surface finish will be permanently damaged by strong chemicals and solvents such as acetone and trichloroethylene.
3. Do not use steel wool or other abrasive material to clean the mounting assembly.
4. Damage caused by the use of unapproved substances or processes will not be covered by warranty. We recommend that you test any cleaning solution on a small area of the arm that is not visible to verify compatibility.
5. Never submerge the arm, and do not allow liquids to enter the arm. Wipe any cleaning agents off of the arm immediately, using a water-dampened cloth. Dry the arm thoroughly after cleaning.

CAUTION: GCX makes no claims regarding the efficacy of the listed chemicals or processes as a means for controlling infection. Consult your hospital's infection control officer or epidemiologist. To clean or sterilize mounted instruments or accessory equipment, refer to the specific instructions delivered with those products.