

**PHILIPS**

Professional Lighting

RoadGrace



Enhance the city with  
a new way of light

# A new benchmark for LED roadway lighting



We now light up roads differently. It's no longer just about functionality as it is also about how road lighting can effortlessly complement new areas, and seamlessly retrofit into existing areas.

With the RoadGrace LED luminaire, you can upgrade to an energy efficiency solution, and amazing flexibility with its five optic options, optimized for multiple road and street applications, such as freeways, intersections and crosswalks.

## Features & benefits:

- Designed to withstand extreme temperatures with superior thermal management (-40 to 50C Ta)
- Top-class LED that ensures reliability and a long 100,000-hour lifetime. Cities save on maintenance costs and safeguard the community's safety, sustainably.
- Easy to install, it has tool-less access and an adjustable mounting spigot design that enables customization of the lighting set-up to achieve the desired effect.
- Comes with five optic options, optimized for various road and street applications.

# The road to brightness

## Configurations

Supports CityTouch, 1-10V/DALI/Amp/Dynadimmer controls, and 7 Pin NEMA socket

Lumen Output up to 8,700lm for small housing

17,000lm for medium housing

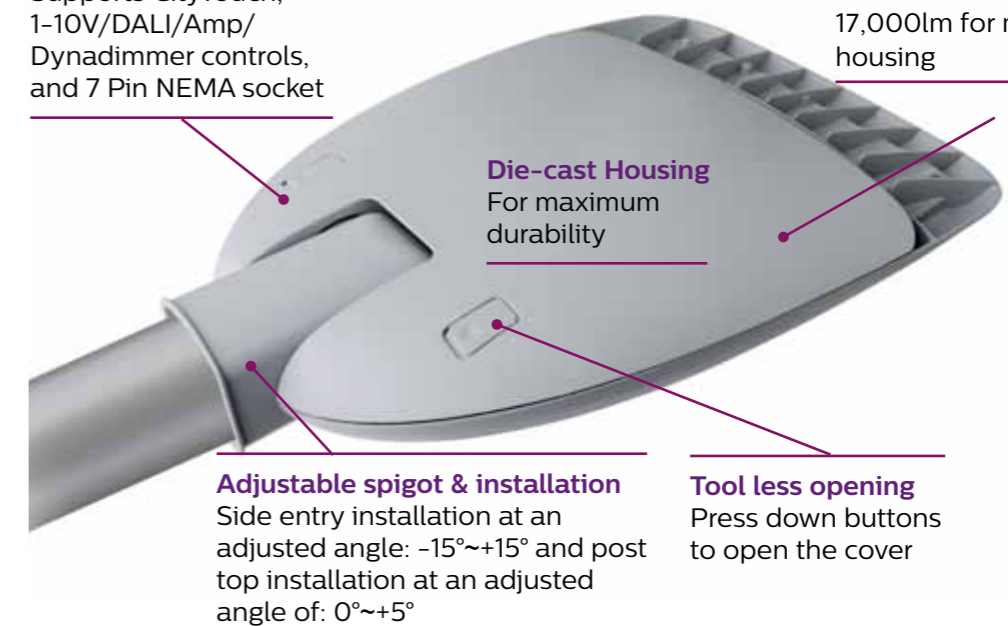

**Die-cast Housing**  
For maximum durability

## Adjustable spigot & installation

Side entry installation at an adjusted angle: -15°~+15° and post top installation at an adjusted angle of: 0°~+5°

## Tool less opening

Press down buttons to open the cover

## Applications

- Freeways
- Intersections
- Crosswalks

## RoadGrace Configurations



On-off luminaire

Integrated with CTC

With PE cell

Support CityTouch, 1-10V/DALI/Amp/Dynadimmer controls and 7 Pin NEMA socket

# Take the next step

See how Philips RoadGrace LED Luminaires can provide a complete solution for your roadway lighting needs. Contact your local Philips Sales Representative or visit for more information or to schedule a personalized demonstration.

# Product data

## General Characteristics

Model	RoadGrace
Electric class	Class I and Class II
Cover	Transparent and weather resistant grade Polycarbonate
Color consistency (SDCM)	SDCM 5 at Luminaire level

## Technical Characteristics

System lumen output (lm)	Small Housing up to 8,700lm Medium Housing up to 17,000lm
Color temperature CCT	3,000K, 4,000K, 5,700K
CRI	Min 70 additional option of CRI 80
Housing material	High pressure die-cast aluminum (ADC1)
Optics	BRP711 - DM, DW1, DW2, DWP, DWP3 BRP712 - DM, DW1, DW2, DWP3
Service Lifetime	100,000 hours (L70 at Ta 35C)
TM21 Projection	100,000 hours L80 160,000 hours L70
Power factor	0.9
Ingress protection IP	IP66
Impact resistance IK	IK08
Working temperature	-40 to 50C
Input voltage	220V-240V 50/60Hz additional option of 120V-277V and 100V-277V (for Japan)
Working humidity	Up to 95%
Surge protection	15KV/KA
Control interface	CityTouch Ready, 1-10V/DALI/ Amp/Dynadimmer, 7-Pin NEMA

## Product Information

Dimensions (LxWxH)	BRP711: 584 X 388 X 87 mm BRP712: 683 X 388 X 87 mm
Weight	BRP711: 6.8kg BRP712: 7.4kg
Housing Colour	Light Grey - RAL7040
Mounting	Φ25-34mm pole; Side-Entry with Adjustable angles +/- 15 degrees  Φ42-60mm pole; Side-Entry with Adjustable angles +/- 15 degrees
Certifications	Φ60-77mm pole; Post Top with Adjustable angles +/- 5 degrees  CB IEC60598, AS/NZS60598, TS1158, PSE, CE, RoHS

## Ordering Information

BRP711 LED26/NW 20W PSU DWP3 ANZ  
BRP711 LED32/NW 26W PSU DWP3 ANZ  
BRP711 LED44/NW 36W PSD DWP3 P7 ANZ  
BRP711 LED67/NW 56W DWP3  
BRP711 LED88/NW 73W DWP3  
BRP711 LED85/NW 70W PSD DWP3 CT  
BRP711 LED44/NW 36W PSU II DWP3  
BRP712 LED111/NW 91W DM  
BRP712 LED131/NW 108W DM  
BRP712 LED151/NW 125W DM  
BRP712 LED171/NW 142W DM  
BRP712 LED171/NW 142W PSU II DM

*More Options available*

*Description Abbreviations:*

*"ANZ" denotes TS1158 and Φ25-34mm side-entry spigot*

