

**PHILIPS**

*ClassicStreet*

Public lighting



Product guide

**Echoing  
the past,  
shaping  
the future**



# ClassicStreet



## Always in style

Timeless elegance, that is the heart of the new ClassicStreet range. The design is reminiscent of the iconic beauty of 20th-century street lanterns, while meeting today's functional public lighting requirements.

City planners will appreciate all the benefits of LED technology: energy savings, long lifetime, low maintenance and digital connectivity options. And for a city's inhabitants, the range offers a striking addition to their cityscape, with luminaires that feel equally at home in established and new neighborhoods.

4 6

Introduction

Design

The best of both worlds



8

Applications

In the heart of the city



12  
Family range

14  
Complete sets



16  
Lighting performance

20  
Serviceability

In control  
 Connected lighting  
 Network controls  
 Stand alone controls

24

26  
Dimensional drawings



30  
Specifications  
 Main specifications



# Elegance and performance go hand in hand

Part of a city’s charm lies in the interplay between its older and newer areas. Along the city streets, you can feel echoes of the past and also the promise of the future – and this is exactly what ClassicStreet reflects.

The gently curved design, together with dedicated brackets and poles, creates a contemporary look that beautifies your city. At the same time, the advanced LED engine delivers outstanding levels of lighting and energy performance. The luminaires’ styling is not only suitable for historical and traditional architectural settings, but feels equally at home in more modern urban environments.

#### Attractive and versatile

From the drawing board to its final execution, we developed ClassicStreet to follow a well-thoughtout approach to urban illumination. It brings together elegant and subtle details, softened proportions and a contemporary mindset. All of which makes ClassicStreet the ideal luminaire for historical and traditional architectural settings, but feels equally at home in more modern urban environments.

#### Comfort and ambience

The urban landscape can be overwhelming, so it is important for people to feel safe and comfortable in your city. ClassicStreet offers an optional diffusing solution that combines comfort and performance. Special attention was paid in the technical design to avoid the typical chessboard and cross-effects shadows on the floor. This enhances the lighting uniformity, which contributes to a more pleasant city atmosphere and to citizens’ well-being.

#### Excellent value

ClassicStreet is the perfect solution for both renovation areas and new installations. The advanced LED engine delivers outstanding energy performance. And the range’s styling, high-quality finishing and optical performance make this range the right solution for all kinds of residential streets, parks, squares and city centers.

“  
They really beautify  
the street – even when  
they’re switched off!”



#### Excellent value for money

ClassicStreet is the perfect solution for both renovation areas and new installations.



#### Comfort and ambience

ClassicStreet offers an optional diffusing solution that combines comfort and performance.



#### Customize

ClassicStreet comes in one design and offers various brackets and poles to enhance the charm of your city in the best way.

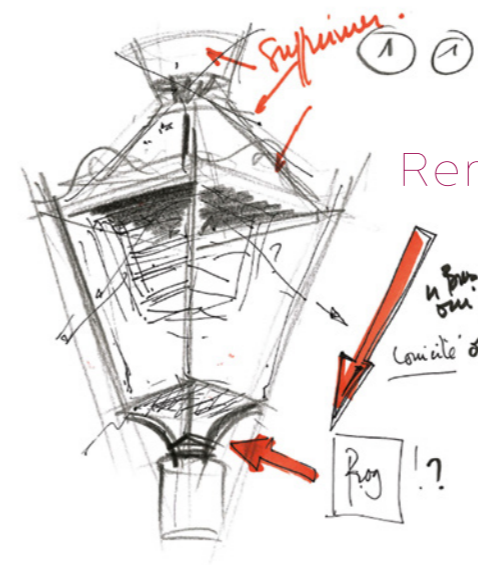

Subtle  
Reminiscent *Retro*  
Contemporary  
**SOFT** Modern  
Contemporary  
Iconic Elegant

# The best of both worlds

“  
**Classic design**  
meets future-proof  
technology.”



The idea behind ClassicStreet was to unite the best of both worlds. The classic elements in its design hark back to the familiar shapes of traditional street lanterns, while the execution is contemporary in every detail. The result is a luminaire that will stand the test of time.

The design of these complete sets is meant to reflect a classical yet still contemporary feeling. It echoes completely the iconic form of the 20th century street lanterns but the execution of its details and proportions are soft, radiused and contemporary.

**Flexibility first**

This approach to detailing makes the overall design more flexible in terms of integration into existing environments. At first glance, the luminaires have a silhouette that is square and flat, but a closer inspection reveals that the edges have been slightly curved and softened to give them a more 21st-century appeal.

# Applications

## In the heart of the city

ClassicStreet has a well-balanced design with retro styling and a modern look. Thanks to this timeless aesthetic, it is suitable for enhancing all types of city centers or urban areas – from historical or heritage districts to more contemporary, modern city zones.

Designed around its LED engine, ClassicStreet delivers outstanding levels of lighting and energy performance. Its different types of fixation or poles and brackets offer a high degree of flexibility, not only in terms of integration with the architectural context, but also in its range of applications.

ClassicStreet is part of our Urban Inspiration lighting portfolio. It incorporates all the necessary technical and functional features of city lighting, and also has a strong focus on the emotional and social value of light. In this way, it helps you create the right ambience in your city, enhance people's well-being and make the city more livable. For every application we have a number of solutions that will inspire you and enhance your urban landscape, while also fulfilling all of your specific feature requirements.

### City center

- Side street
- Square, park and playground
- Cycle path and footpath
- Shopping and pedestrian area
- Parking area

### Residential area

- Residential street
- Cycle path and footpath
- Square, park and playground
- Parking area



Public lighting  
.....  
ClassicStreet  
.....  
**Applications**  
.....



Public lighting  
.....  
ClassicStreet  
.....  
**Applications**  
.....



Public lighting  
.....  
ClassicStreet  
.....  
**Applications**  
.....



# Family range

The ClassicStreet range was designed for use in urban centers and city areas where heritage, ambience, comfortable lighting and attractive design play an important role.

With its softened curves and high-quality finishing, ClassicStreet is an easy and elegant fit in any urban environment. The gently curved design, together with the dedicated brackets and poles, creates a contemporary look that beautifies your city and creates distinctive and warm ambiances – at night and during the day.



Post-top pole  
Ø 60 mm

Post-top pole  
Ø 76 mm



Post-top ClassicStreet  
bracket with dedicated post-top  
ClassicStreet luminaire



Suspended ClassicStreet bracket  
with dedicated suspended  
ClassicStreet luminaire



Suspended mounting using  
a brass threaded spigot 1"G



Public lighting  
.....  
ClassicStreet  
.....  
**Family range**  
.....



# Complete sets

ClassicStreet comes with a choice of poles and brackets so that you can always find the perfect fit for both classical and more modern architectural contexts. These ready-to-use complete sets have a design that is reminiscent of the classical street atmosphere, combined with a contemporary and distinctive look. The brackets all have a dedicated interface that matches the range of luminaires, for optimum design integration and ease of installation.

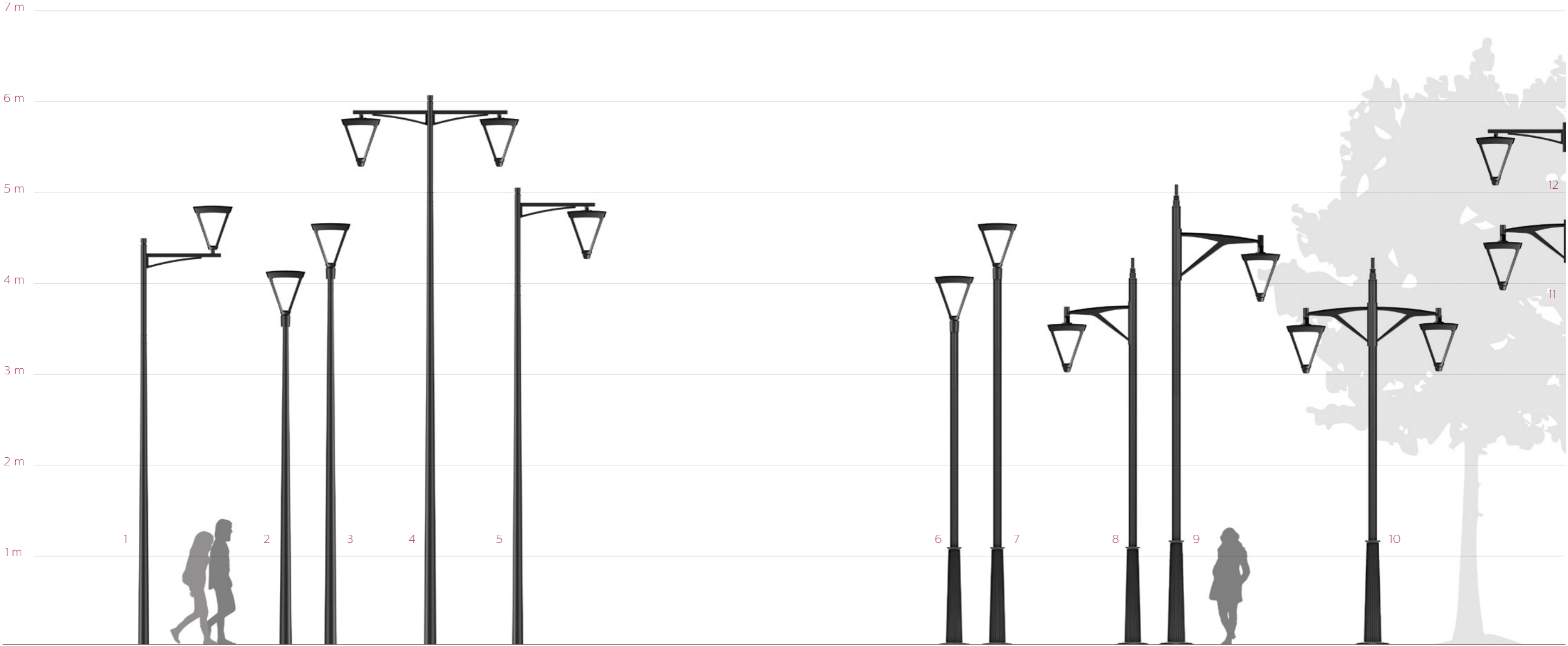

- 1 ClassicStreet + ClassicStreet single arm bracket post-top + Accante pole 3,5 m
- 2 ClassicStreet + Ø 60 Accante pole 3,5 m
- 3 ClassicStreet + Ø 60 Accante pole 4 m
- 4 ClassicStreet + ClassicStreet double arm bracket suspended + Accante pole 5 m
- 5 ClassicStreet + ClassicStreet single arm bracket suspended + Accante pole 4 m
- 6 ClassicStreet + Faro post-top pole 3,5 m

- 7 ClassicStreet + Faro post-top pole 4 m
- 8 ClassicStreet + Faro bracket + Faro applique pole 4,7 m
- 9 ClassicStreet + Faro bracket + Faro applique pole 5,5 m
- 10 ClassicStreet + Faro double brackets + Faro applique pole 4,7 m
- 11 ClassicStreet + Faro wall mounted bracket
- 12 ClassicStreet + ClassicStreet wall mounted bracket



# Lighting performance

## Best-in-class lighting and energy performance

Enabled by the optimized Ledgine platform offering application tailored optics, which helps maximize energy efficiency

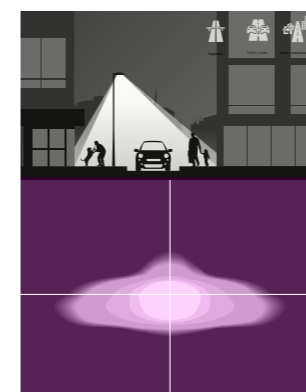

DN10 › Narrow distribution for luminance classes

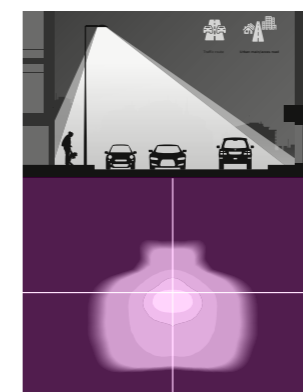

DM11 › Medium distribution for luminance classes

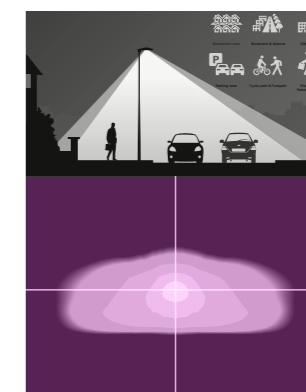

DM50 › Medium distribution for illuminance classes

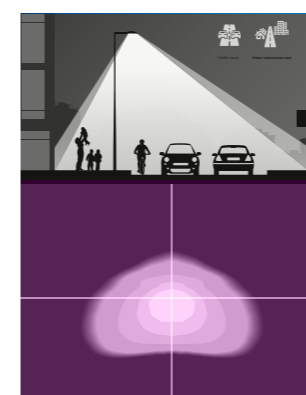

DW10 › Wide distribution for luminance classes

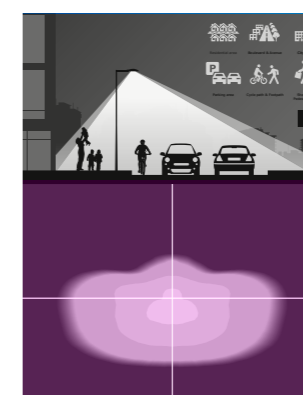

DW50 › Wide distribution for illuminance classes

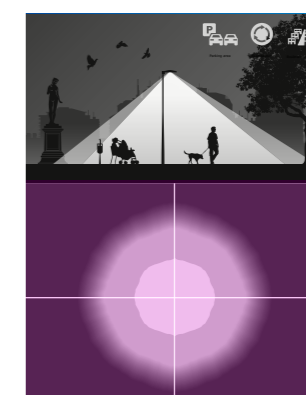

DX10 › Extra wide distribution for luminance classes

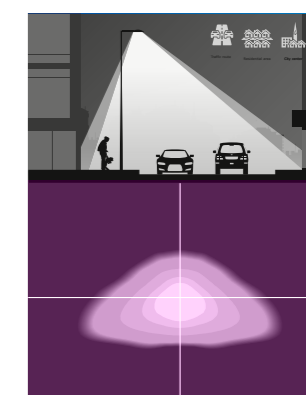

DS50 › Symmetrical distribution for central arrangement

# Designed for serviceability

Since LED luminaires require different competencies and processes for maintenance, fault finding and repair, ClassicStreet and its components are designed with serviceability in mind. Furthermore, to provide better support, 24/7 access to information and spare parts ordering, all ClassicStreet products and packages are all identified by the unique Philips Service tag application.

## Why Philips Service tag?



**Easy access to relevant information**  
 Improving installation process by providing easy access to product configuration information



**More effective maintenance**  
 Enabling more effective maintenance operations by identifying spare parts

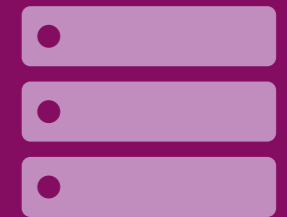

**Digital maintenance**  
 Enabling you to pre-program spare parts to factory settings



“  
 The greatest value of the Philips Service tag is that it enables us **to save precious time and avoid human errors.**”

### Instant access to procedures, spare part list and programming

This tag features a QR-based identification system that gives you instant access to critical information during unpacking, installation, diagnostics, fault reporting and programming. Simply scan the tag with a smartphone or tablet running the Philips Service tag app, and the contents of the box plus installation information are described. The tag also activates the five-year warranty. To assist in diagnosing breakdowns, scanning the tag provides the troubleshooting guide applicable to that luminaire. Sourcing spare parts and 'one touch' programming of parts to original settings can also be done using the app. It's that simple.

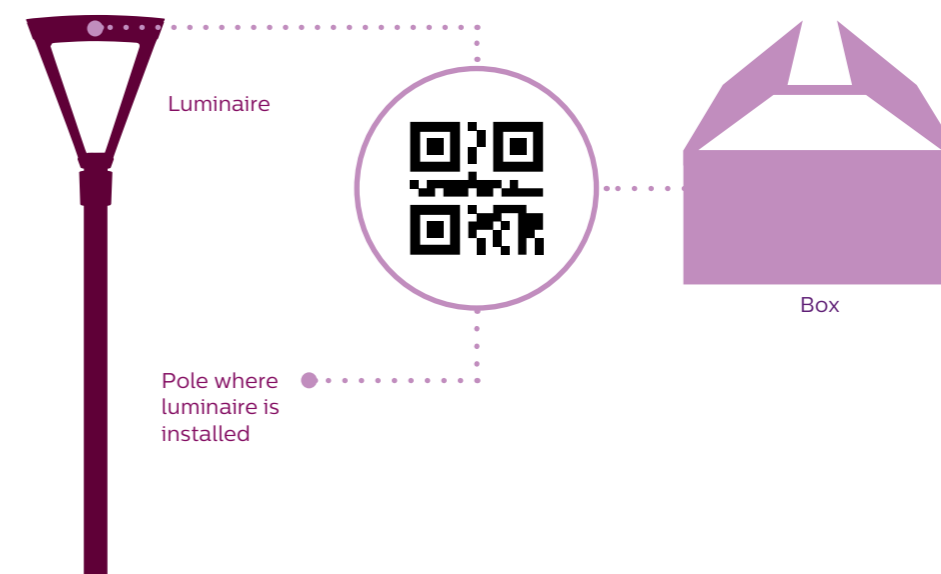

# Serviceability

ClassicStreet was designed to last a lifetime. To ensure easy maintenance it is very easy to access and service the most critical components, like the driver. ClassicStreet allows you to quickly reach in and replace the driver on site within a couple of minutes, using only a screwdriver. Simply follow the six easy steps below.



- Step 1:** Unscrew four screws to open the cover
- Step 2:** Remove the cover, which is installed with a safety cord
- Step 3:** Return the cover onto the frame of the luminaire and unscrew the four screws of the mask
- Step 4:** The driver is now easily accessible



- Step 5:** Loosen two screws and unscrew a third screw to remove the driver. Detach the wires with click connectors.
- Step 6:** Return the cover onto the frame of the luminaire and close it by screwing the four screws of the cover



# ClassicStreet in control

Lighting city streets, roads and public spaces presents many challenges, partly because the dynamics of city life are changing constantly due to fluctuations in traffic density.

This means you need the right level of lighting to respond to these changes in order to make the city feel safe, attractive and inviting. But at the same time you are under pressure to reduce energy costs and maximize your green credentials. Philips offers a complete range of intelligent lighting controls to help you overcome all these problems and make your city more livable and sustainable.

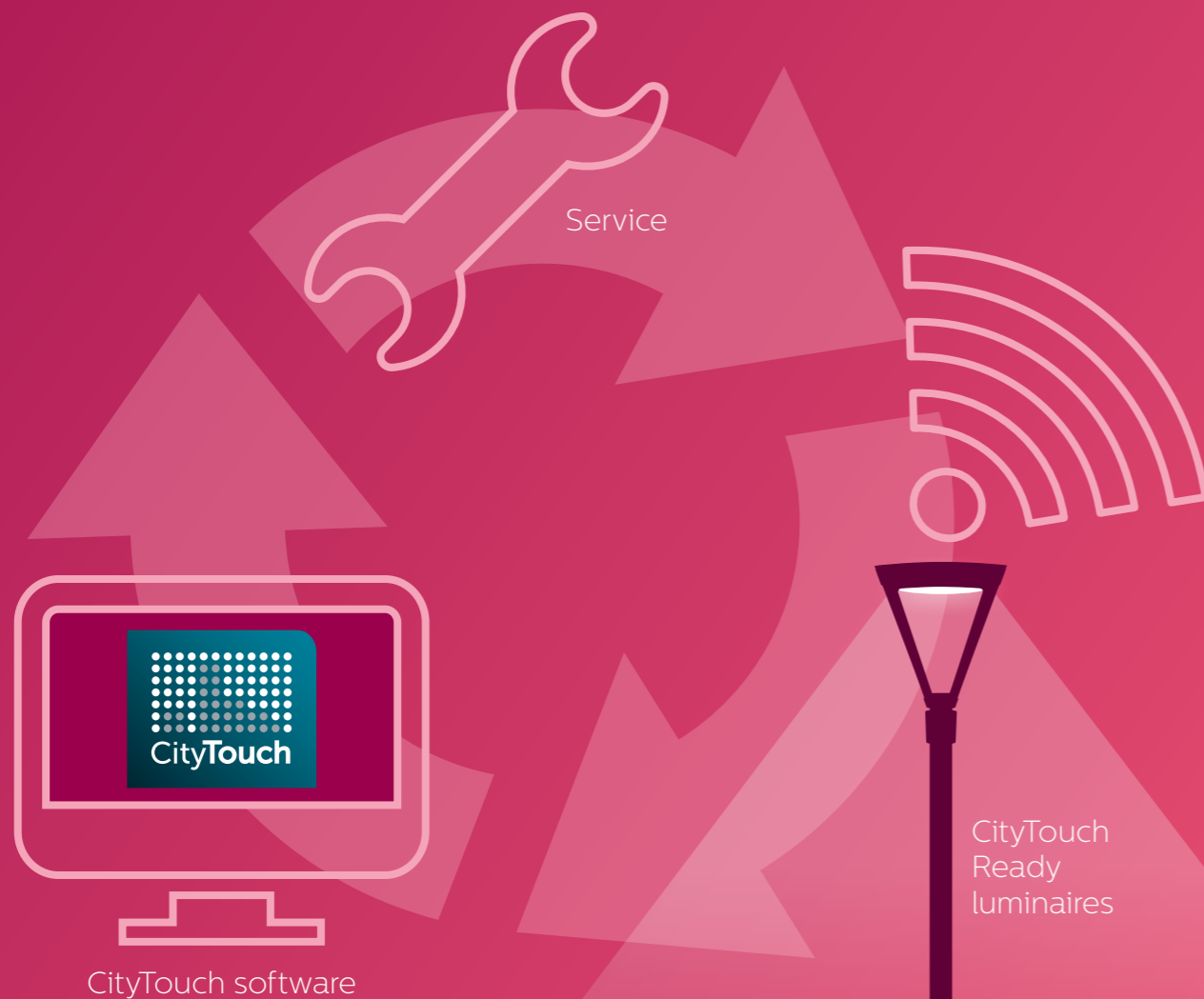

## Connected lighting

### CityTouch Ready luminaires

ClassicStreet can be seamlessly connected to CityTouch software via CityTouch connect app (remote management), with all the intelligence being integrated into the luminaire without the need for any additional hardware. Communication runs directly via the public mobile network. An additional advantage is that you are not required to perform any maintenance. Furthermore, the entire connectivity management is covered by the service we provide, ensuring there is no hassle for you, the customer. Once connected to the power

supply, a light point automatically appears on the CityTouch map at the right location - with all the relevant technical parameters imported into the system.

CityTouch connect app is an intelligent, interactive remote management solution for street lighting. It brings your city lighting to life and offers you flexibility, information and accuracy. The system's flexibility enables you to respond easily to expected and unexpected situations by dimming or brightening any of the areas within your city to ensure

safety and well-being. Information keeps you up to date on the current status of every single luminaire, facilitating more effective maintenance and faster repairs. And accurate energy metering gives you a precise overview of actual energy consumption.



### CityTouch connect app key features



#### Control of each individual light point

You have the flexibility to adjust every single luminaire to changing situations or requirements at any time. You can adjust calendars to suit your individual needs simply by changing the switching points of each dimming profile via drag and drop.



#### Fault detection and notification

Faster and better provision of information about the current status of the lighting infrastructure enables you to address maintenance issues more quickly and to improve the maintenance service level.



#### Accurate energy metering

Accurate energy metering for each individual luminaire enables you to monitor your energy bills and to identify potential new savings.

# Dimensional drawings

## BDP794

Post-top with Spigot  
 Ø 60 or 76 mm

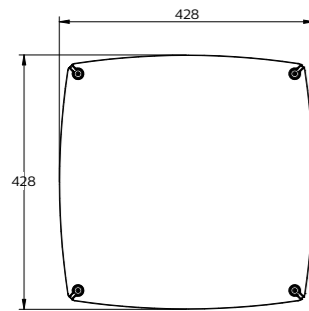
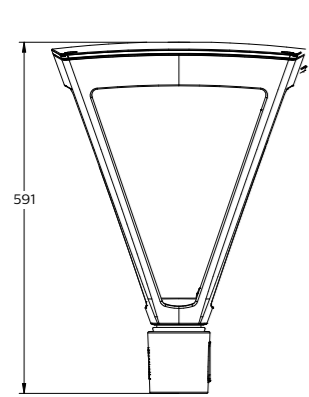

## BSP794

Suspended  
 1'G

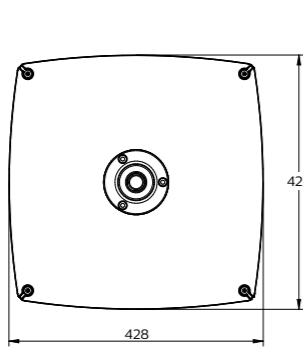
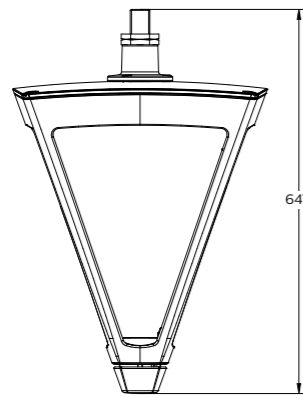

## BVP794

Suspended ClassicStreet  
 luminaire for suspended  
 ClassicStreet bracket

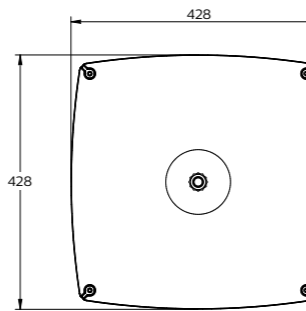
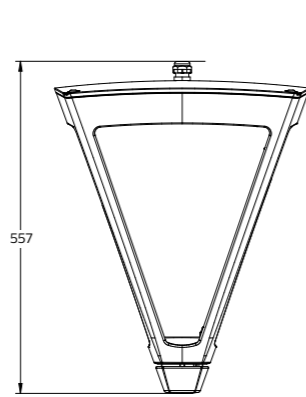

## BPP794

Post-top ClassicStreet  
 luminaire for post-top  
 ClassicStreet bracket

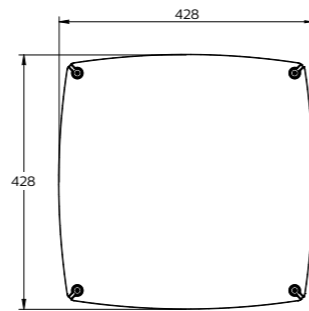
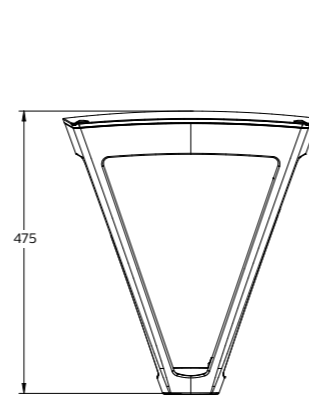

## BDP794 Ø 60 or 76 mm Spigot

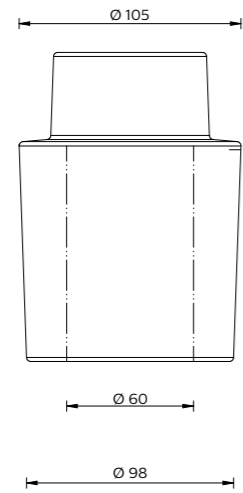
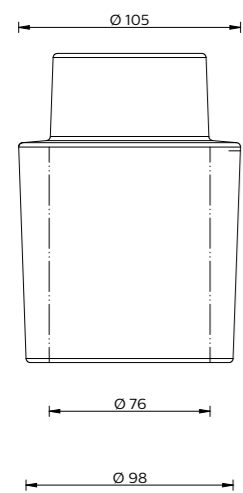

## Brackets for Ø 60 poles

### JGB795 MBP-T 750 60

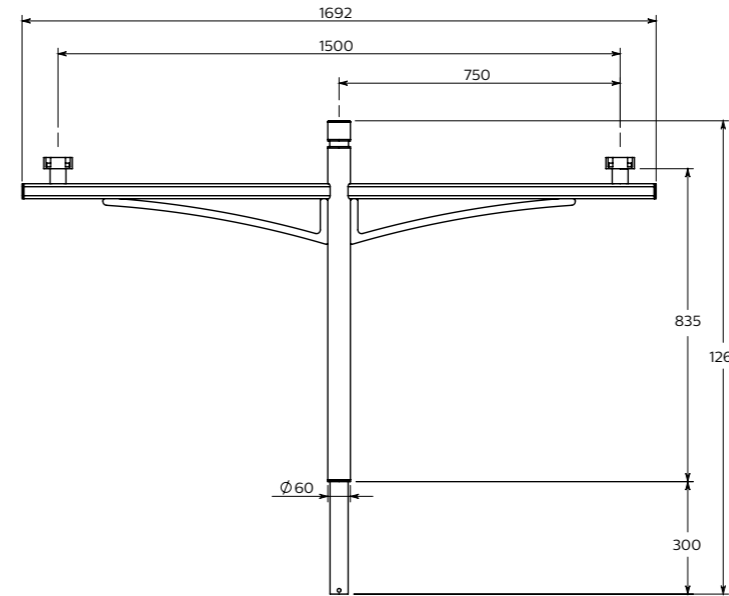

### JGB795 MBP-S 750 60

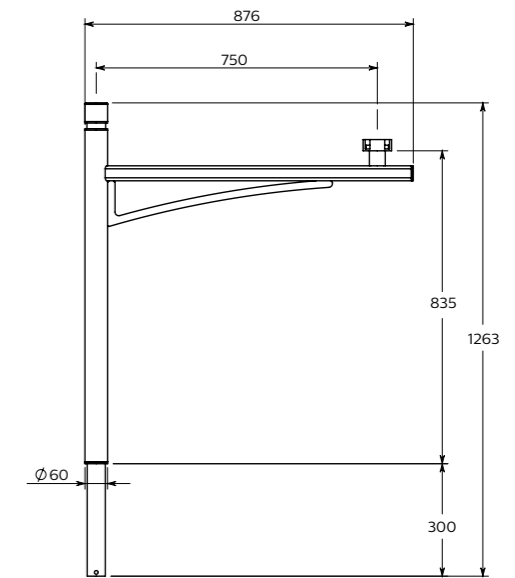

### JGB794 MBP-T 750 60

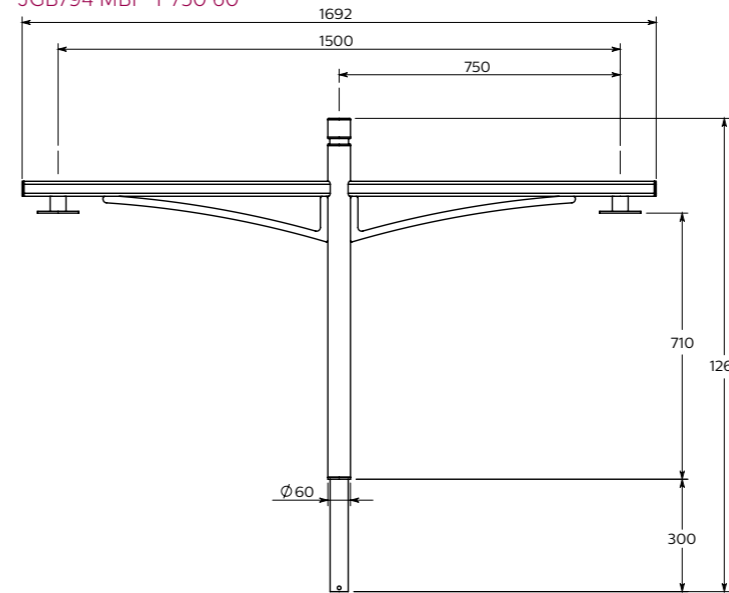

### JGB794 MBP-S 750 60

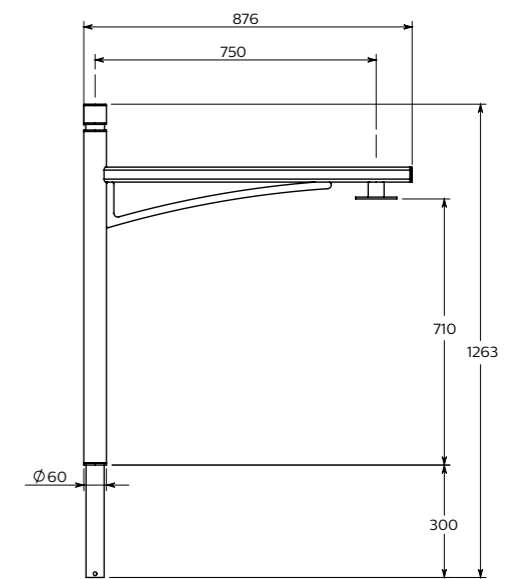

### JGB795 MBW 750

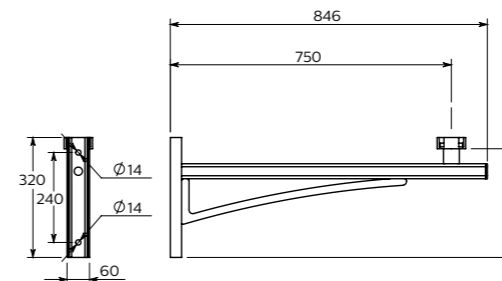

### JGB794 MBW 750

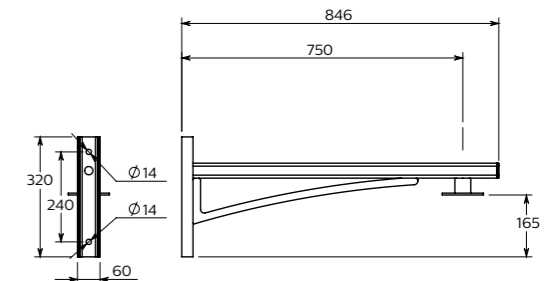

# Dimensional drawings

## Brackets for Ø 76 poles

JGB795 MBP-S 750 76

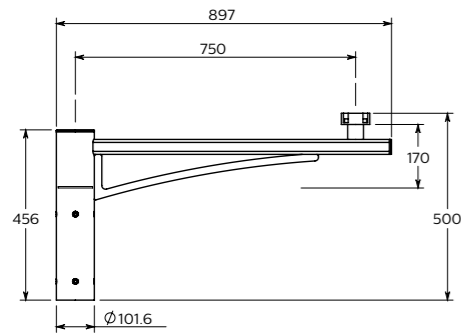

JGB795 MBP-T 750 76

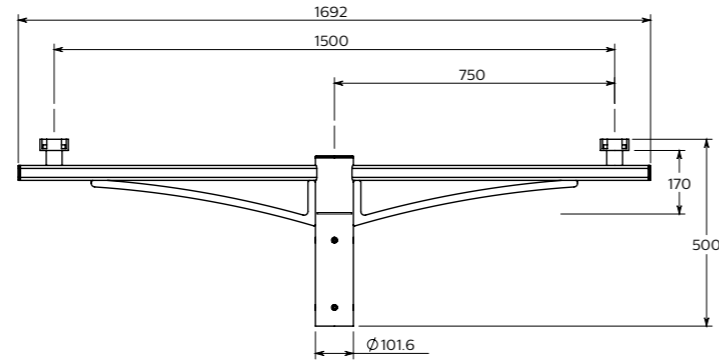

JGB794 MBP-S 750 76

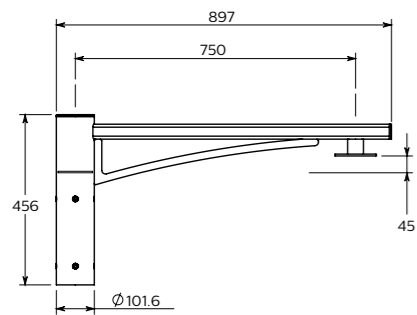

JGB794 MBP-T 750 76

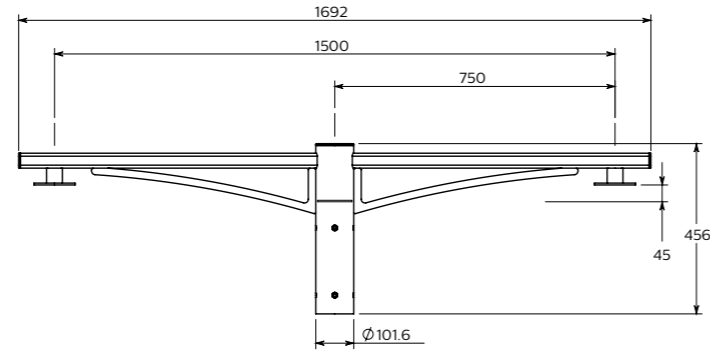

## Faro applique pole

YHM700

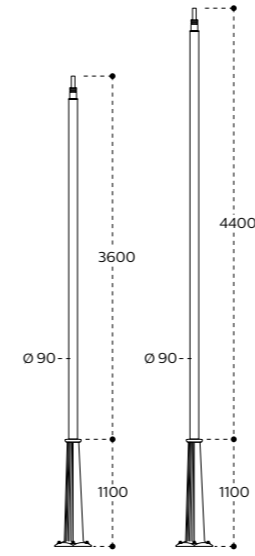

Faro 1 4700  
 Faro 1 5500

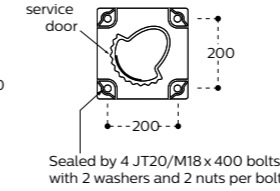

## Faro post-top pole

YHM702

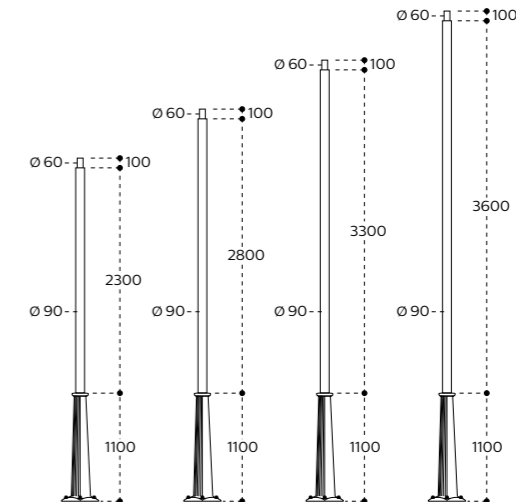

Faro 1 3500  
 Faro 1 4000  
 Faro 1 4500  
 Faro 1 4800

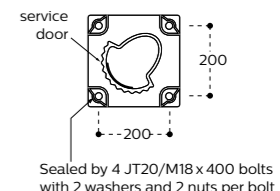

## Faro brackets

40 bracket - JGP700 MBP 400

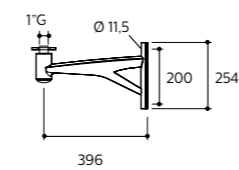

70 bracket - JGP700 MBP 700

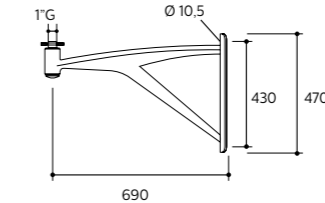

90 bracket - JGP700 MBP 900

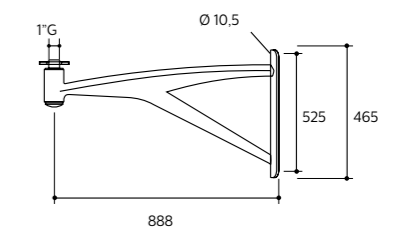

## Main specifications

Product features	ClassicStreet
<b>Type</b>	BDP794 (post-top version) BSP794 (suspended version) BPP794 (post-top version for dedicated bracket) BVP794 (suspended version for dedicated bracket)
<b>Correlated Color Temperature</b>	3,000 K (warm white) - 4,000 K (neutral white)
<b>Color Rendering Index</b>	80 (warm white) - 70 (neutral white)
<b>Luminous flux source</b>	1,600 - 10,500 (warm white), 1,550 - 11,000 (neutral white) depending on configuration
<b>Power</b>	13.8W - 83W (warm white), 12 W - 70 W (neutral white) depending on configuration
<b>Luminaire efficacy</b>	Up to 115 lm/W
<b>Useful life</b>	100,000 hours at L90B10 minimum
<b>Optic</b>	Distribution Medium (DM, DN), Pedestrian Crossing, Symmetrical, Wide & extra Wide, Louver
<b>Optical cover</b>	Tempered flat glass clear (FG), diffusing flat glass (GF) (optional)
<b>Warranty</b>	Silver 5 years
<b>Installation</b>	Post-top: 60 and 76 mm, Suspended 1'G
<b>CLO</b>	Available
<b>Control systems Input</b>	DALI CityTouch Ready
<b>Intelligence Control</b>	LumiStep (LS), DynaDimmer (DDF), LineSwitch (DI1), Starsense RF Wireless and CityTouch Ready, Photocell, MiniCell 35, 55, 75 lux,
<b>Driver</b>	Philips Xitanium Driver
<b>Operating temperature range</b>	-20 °C < Ta < 50 °C
<b>Mains voltage</b>	220-240 V / 50-60 Hz
<b>Electrical class</b>	Class I and Class II
<b>Color</b>	Black N9 (MN332L) or Philips ultra-dark grey Other RAL and AKZO Futura colors available on request
<b>IP rating</b>	IP66
<b>IK rating</b>	IK09 clear flat glass, IK08 diffused flat glass
<b>Weight</b>	12.3 kg
<b>Scx</b>	0.15 m <sup>2</sup>
<b>Surge protection</b>	6 kV (standard) - 10 kV (optional)
<b>Certification</b>	CE - ENEC

## LED configurations

ClassicStreet 10  
LED board:

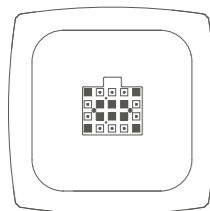

ClassicStreet 14  
LED board:

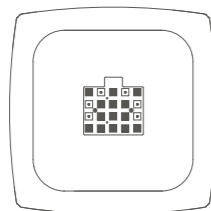

ClassicStreet 20  
LED board:

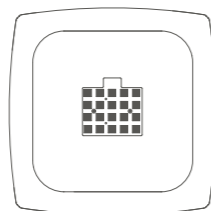

ClassicStreet 30  
LED board:

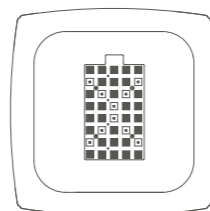

ClassicStreet 40  
LED board:

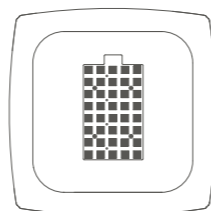

## General specs complete sets and dimensions

Brackets specifications	ClassicStreet bracket	Faro bracket
<b>Material</b>	Steel	Aluminium
<b>Mounting to luminaire</b>	Dedicated interface post-top or suspended	1" (34 PdG) post-top or suspended
<b>Mounting to support</b>	Single or double arm bracket tenon for pole top Ø 60 mm or cap for pole top Ø 76 mm	
<b>Mounting to support</b>	Pole mounting bracket with 2 points and fixing center 240 mm	Pole mounting bracket with 2 points and fixing center depending on bracket length (255 mm / 430 mm / 565 mm)
<b>Tilt angle</b>	0°	0°
<b>Color</b>	Black N9 (MN332L) or Philips ultra-dark grey Other RAL and AKZO Futura colors available on request Other RAL or AKZO colors available on request	Black N9 (MN332L) or Philips ultra-dark grey Other RAL and AKZO Futura colors available on request Other RAL or AKZO colors available on request
<b>Certification</b>	CE certification in accordance with standard EN40	CE certification in accordance with standard EN40

## Pole specifications

Pole specifications	Faro post-top pole	Faro applique pole
<b>Material</b>	Aluminum	Aluminum
<b>Pole height</b>	3.5 m, 4 m, 4.5 m and 4.8 m	4.7 m and 5.5 m
<b>Installation type</b>	Flange plate	Flange plate
<b>Color</b>	Black N9 (MN332L) or Philips ultra-dark grey Other RAL and AKZO Futura colors available on request	Black N9 (MN332L) or Philips ultra-dark grey Other RAL and AKZO Futura colors available on request
<b>Certification</b>	CE certification in accordance with standard EN40	CE certification in accordance with standard EN40

Luminaire version	Product Family Code	Lumen Package	Source flux (lm)	Power	
				NW	WW
ClassicStreet	BDP794/BSP794/BPP794/BVP794	LED15-4S	1,550	12	
	BDP794/BSP794/BPP794/BVP794	LED21-4S	2,100	15,2	
	BDP794/BSP794/BPP794/BVP794	LED26-4S	2,700	18	
	BDP794/BSP794/BPP794/BVP794	LED31-4S	3,200	22	
	BDP794/BSP794/BPP794/BVP794	LED42-4S	4,300	28,5	
	BDP794/BSP794/BPP794/BVP794	LED53-4S	5,400	36,5	
	BDP794/BSP794/BPP794/BVP794	LED65-4S	6,600	44	
	BDP794/BSP794/BPP794/BVP794	LED74-4S	7,400	48,5	
	BDP794/BSP794/BPP794/BVP794	LED86-4S	8,600	55	
	BDP794/BSP794/BPP794/BVP794	LED95-4S	9,600	61	
	BDP794/BSP794/BPP794/BVP794	LED107-4S	11,000	70	
	BDP794/BSP794/BPP794/BVP794	LED15-4S	1,600		13,8
	BDP794/BSP794/BPP794/BVP794	LED21-4S	2,100		18,0
	BDP794/BSP794/BPP794/BVP794	LED26-4S	2,600		21,5
	BDP794/BSP794/BPP794/BVP794	LED32-4S	3,200		26,5
	BDP794/BSP794/BPP794/BVP794	LED41-4S	4,200		33,5
	BDP794/BSP794/BPP794/BVP794	LED52-4S	5,200		42,5
	BDP794/BSP794/BPP794/BVP794	LED64-4S	6,400		49,5
	BDP794/BSP794/BPP794/BVP794	LED74-4S	7,400		57,0
	BDP794/BSP794/BPP794/BVP794	LED85-4S	8,600		65,0
BDP794/BSP794/BPP794/BVP794	LED96-4S	9,600		74,0	
BDP794/BSP794/BPP794/BVP794	LED106-4S	10,500		83,0	



