

PHILIPS

Horticulture LED Solutions

GreenPower TLED



Quick installation guide 快速安装指南

EU - CHI

Please take the time to read this quick installation guide. The guide contains important information and notes regarding the installation and operation.

请仔细阅读本快速安装指南，本指南包含安装和操作重要信息和说明。

IMPORTANT!

- Please read the installation instructions very carefully and follow the wiring instructions to ensure safety
- Product is not dimmable
- Always switch off the power supply before commencing work
- Only apply in dry indoor environments.
- Do not change the structure or any components of the product to ensure safety
- Philips GreenPower TLED is designed to fit in standard IEC compliant G13 bi-pin lampholders
- Philips GreenPower TLED must be installed by a professional electrician in accordance with the relevant electrical codes
- Please keep this Quick Installation Guide for future system maintenance.

Packing list / 包装单

Philips GreenPower TLED : 10 pcs / 10支
Philips GreenPower Batten : 10 pcs / 10支
Quick Installation Guide : 10 pcs / 10份

重要!

- 为确保安全请仔细阅读并遵从安装指南
- 本产品不可调光
- 在进行任何更换安装之前，始终保证电源处于关闭状态
- 本产品仅适合室内干燥环境使用
- 为确保安全，请不要对灯管结构或元件进行任何更改
- 飞利浦 GreenPower TLED 为标准IEC符合的G13双脚灯座设计
- 必须由专业电工根据相关电气规程安装飞利浦 GreenPower TLED
- 请保留《快速安装指南》，便于将来系统维护参考

DISCLAIMER / 免责声明

Philips Lighting does not accept liability for any damages for installations not performed according to this guide or not performed by a professional electrician.

对因不遵守本安装指南或由非专业电工操作引起的任何直接或者间接的损坏或意外，飞利浦将不承担任何责任。

Products and tools / 产品和工具

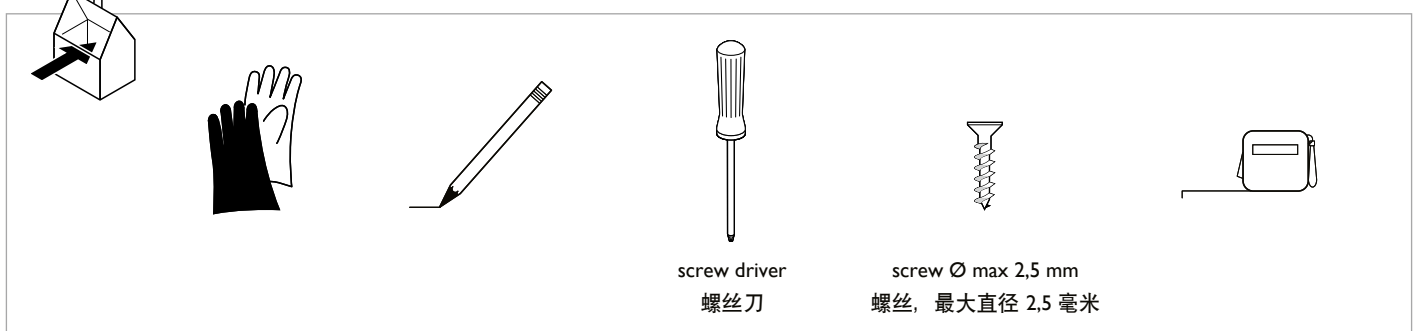
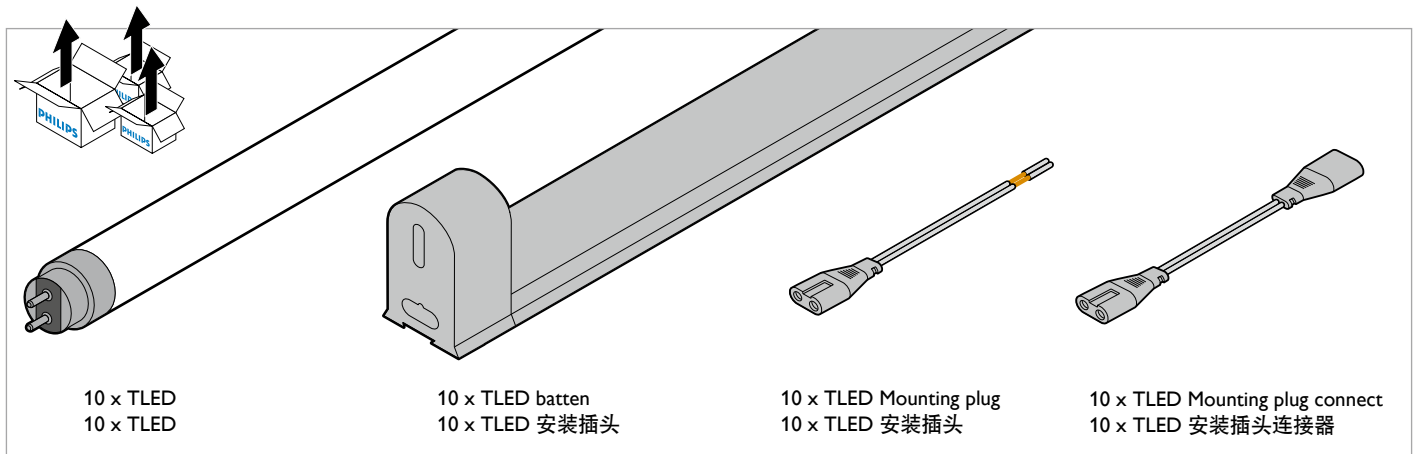

Start / 开始

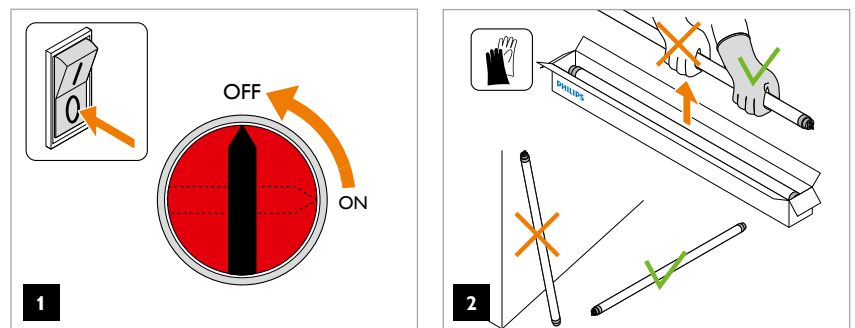

3 Options TLED Mounting / 个 TLED 安装方案

1. Standard GreenPower TLED batten / 标准 GreenPower TLED 灯具
2. Re-wiring existing T8 batten / 为现有的 T8 灯具重新布线
3. G13 fitting mounting + wiring / G13 配件安装 + 布线

! Important!

Incorrect installation or wiring may cause product failure, or other issues! Please choose right installation steps!

错误的安装或布线可能导致产品出现故障或其他问题! 请选择正确的安装步骤!

Option 1 / 方案 1

Installing GreenPower TLED with new batten / 使用新灯具安装 GreenPower TLED

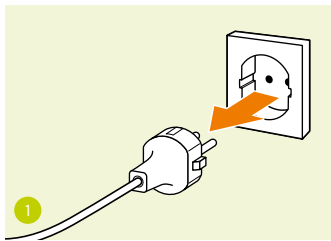

1
Turn Mains Off
关闭电源

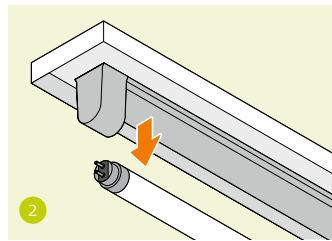

2
Remove all existing FLUORESCENT
TUBES from luminaire
拆除灯具上的全部现有荧光灯管

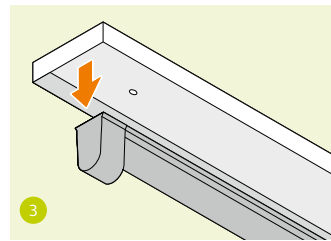

3
Remove all existing battens
拆除全部现有灯具

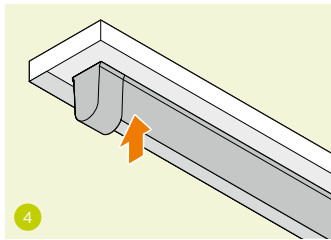

4
Install battens from the Philips GreenPower
TLED
安装飞利浦 GreenPower TLED 灯具

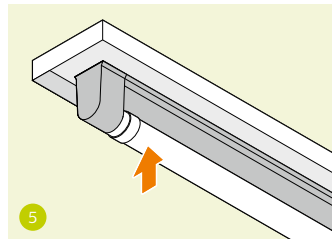

5
Install Philips GreenPower TLED
安装飞利浦 GreenPower TLED

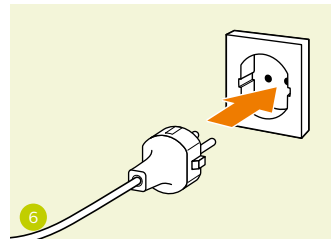

6
Turn Mains On
打开电源

Option 2 / 方案 2

Installing GreenPower TLED with re-wiring existing T8 batten / 通过对现有 T8 灯具进行重新布线的方式安装 GreenPower TLED

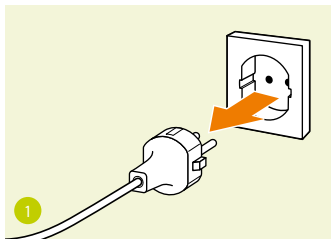

1
Turn Mains Off
关闭电源

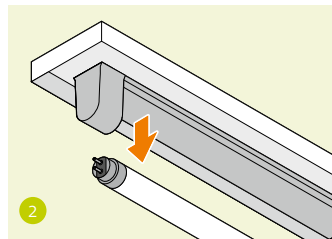

2
Remove all existing FLUORESCENT
TUBES from luminaire
拆除灯具上的全部现有荧光灯管

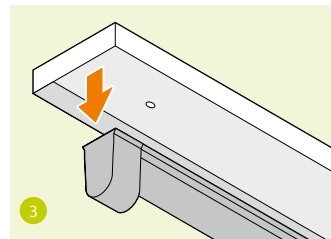

3
Open the 4ft batten. Disconnect gear inside (no need for gear for TLED)
打开 4 英尺灯具 断开内部的镇流器 (TLED 不需要镇流器)

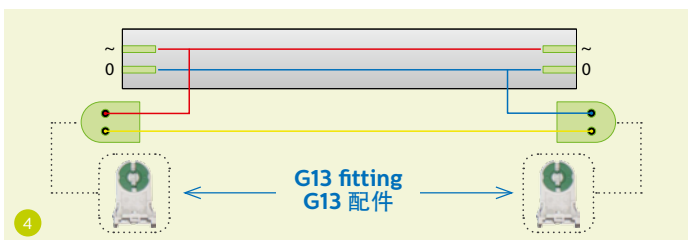

4
Re-wire the batten according to scheme / 按图对灯具进行重新布线

1. Double insulated 0,75 mm² copper conductors in case of metal batten housing / 如为金属灯具外壳, 则使用双层绝缘的 0,75 平方毫米铜线
2. Double or single insulated 0,75 mm² copper conductors in case of plastic batten housing / 如为塑料灯具外壳, 则使用双层或单层绝缘的 0,75 平方毫米铜线

Diagram shown on the left is for one tube only. Repeat same rewiring for multiple tubes.

左图是为只有一根灯管布线。如有多根灯管, 重复相同的重新布线步骤。

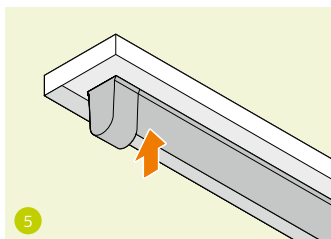

5
Close the batten
关闭灯具

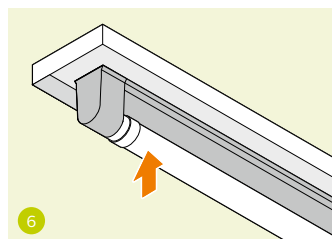

6
Install Philips GreenPower TLED
Reconnect main voltage power cable
安装飞利浦 GreenPower TLED
重新连接主电压电源电缆

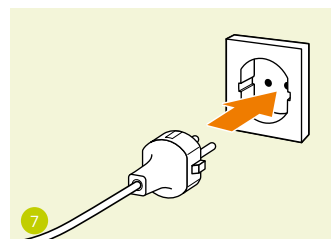

7
Turn Mains On
打开电源

Option 3 / 方案 3

Installing GreenPower TLED with separate G13 fittings / 使用单独的 G13 配件安装 GreenPower TLED

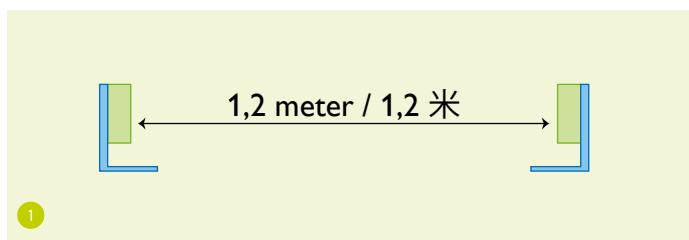

1
Mount 2 pcs G13 fittings at 1,2 m distance in line form each other
在 1,2 米处安装 2 个 G13 配件，相互对齐

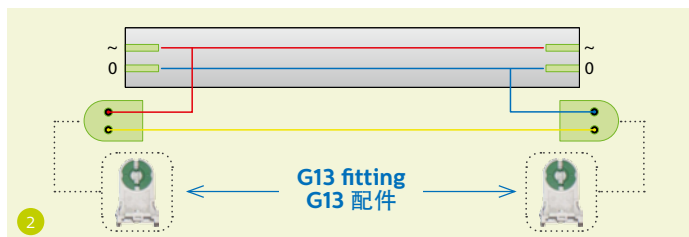
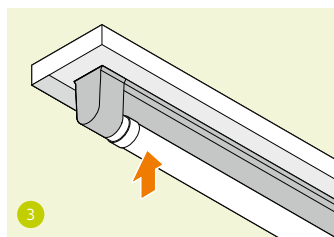

Diagram shown on the left is for one tube only. Repeat same rewiring for multiple tubes.

左图是为只有一根灯管布线。如有多根灯管，重复相同的重新布线步骤。

2
Wire in between the 2 pcs G13 fittings a 0,75 mm² conductors according to scheme
Always make sure if double insulated wire conductors
按图在 2 个 G13 配件之间接上 0,75 平方毫米的导线
始终确定使用的是否为双层绝缘导线



3
Put the T-LED tube in the G13 fittings
Connect main voltage power (220-240 V)
将 T-LED 灯管放入 G13 配件
连接主电压电源 (220-240 伏)

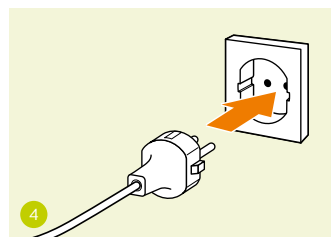

4
Turn Mains On
打开电源



© 2015 Royal Philips N.V. All rights reserved. Philips reserves the right to make changes in specifications and/or to discontinue any product at any time without notice or obligation and will not be liable for any consequences resulting from the use of this publication.

Document order number: 3222 635 67229
06/2015
Data subject to change.

For more information about Philips horticulture LED Solutions visit: www.philips.com/horti

Write us an e-mail: horti.info@philips.com

Or tweet us: @PhilipsHorti