



PHILIPS
dynalite 

Networked Controls

Creating **intelligent hotels**

Advanced control systems
for promoting guest comfort,
brand differentiation and
operational efficiency

Create a home away from home

with Dynalite intelligent
hotel solutions

Today, hotel guests expect a superior home away from home experience while staying in all levels of accommodation. Increasingly, guests want to take control of all aspects of their stay. By reducing both capital and operating expenditure, hotel operators want to deliver on the experience to build loyalty and enjoy premium returns.



Guests at the Scarlet Hotel in Cornwall UK, can match their mood from a choice of seven lighting schemes, carefully created to enhance the ambience of the guest rooms.

Bring the benefits of the Dynalite system to your hotel



Save energy

- Run your hotel more efficiently by ensuring back-of-house areas can be controlled via occupancy sensors, so light is on only when areas are occupied
- Adding controls to guestrooms offers management of occupied and unoccupied rooms for lighting, HVAC and curtains / blinds



Reduce costs

- Extend the operating life of light fittings, reducing maintenance and energy costs
- Lower energy costs further by adding Philips LED lighting solutions to your hotel



Adjust ambience

- Create an atmosphere of luxury, comfort and style in guestrooms to influence mood and create the best possible customer experience
- Create ambience in public areas with scene control for restaurants, ballrooms, lobbies, corridors etc.
- Change a space with the press of a single button, or automate changes through timed features



Enhance your brand

- Make your brand sparkle with gorgeous lighting scenes in public spaces and on your hotel façade
- Create an internationally branded look and feel for guestrooms



Streamline operations

- One system controls guestrooms, lobbies, function rooms and reception
- Deliver operational and programming flexibility to your sites
- Create transformative environments through a 24 hour period to allow for a different look and feel depending on the time of day
- Give hotel staff and management control of every aspect of the hotel environments including guestrooms and public areas, to help reduce labor costs, improve service, optimize facility usage and save energy
- Have the scalability and flexibility to allow for upgrades and renovations
- Each area can have a standalone system or be networked together for maximum flexibility and control



Personalize spaces

- Enhance guest and employee comfort, productivity and safety
- Guests can control multiple functions in their room with one easy-to-use interface, giving them the ability to create an environment perfectly suited to their requirements



Integrate with other systems

- Simplify workflows with end-to-end system integration
- High level integration to allow remote room control and status reporting
- Easy integration to building management and security systems



Track performance

- Get real-time data on lighting and energy management system status and performance, using EnvisionManager



Conference and business facilities

The Dyalite system introduces an extra dimension to meetings and conferences with flexible solutions and energy-efficient lighting that provides the appropriate illumination at a reduced cost.

Ballrooms – versatile and theatrical

The Dyalite system supports “room join”, which automatically links multiple rooms and allows them to be controlled from one central point.

In any ballroom, it is very important to set the right mood for the occasion. The lighting control system can coordinate multiple lighting groups to work together ensuring seamless changes between scenes and theatrical effects.

Façades

Dyalite in conjunction with Color Kinetics can create dynamic and memorable lighting effects that complement a hotel's facade and make a positive and lasting impression on guests.

Lobbies – for dramatic first impressions

Lighting plays a pivotal role in creating a striking and welcoming hotel lobby.

The system can automatically run a work schedule for the area to control the lighting throughout the day to ensure the lobby is always welcoming.

By adding an additional light level sensor, the control system automatically reduces energy consumption by dimming lighting levels when there is sufficient daylight to maintain a pleasant environment.

Outdoor areas

The Dyalite system delivers decorative and original lighting effects to enhance outdoor areas such as gardens and courtyards.

Health and wellness areas

Gyms, saunas, swimming pools, hairdressers and beauty salons are standard features in hotels today. The Dyalite control system delivers innovative lighting scenarios to create the desired ambience and help make guests feel as relaxed as possible.

Car parks

The car park is often one of the first places where guests experience a hotel so it's important that it feels welcoming and safe. The Philips Dyalite system optimizes lighting and controls energy costs, while still enhancing guest comfort and safety.

The intelligent control system at work



Restaurants – creating exceptional ambience

For any restaurant that wants to deliver a truly unique dining experience, the lighting atmosphere is critical.

The system supports a range of load controllers to drive the various lamp types and can also automatically adjust blinds and awnings. The system can run automatically from timed events and light level sensors.

Touchscreens allow for multiple points of control from one location to set up the perfect scene.

Behind the scenes – the benefits of energy management

A Dynalite system can effectively save energy in back-of-house areas including kitchens and staffing areas by automatically turning off lighting in areas not in use.

A clever combination of a timeclock and motion sensors can effectively reduce running costs while still providing the right level of lighting for staff to carry out their duties.

The centralized monitoring and control system offers additional benefits in security, through remote override capabilities.

Redefining the guest with our range of

We offer a stylish range of user interfaces designed to match all interior design requirements and budgets. Each Antumbra and Revolution user interface can be engraved or labeled with words or icons to explain the function of each button, and this can be rolled out across a hotel network. Refer to the Philips Dynalite User Interfaces brochure for more information on the ranges available.



Left: The AntumbraButton (North American model).



Above: The Revolution series user interface (European model).



Right: The AntumbraDisplay (North American model).



experience stylish user interfaces

Rather than having multiple buttons for the same area to recall different lighting scenes – for example in the master bedroom, 'Morning', 'Afternoon', 'Evening' & 'Night' – a single button on a Dynalite user interface can be programmed so that the right scene is recalled for that specific time of day. This allows for a simplified user experience with fewer buttons required.

Supporting an IP22 rating allows for the keypad to be installed within the bathroom which allows the guest to make changes to the system without leaving the room.

From the bedside keypad, guests can select lighting scenes, set their room status and can select 'Master On/Off'. The built-in proximity sensor can be used to trigger the room 'Master On' function, so the guest room lights up.

Every element of the room from the lighting, blinds, HVAC and AV can be integrated into the one control system, allowing for the guest to quickly and simply set the room to their liking.

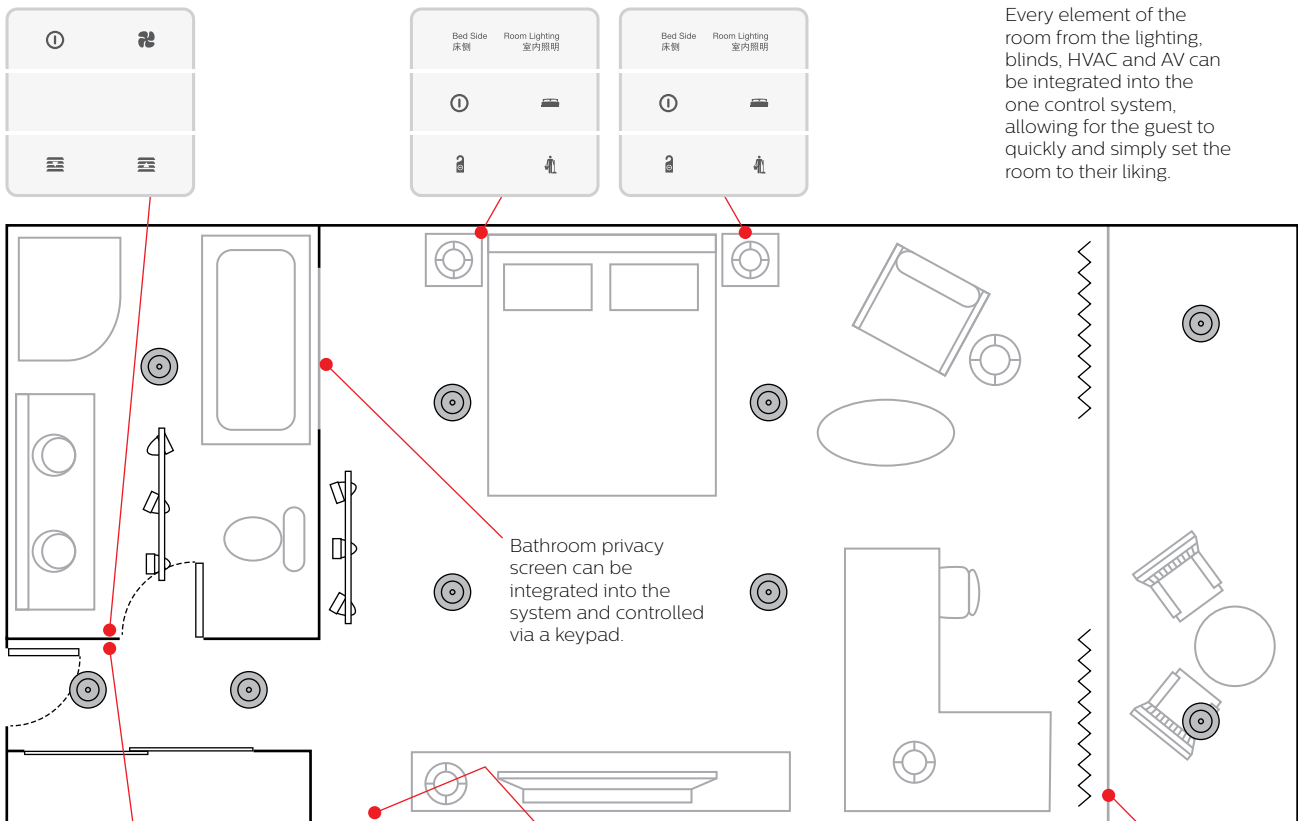

Bathroom privacy screen can be integrated into the system and controlled via a keypad.



Local control keypads can be used to perform multiple functions from the press of a single button. When leaving the room, guests can press the 'make up room' option which after a short delay, will shut down all lighting in the room and close the blinds.

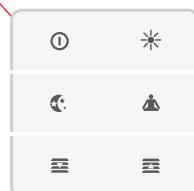

All room control keypads are available in the same style and finish giving a consistent look throughout the room. Scene setting allows the guest to select a mood for their room, with the press of a single button. This will adjust the level of multiple light groups to pre-selected levels.

Blinds can be integrated into the system.

Make guests welcome in every room

Dynalite controllers have evolved to be the industry leaders in hotel environments offering unsurpassed reliability and flexibility. They are designed and built to support the very latest features including:

- Smooth flicker-free LED dimming
- True voltage regulation for extended lamp life, reducing ongoing maintenance costs
- Compact design
- Easy to install and maintain
- Out-of-the-box functionality
- Embedded system-wide network solution

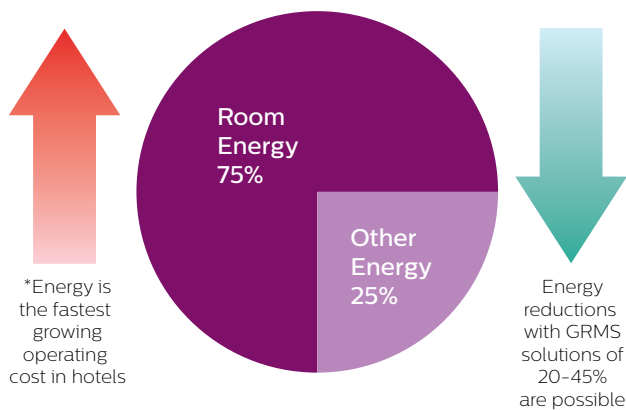

*(US) EPA has found that a 10% reduction in energy consumption would be equivalent to increasing RevPAR by more than \$2.00 for full-service hotels. Improving hotel energy performance reduces operating costs, benefitting your bottom line and leaving more money to invest in further improvements that can lead to enhanced guest satisfaction.

*Source: (US) EPA Hospitality: Looking for Energy Solutions

We offer two different guestroom control products:

DDRC-GRMS – Provides competitive and cost effective automation and control for hotel rooms. It enables switching of multiple lighting groups, HVAC, power outlets and blinds from third-party or Dynalite user interfaces.



DDMC-GRMSPLUS – Offers a complete room automation and integration solution, supporting dimming of multiple LED lighting groups, multiple blind control, automated switching and control of color-changing lighting via DMX. It has a built-in port for integrating to the hotel BMS, reporting the room status and current guest requirements to hotel services.



The GRMS solution is economical, flexible and simple to install and use, so individual hotels can customize a solution to suit their guests' needs. Through the integration capabilities of the GRMS, operators can tie guestrooms into existing property management systems, building management systems, access control solutions, or other third-party devices requiring control.

The system also allows hotel staff and management to save energy, identify room status and receive guest requests, resulting in improved guest satisfaction and brand loyalty.

GRMS capabilities

Bedside control

The bedside keypad allow the guest to set the desired lighting scene for the entire suite and control the bedside lighting, the 'Do not disturb' and the 'Goodnight' functions and the window dressings such as curtains and blinds.

Air conditioning control

Integrating the air conditioning system to the GRMS allows the hotel to reduce unnecessary energy consumption. Guests can view and set the temperature level in the room and fan speed from the same keypad they use to control the lighting.

Room entry

Once inside, the guest enters the room card key into the card holder or presses a 'Welcome' scene button on the keypad. This then triggers multiple functions automatically such as 'Open blinds', 'Adjust thermostat to previous set level' and 'Turn on lighting'.
When the guest leaves the room taking the card key with them or pressing the 'Goodbye' scene button, the room will automatically perform a shut down energy-saving sequence after a delay.



Window dressing control

Guests can control curtains/blinds from the same keypad that provides the lighting scenes and air conditioning control. This control can also be programmed to open the curtains when the 'wake up' scene is selected.

Check-out integration

The room can also be set in vacant mode when the guest checks out. Vacant mode can turn off the air conditioning to save energy and close the window dressings to insulate the room.

Integration with the BMS system

Networking the rooms to the hotel BMS allows staff to override room control.

The hotel's energy usage levels may be monitored allowing the system to adjust settings to meet energy usage targets.

A fully networked hotel system can also be automated to turn on all room and public area lighting in case of a fire. In addition, exits on each floor could be set to brighter levels.



Outside the room

A user interface outside the guest room can be used to indicate to hotel staff the room status, for example, 'make up room', 'do not disturb' or 'laundry pick-up required'.

Detecting guest requirements

Motion detection within the bathroom prevents guests searching for keypads in the dark. The operation of the sensor can allow different functionalities between night and day. For example, if occupancy is detected in the bathroom for the first time during the night, the lighting will slowly ramp up to a low level, allowing guests to adjust.

Total control at your fingertips

EnvisionManager is a lighting management and monitoring application that integrates seamlessly with the Dynalite system, improving performance and efficiency while reducing operating costs.



EnvisionManager provides global control and monitoring of the hotel lighting system. You can run both automated and manual commands to easily change the operation of the system, and produce up-to-date performance reports at the touch of a button. The lighting system can then be optimized to respond to the needs of occupants while eliminating energy waste.

EnvisionManager key features:

- Live energy performance monitoring display
- Full control of the lighting system from one screen
- Macro builder that allows you to tailor the system to the guests and hotels needs
- Real-time monitoring of hardware performance
- Control of scheduling, reports, DALI emergency testing, occupancy and specific events, such as Earth Hour
- Performance monitoring for all lamps and drivers, with an alert function to notify of any component faults

Integrated control throughout your hotel

The control system can be integrated to the hotel's management system allowing staff to see the real-time status of a room from occupancy to guest needs and requests. This allows staff to execute their tasks more efficiently.

Within the room, a guest can indicate to staff if the room needs to be made up, indicate that there is dry-cleaning to be picked up, trigger an alarm for emergencies or opt for 'Do Not Disturb'.

Staff can monitor and control HVAC based on occupancy to reduce energy costs, and attend to guest requests instantly for improved service.

This clever system can automatically switch off all lighting, change the climate control system to a more economic level and close the blinds as soon as the guest checks out. In practical terms, this means housekeeping doesn't disturb guests and HVAC and lighting never waste energy in unoccupied rooms.

Building Integration

Networking the rooms to the hotel Building Management System (BMS) allows staff to view the room status and override room control.

The hotel's energy usage can be constantly monitored allowing the system to adjust the current settings to meet energy usage targets.

A fully networked hotel system can also be configured to turn on all room and public area lighting in case of a fire. In addition, exits on each floor could all be instantly lit to brighter levels.

Ningbo Park Hyatt

Ningbo, China

An energy-efficient system that is easy to use

The Park Hyatt Resort and Spa in Ningbo, has been designed as a spa retreat with a world-class suite of treatment rooms.

Much of the opulent atmosphere experienced by guests has been achieved through the use of a Dyalite control system.

The Dyalite control system manages lighting, heating and curtain/blind controls across all three floors of the 100,000 square-meter area, throughout the public areas of the hotel and in each of the 236 guest rooms.

Daylight harvesting strategies have been used throughout the public areas of the hotel as well as in the guest rooms to balance the available light and reduce energy usage.

The design of the Dyalite system for the lighting and automation within the hotel has achieved comfort, ease-of-control, flexibility and energy efficiency, resulting in savings as high as 60 per cent.



Park Hyatt Sydney, Australia

A warmer, cosier lighting ambience

When Park Hyatt Sydney decided to extensively renovate its landmark hotel on Sydney's waterfront, it wanted a lighting solution that would complement this breathtaking location, as well as its new architecture and interior design.

The solution includes seamless integration to third-party systems within the hotel – such as the fire control system, motorized blinds and the AMX AV equipment. The system enables intuitive control of hotel lighting scenes through wall keypads or through hand-held devices. Back-of-house and common guest areas are also controlled with the Dynalite system, including the main foyer, ballroom, restaurant, the pool area, lift lobbies and gym.

The hotel's lighting emulates natural light levels, such that at times of the day when there is less light outside, the hotel's lighting system is set to deliver a warmer, cosier lighting ambience.



Rockliffe Hall

County Durham, UK



Where lighting versatility complements grandeur

Rockliffe Hall has been carefully restored and extended to create a luxury hotel, spa and golf course while retaining the grandeur of its 1700s heritage. A Dyalite system has provided a flexible and adaptable energy-saving solution for superior lighting control, creating an ambience suited to the grandeur of the setting.

A Dyalite DALI system enabled the team to make each individual luminaire addressable, so there are no circuit limitations. It was also vital that the lighting management system could control a range of different light sources, including LEDs, fluorescent, tungsten halogen and metal halide.

In guest rooms, simple, custom engraved keypads enable guests to choose their preferred lighting scene. Guests are also able to turn off all the lighting in their room with a single switch, which delivers significant energy savings.

The intelligent design of the Dyalite system has made it possible to deliver functional and flexible lighting in keeping with the hotel's heritage and luxury design as well as significant energy savings for the hotel.





The Star Sydney, Australia

Shines with advanced lighting control

The Star is one of Sydney's major entertainment precincts having undergone a redevelopment and refurbishment of its casino, hotel, retail and food outlets - including a lighting upgrade across both hotels and the casino, as well as facades and external public areas.

The Dyalite system provides hotel guests with a personalized experience, enhancing their comfort and improving operational efficiency. When a guest enters a room they can choose a lighting scene from a wall keypad – either a morning or an afternoon scene by simply pressing a button. There are also motion detector sensors in each room and if no movement is detected for a certain period of time, the system turns the lights off which saves energy. Guests can also control the blinds, temperature and entertainment.

The Dyalite management system communicates with the separate control system in each room for the internal services, including door locks, air conditioning and audio-visual control. It can also send a control signal to set a welcome scene for guests, which includes setting a particular lighting level and the display of a personalized greeting on the TV in the room.

Dyalite's integrated control system offers reliability, flexibility and efficiency to ensure that The Star will make its mark as a world-class entertainment and retail destination.



The Scarlett Hotel

Cornwall, UK

Where glamour and green meet

The Scarlet is a luxury eco-hotel that demonstrates that luxury and environmental sustainability can go hand-in-hand.

The Dyalite solution was to install an innovative lighting system that would meet stringent environmental, functional and architectural criteria, providing pre-set lighting scenes in public areas and mood lighting in bedrooms, all controlled by a combination of wall keypads, remote controls and motion sensors.

Each guest room has two engraved and backlit control keypads that allow guests to match their mood from a choice of seven lighting scenes – ‘ambient’, ‘bright’, ‘relax’, ‘bath’, ‘night’, ‘balcony’, and ‘all off’.

Energy-saving fluorescent and LED luminaires are integral elements of the lighting design. The lighting system challenges the expectation that hotel lights need to be on all of the time by making extensive use of multipurpose sensors to ensure lights are turned off when not required.

The lighting system delivers both the environmental and architectural outcome the hotel was seeking, complementing the unique and opulent hotel and achieving cutting edge sustainability.





www.philips.com/dynalite

© 2015 Koninklijke Philips N.V. All rights reserved.

All rights reserved. Reproduction in whole or in part is prohibited without the prior written consent of the copyright owner. The information presented in this document does not form part of any quotation or contract, is believed to be accurate and reliable and may be changed without notice. No liability will be accepted by the publisher for any consequence of its use. Publication thereof does not convey nor imply any license under patent – or other industrial or intellectual property rights. Document order number: HOT0110 Data subject to change.

HOT0110-0715-AZZAUS