



PHILIPS

Entertainment
lighting

EMEA lighting and controls catalogue 2017



Connected solutions
putting you in control

innovation ✨ you

Controls, distribution & power

Our controls encompass everything from sophisticated networks, that share and distribute data providing integrated solutions, through to sophisticated mixing of colors, positioning and focusing of luminaires in simple and efficient ways to simple basic everyday controllers.

Reliable and easy-to-use, these control systems provide solutions that will meet the creative needs of facilities of any size.

Intuitive operation, simplified set-up.

Denison High School, Smith Auditorium

Lighting designer: Mark Batts, Batts BVL

Photography: Bryan Matthews



Networking Solutions

Philips Strand Lighting introduced the use of ethernet systems for the distribution of lighting data with the ShowNet suite of networking protocols in 1994.

Thanks to this pioneering work, the use of networking for the transmission of lighting levels between control consoles and dimmers is now standard practice within the entertainment lighting industry. Strand's widespread experience of networking has led it to be the natural choice for keynote events such as the ground-breaking Sydney Olympics opening ceremony.

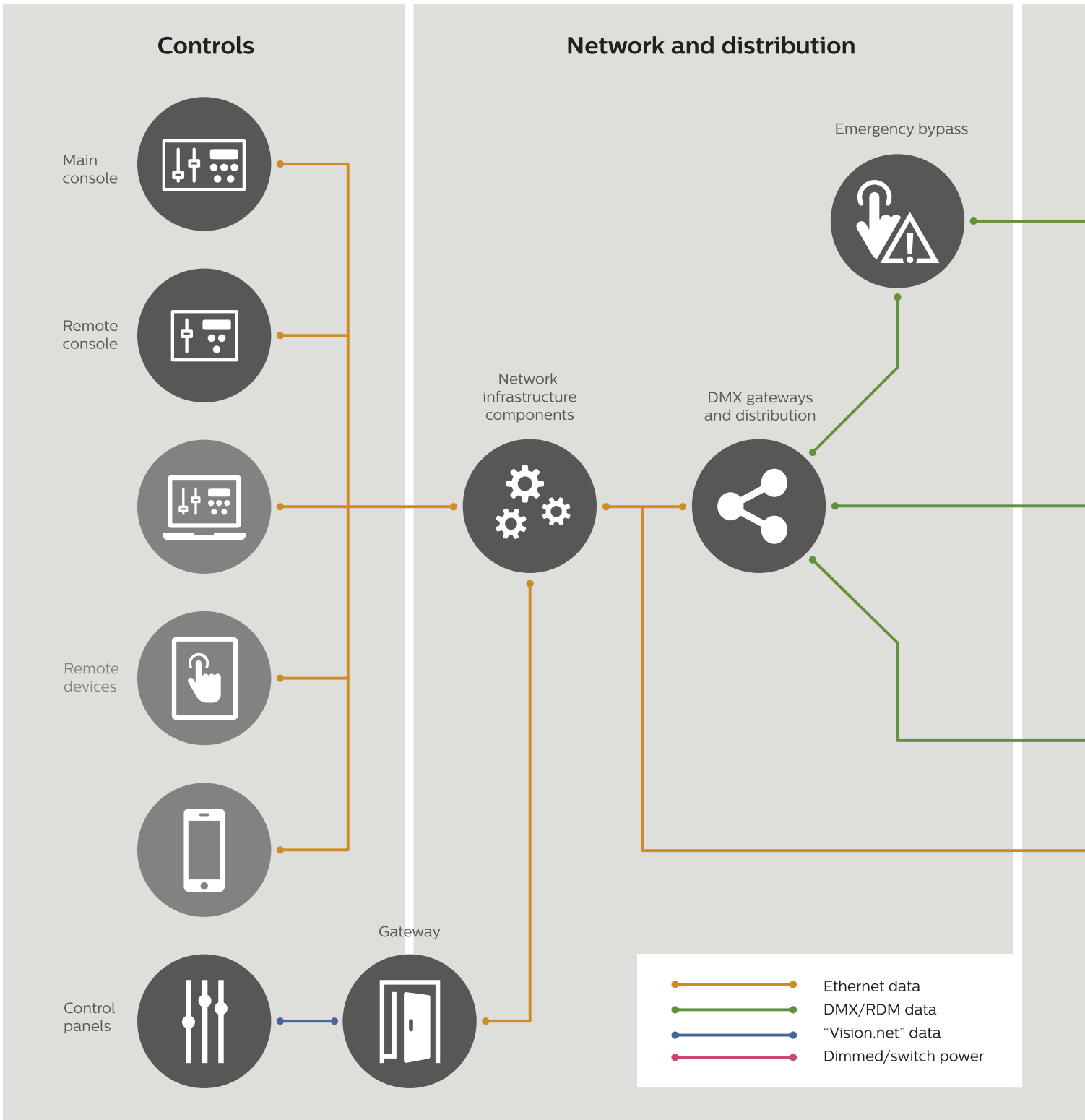

Today, the use of networking within the Philips Entertainment product range has expanded significantly with systems supporting a variety of protocols, including ShowNet, E1.31 Streaming ACN, DMX, Pathport and Art-Net™.

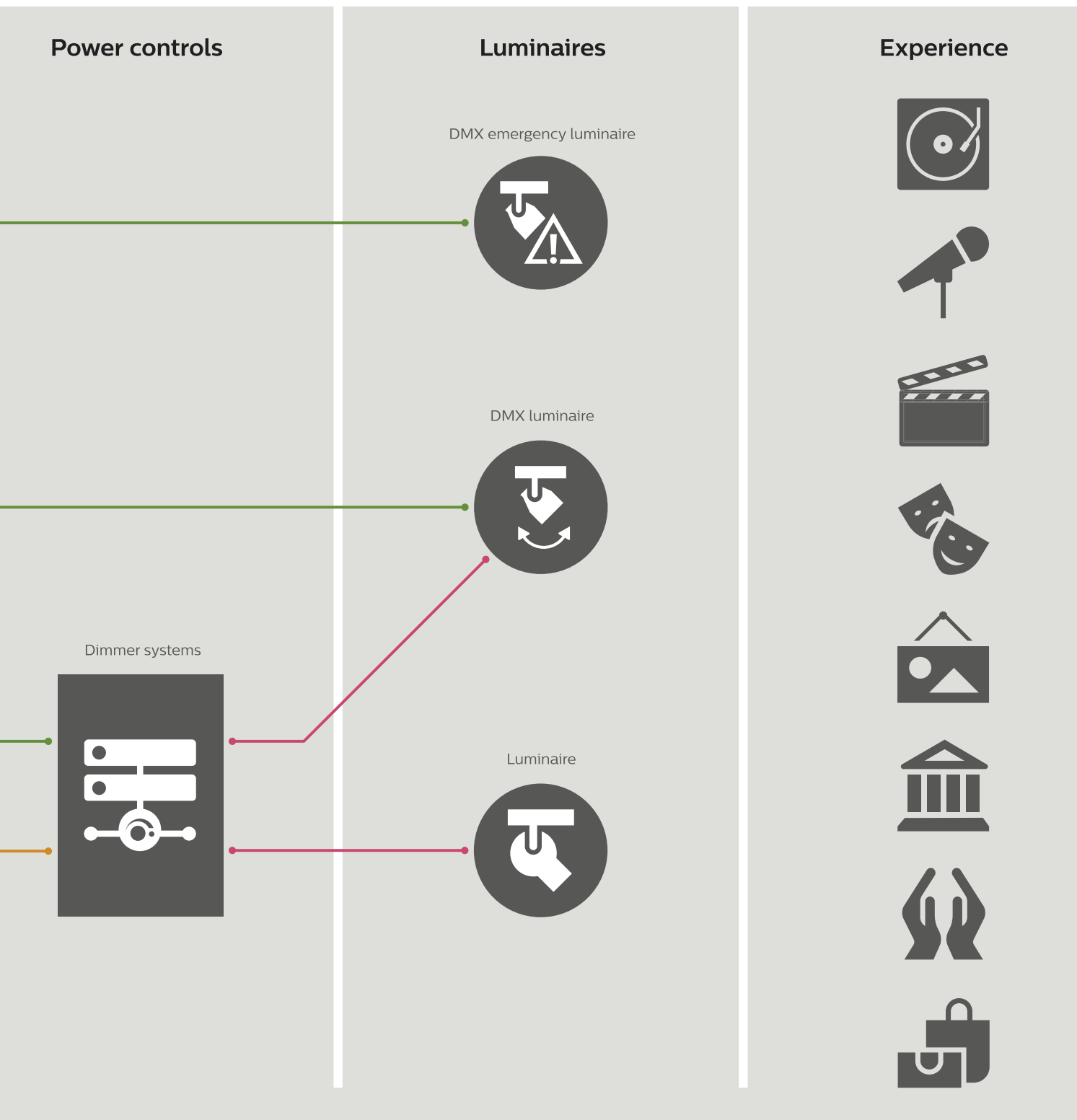

These solutions help minimise capital costs and increase inter-operability and are further enhanced with support for protocols that control Philips Color Kinetics data enablers, allowing Philips Entertainment Lighting consoles to communicate with what is probably the widest variety of devices and dimmers in the market.



Controls

NEO system

	NEO Control Console	NEO Submaster Wing
		
Submaster faders	10	20
Playback faders	5	–
Theater playback	1	–
Time fader	1	–
Cue list	Unlimited	–
DMX ports	4	–
RDM	Supported	–
Midi	In / out	–
SMPTE	In / out	–
Ethernet	2x gigabit	–
USB ports	9	2x USB 2.0 output (type A); 1x USB 2.0 input (type B)
Internal monitor	–	–
External monitor	3	–
Ethernet protocols	Art-Net™ / ShowNet / sACN / CK Net Vision.net / Telnet	–
File shares	Windows networking	–
Operating system	Windows 7	–
Form factor	Single tier desktop design	–
External triggers	Midi / DMX in / SMPTE / Line input MySQL / Vision.net / Volt-free contacts	–
Internal display screens	4x color screens	5x color screens
PDA support	iOS / Android	–
Encoders	4x indented encoders	–
Level wheel	Indented level wheel	–
Media playback formats	MPEG-1 layer I and layer II AAC and Dolby digital audio MPEG-1 and MPEG-2 video	–
Protocols / connectivity	ShowNet / E1.31 (Streaming ACN) / Art-Net™ DMX512 / KiNet / Pathway / RDM	–
Connections / ports	4x DMX out via 5-pin DMX 1x DMX in via 5-pin DMX 1x MIDI in / out 1x SMPTE In / out 1x VESA display port 1x HDMI port 1x DVI port 2x Network ports – RJ45 1x Audio line in / out / mic in – via 1/8" mini 2x COM ports 2x USB 3.0 (on rear panel) 7x USB 2.0 (2x rear panel, 4x console front, 1x Keyboard drawer) 2x 3-pin XLR ports (12V) for console lights (2x console lights are included with each console purchased)	1x Accessory power input 1x Accessory power output 1x USB 2.0 input connector (Type B) 2x USB 2.0 output connector (Type A) 1x 3-pin XLR port (12 Volt) for console light (console light sold separately)
Supply voltage	100–240VAC	12VDC, 14A (from console connection)
Operating temperature / humidity	0–40° ambient / 0–95% non-condensing	0–40° ambient / 0–95% non-condensing
Storage temperature	0–35°	0–35°
Finish	Black	Black
Construction	High density and impact resistant aluminium and plastics	High density and impact resistant aluminium and plastics
Dimensions H x W x L	788 x 143 x 496mm	394 x 138 x 388mm
Weight	16.8kg	5.6kg
Warranty	2 years	2 years

NEO Playback Wing	NEO Playback Controller
	
10	Virtual
5	Virtual
–	Virtual
–	Unlimited
–	4
–	Supported
–	In / out
–	In / out
–	2x gigabit
2x USB 2.0 output (type A); 1x USB 2.0 input (type B)	6
–	3
–	Art-Net™ / ShowNet / sACN / CK Net Vision.net / Telnet
–	Windows networking
–	Windows 7
–	19in rack mounting design
–	Midi / DMX in / SMPTE / Line input MySQL / Vision.net / Volt-free contacts
5x color screens	
–	
–	iOS Android
–	
–	MPEG-1 layer I and layer II AAC and Dolby digital audio MPEG-1 and MPEG-2 video
–	
–	
–	
–	
1x Accessory power input	4x DMX out via 5-pin DMX
1x Accessory power output	1x DMX in via 5-pin DMX
1x USB 2.0 input connector (Type B)	1x MIDI in / out
2x USB 2.0 output connector (Type A)	1x SMPTE In / out
1x 3-pin XLR port (12 Volt) for console light (console light sold separately)	1x VESA display port
	1x HDMI port
	1x DVI port
	2x Network ports – RJ45
	1x Audio line in / out / mic in – via 1/8" mini
	2x COM ports
	2x USB 3.0 (on rear panel)
	4x USB 2.0 (2x rear panel, 2x front panel)
	Kensington Security Lock Slot
12VDC, 14A (from console connection)	120–240VAC, 3.0A 50/60Hz
0–40° ambient / 0–95% non-condensing	0–40° ambient / 0–95% non-condensing
0–35°	0–35°
Black	Black
High density and impact resistant aluminium and plastics	High density and impact resistant aluminium and plastics
394 x 138 x 388mm	483 x 89 x 366mm
5.6kg	4.56kg
2 years	2 years

Controls: NEO Control Console

The Philips Strand NEO Software provides an expandable control system, catering for the needs and requirements of our most demanding customers. The scalability of the system, allows the user to grow and take advantage of the LED revolution with an intuitive and flexible software base.

The NEO Software also takes pride of place, providing a fully integrated part of a Vision.net system, allowing seamless control of both production and architectural lighting



Features – NEO Control Console

- Up to 100 universes of DMX.
- Touchscreen capable interface.
- Unlimited cues, cue lists, groups, palettes, effects and macros.
- Tracking, cue only and hybrid tracking programming.
- Flexible shortcut system.
- Generic palettes.
- Time line effects.
- Pixel mapping.
- Media playback.
- Multi-User control user security system (login).
- Tracking backup.
- Timed events with sunrise / sunset.
- Telnet interface.
- Android / iOS remotes.
- Undo history.
- Visual timecode editor.
- Power monitor.
- Color and position paths per cue.
- Blind pre-visualization.
- Magic sheet layout.
- Two year limited warranty.

Suggested uses:



For more information visit philips.com/strandlighting

Controls: NEO Fader Wings

Adding to our NEO family of products are the NEO fader wings. NEO fader wings can be used to provide additional physical fader playback and submasters, depending on model, to your NEO lighting control console.

The interconnection between each wing and the control console is via a USB connection and can be powered either directly from your NEO console or plugged directly into a common power outlet through an optional power supply.

We think you will find the NEO lighting control console and wings a worthy successor to a proud history of iconic consoles that have had the honor of bearing the Strand Lighting and now Philips Strand Lighting name.

Features - NEO Console Playback Wing

- 10 motorized submasters with backlit bump buttons.
- 5 motorized multi-function faders with go / stop / back backlit buttons.
- 5 color LCD screens with status displays and fader identification.
- Backlit page up and down buttons for independent paging of submasters and playbacks.
- USB 2.0 port A / B ports or daisy chaining multiple units.
- 2x Wing power in / thru ports.
- Innovative group masters feature.
- Kensington lock slot at back of unit.
- Two year limited warranty.



Features - NEO Console Submaster Wing

- 20 non-motorized submasters with backlit bump buttons.
- 5 color LCD screens with status displays and fader identification.
- Backlit page up and down buttons for independent paging of submaster banks.
- USB 2.0 port A / B ports or daisy chaining multiple units.
- 2x Wing power in / thru ports.
- Kensington lock slot at back of unit.
- Two year limited warranty.



Controls: NEO Playback Controller

A 2U high 19 inch rack mounting playback unit, providing either a stand-alone controller for unattended playback or backup for main control console.

Running the NEO Software it provides a perfect partner for the NEO Console in any system as a backup. Combined with Vision.net it provides a highly flexible and dynamic controller for architectural and event lighting installations.

Features – NEO Playback Controller

- 19 inch rack mount format 2U high.
- Color LCD screen with status display.
- 4 DMX out ports.
- 1 DMX in port.
- 2 Network ports.
- 3 Video outs (HDMI / display port / DVI).
- MIDI out / in.
- SMPTE out / in.
- USB 3.0 and USB 2.0 ports.
- 2 COM ports.
- Audio in / out connections at rear.
- Kensington lock slot at back of unit.
- Two year limited warranty.



Controls: NEO system

NEO Control Console

	Overall dimensions W x H x D	Weight	Order Code
NEO Lighting Control Console (One Universe of DMX) Includes: console dust cover, universal voltage power supply, IEC cables (1 each - US, Europe, Asia), console lights (2 each), and QuickStart guide. Monitor not included.	788 x 143 x 496mm	16.8kg	91001

NEO Console Wings

	Overall dimensions W x H x D	Weight	Order Code
NEO Console Playback Wing Includes: each NEO fader wing includes a wing dust cover, USB cable (1.5m), and QuickStart guide	394 x 138 x 388mm	5.6kg	91005
NEO Console Submaster Wing Includes: each NEO fader wing includes a wing dust cover, USB cable (1.5m), and QuickStart guide	394 x 138 x 388mm	5.6kg	91004

NEO Playback Controller

	Overall dimensions W x H x D	Weight	Order Code
NEO Console / Playback Controller	483 x 97 x 366mm	4.6kg	91006

NEO PC software

	Order Code
NEO PC Lighting Control software (Licence for one universe of DMX) Includes: USB authorization key and QuickStart guide	91016
NEO PC USB to DMX cable (for use with NEO PC software to output local DMX)	91013

NEO – Accessories

	Order Code
Replacement dust cover	91001-DC
NEO software expansion licence for universe of DMX (512 channels) NOTE: Up to 100 can be added to a NEO Control Console, NEO Playback Controller or NEO PC software licence	91002
21 inch touch screen monitor (multi-touch)	91021
Additional / replacement console light	66219
DMX512-A control cable 25ft (A5F to A5M)	95090
Ethernet cable 10ft 10/100BaseT (RJ-45)	96456
Ethernet cable 25ft 10/100BaseT (RJ-45)	96459

NEO Console

goes on tour with Classical Ballet Moscow



The Classical Ballet Moscow recently completed an extensive tour of Italy and Sicily featuring a beautifully emotive lighting design programmed on a NEO Lighting Control Console. The company performed *The Nutcracker*, *Swan Lake* and *Sleeping Beauty* in cities including Florence, Milan and Palermo.

Lighting designer and technical director Evgeniy Toma utilized the NEO's intuitive interface and timesaving features to provide him with quick and easy access to all of the fixtures in the rig, which ranged from 60 to 110 over the course of the tour. "I was really impressed by the flexibility of the NEO console," says Toma. "There are different ways to achieve what you want with it, which is ideal for both an experienced lighting designer and a beginner."

With the tour moving to a different venue each day, the NEO's 'Groups', 'Shortcuts' and 'Cue Lists' meant Toma could easily transition from one set-up to the next. "'Groups' is a very convenient section where I could easily set submaster and effects options, while Shortcuts made accessing different functions much more efficient," says Toma. "As I had to edit the previous show's cues for each theater, I could do it in a few minutes using the 'Cue List' pallets."

Toma could also rest assured the console would be up and running without issue each night. Shows are secured on its "Mission Critical" grade SQL server, ensuring no data loss. In addition, boot time is massively reduced with high-speed solid-state disk drives, making the NEO robust for everyday and touring use.

"I first saw the NEO at PLASA London and was intrigued by its functionality," says Toma. "The more I learn about the console the more I am impressed by it."



Controls: Vision.net 4.5

Vision.net 4.5 is a fully integrated lighting management system designed to meet the most demanding lighting environments. Scalable from a single room to large multi-building campuses, our decentralized control approach delivers unparalleled flexibility and maximum reliability.

Designed to integrate with all Philips Entertainment lighting dimming systems, low voltage switching cabinets, Vari-Lite automated luminaires, Selecon LED fixtures and Showline LED fixtures, Vision.net 4.5 can control any lighting load with intuitive precision.

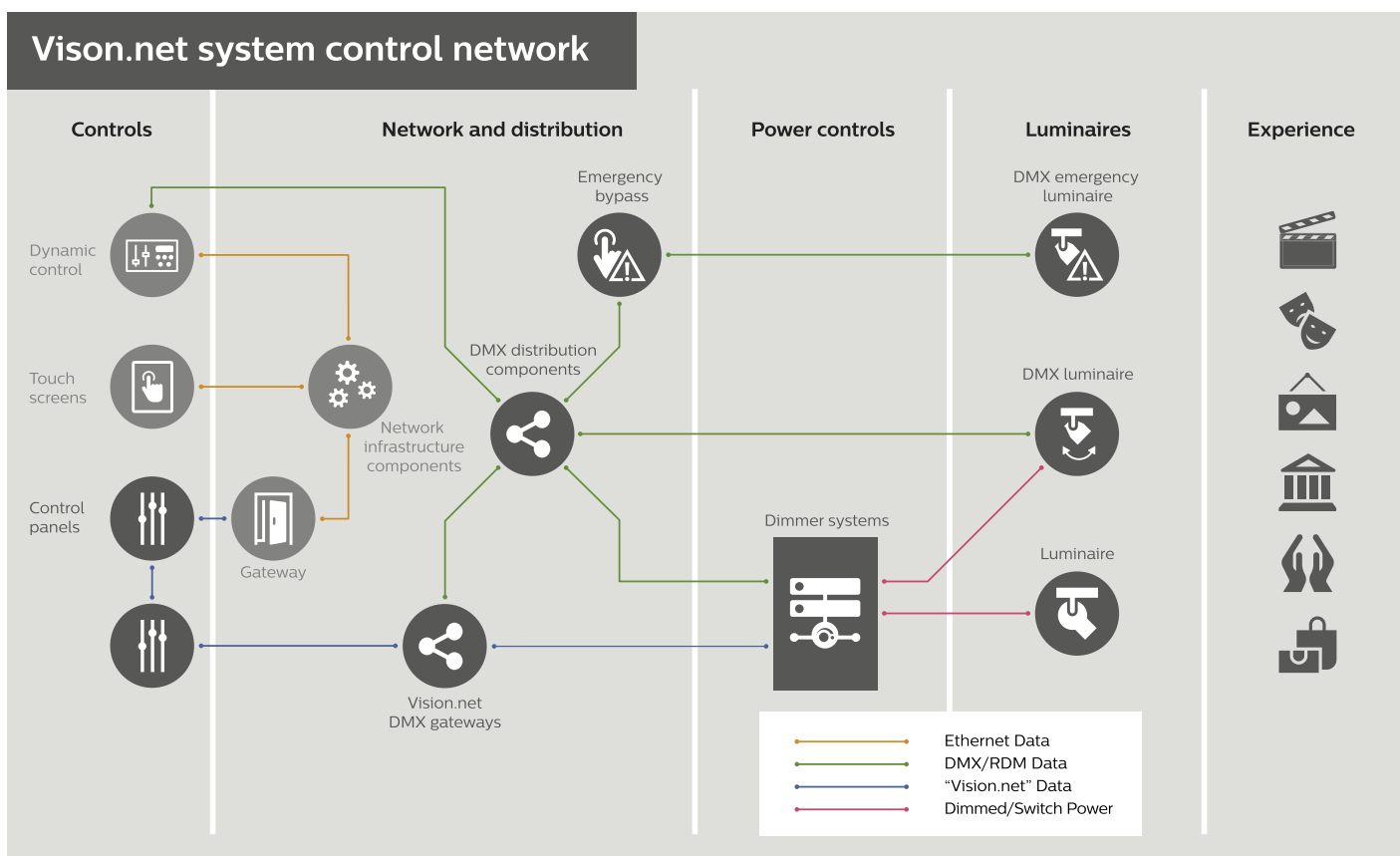

Features

- Next generation scalable architectural control from a single room to a multi-building campus.
- Scales from a single space up to 255 rooms in a single system.
- Large systems can be built by linking up to 1000 areas with up to 255 rooms each.
- Distributed intelligence - no central processor required.
- Available with push button, slider and touchscreen panels.
- Simple computer-based set up and configuration with Vision.net 4.5 designer software.
- Fully scalable to over 1,000 stations.
- Intuitive automated luminaire and LED fixture interface.
- Customizable fixture library to create your own fixtures.
- Occupancy sensors and photocells available.
- Designers can easily create rooms, room combinations and easily define stations and buttons.
- Vision.net 4.5 designer provides a simple graphical set up and configuration system for original set up and updates as the needs of a facility changes.
- Low-cost Cat 5e wiring.
- Touchscreen systems provide connectivity to PaletteOS consoles and dimmer racks for system access and monitoring.
- Smart jacks allow portable stations to be customized for each room.
- One portable can be used in multiple spaces each with a unique configuration.
- 127 channels per room.
- Unlimited dimmers per room with patching and DMX512 snapshot support.
- Astronomical time-clock and calendar-based event.
- Connects to C21, EC21, A21, R21 and contact systems.
- Vision.net 4.5 to DMX512 module available for DMX512 controlled devices
- Two year limited warranty.

Suggested uses:



For more information visit philips.com/strandlighting

Controls: Vision.net 4.5 Touchscreens

Touchscreens, configured using the Vision.net designer software, provide a graphical user interface to a Vision.net system.

Features – Touchscreens

- Communicates with Vision.net over both IP networks and also local RS485 networks using the Vision.net protocol.
- Rapid configuration using drag and drop techniques, making system design and deployment exceptionally fast.
- Powered either by the Vision.net RS485 network or local 24VDC input connector.
- Two year limited warranty.



Controls: Vision.net 4.5 DMX Interface

The Vision.net DMX Interface is a small dedicated DMX processor interface card that allows the Vision.net system to communicate with any third party DMX512-A compatible product.

Features – DMX Interface

- Bridges Vision.net controls to the DMX512-A protocols.
- Multiple Vision.net inputs (2).
- DMX512 input (1).
- DMX512 output (1).
- Addressable via rotary switch.
- Level snapshots into recordable pre-sets.
- Configured utilizing Vision.net designer software.
- Powered either by the Vision.net RS485 network or local 24VDC input connector.
- Scalable device allowing additional cards to be added to a system as required.
- Two year limited warranty.



Controls: Vision.net 4.5 AV Interface

A small push button processor, interfacing external volt free signals into a Vision.net system for controlling lighting scenes.

Features – AV Interface

- Up to 8 volt-free contacts inputs with corresponding LED mimic drives.
- May be expanded to drive low voltage relays.
- Serial data connection for photocell connections and other daylight light saving devices.
- Powered from the Vision.net RS485 network.
- Two year limited warranty.



Controls: Vision.net 4.5 Control Stations

A wide selection of standard and custom-configurable control button or slider stations, that may be either flush or surface mounted.

Features – Push Button Controls

- Up to 8 illuminated push buttons with corresponding LED mimic drives.
- Serial data connection for photocell connections and other daylight light saving devices.
- Powered from the Vision.net RS485 network.
- Two year limited warranty.



Controls: Vision.net 4.5

Touchscreen stations

	Type	Finish	Overall dimensions W x H x D	Order Code
Vision.net 4.5 7-inch color VGA touchscreen station*		Light almond	252 x 76 x 196mm	95242A
Vision.net 4.5 7-inch color VGA touchscreen station*		Black	252 x 76 x 196mm	95242B
Vision.net 4.5 7-inch color VGA touchscreen station Portable in hammond case Includes: Vision.net touch screen portable cable, 25ft (8m), (6m-6F XLR)				95242P
Vision.net 4.5 7-inch color VGA touchscreen station	Flush, locking enclosure	Black		95242SE
Vision.net 4.5 7-inch color VGA touchscreen station	Rack mount	Black		95242RM
Vision.net 4.5 7-inch color VGA touchscreen station	Rack mount			95246RM
Vision.net 4.5 15-inch color VGA touchscreen	Rack mount, locking enclosure			95246SE

*Requires back box to be ordered in addition.

*Back boxes for touchscreen stations

	Finish	Overall dimensions W x H x D	Order Code
Vision.net 4.5 7-inch flush mount back box kit for 95242A or 95242B		243 x 76 x 179mm	95243
Vision.net 4.5 7-inch surface mount back box kit for 95242A	Light almond	243 x 76 x 195mm	95244A
Vision.net 4.5 7-inch surface mount back box kit for 95242B	Black		95244

Slider stations

	Finish	Back box size	Order Code
Vision.net 4.5 slider station with IR, 3 channel and master, 6 pre-sets	White	2-gang	63303
Vision.net 4.5 slider station with IR, 6 channel and master, 6 pre-sets	White	3-gang	63306
Vision.net 4.5 slider station with IR, 9 channel and master, 6 pre-sets	White	4-gang	63309
Vision.net 4.5 slider station, 12 channel and master, 7 pre-sets	White	5-gang	63312
Vision.net 4.5 slider station, 15 channel and master, 7 pre-sets	White	5-gang	63315

Push button stations

	Finish	Back box size	Order Code
Vision.net 4.5 push button station, 1 button	White	1-gang	63321
Vision.net 4.5 push button station, 2 button	White	1-gang	63322
Vision.net 4.5 push button station with IR, 4 button	White	1-gang	63324
Vision.net 4.5 push button station with IR, 18 button	White	1-gang	63328

Receptacle stations

	Finish	Back box size	Order Code
Vision.net 4.5 smart jack receptacle	Stainless steel	1-gang	63341
Vision.net 4.5 RS232 programing station	Stainless steel	1-gang	63035USB

Vision.net 4.5 stations may be custom configured for your facility by indicating the number of buttons or sliders that are required in each gang position.

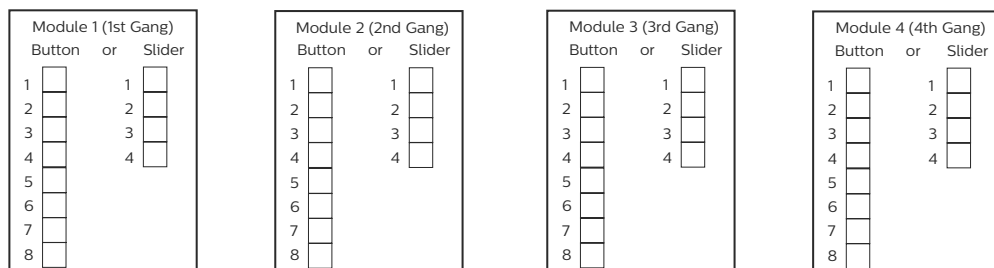

Controls: Vision.net 4.5

Back boxes for sliders, button and receptacle stations

	Order Code
1-gang masonry back box (A) RACO 695, BWRS 1MB	66801
Arch, back box, 2-gang (B)	66802
Arch, back box, 3-gang (C)	66803
Arch, back box, 4-gang (D)	66804
Arch, back box, 5-gang (E)	66805
Arch, back box, 6-gang (F) RACO 965	66806

Custom stations – additional options

	Order Code	Add suffix
Custom Vision.net 4.5 station (please also specify options)	63398	
To make any station portable. Includes: Vision.net portable cable, 25ft (8m), (4M-4F XLR)		PM
Integrated infrared receiver		IR
Finish color		-White
		-Ivory
		-Brown
		-Black
		-Gray

Input / output devices

	Order Code
AV input / occupancy sensor interface	63065SE
Vision.net 4.5 to DMX512-A interface in enclosure	63054-2
Vision.net 4.5 4-way data cable splitter for panel mounting	63055RM
Vision.net 4.5 4-way data cable splitter with enclosure	63055SE

System extension cables

Portable station cables	Order Code
Vision.net 4.5 portable extension cable, 10ft (3m), (A4M-A4F)	95095
Vision.net 4.5 portable extension cable, 25ft (8m), (A4M-A4F)	95096
Vision.net 4.5 portable extension cable, 50ft (16m), (A4M-A4F)	95096
Smart jack cables	
Vision.net 4.5 smart jack cable, 10ft (3m), (4M-4F XLR)	66093/10
Vision.net 4.5 smart jack cable, 25ft (8m), (4M-4F XLR)	66093/25
Vision.net 4.5 smart jack cable, 50ft (16m), (4M-4F XLR)	66093/50
Vision.net 4.5 smart jack cable, 100ft (32m), (4M-4F XLR)	66093/100
Touchscreen cables	
Vision.net 4.5 touchscreen portable cable, 25ft (8m), (6M-6F XLR)	66099
Vision.net 4.5 touchscreen portable cable, 50ft (16m), (6M-6F XLR)	66099/50

Accessories – Configuration software

	Order Code
Windows configuration software on CD-ROM	67518

Stand alone lighting control consoles

	500ML	250ML
		
Connectivity	1x Ethernet (RJ45) port (Art-Net™ / ShowNet) 2x USB 2.0 port (front, library storage - USB key sold separately) 1x USB 2.0 port (rear, touchscreen connection - touch screen not included) 1x DVI (HD) monitor output (monitor not included) 4x DMX512-A out (XLR5F) ports 3x MIDI (1 each - in / out / thru) ports	1x Ethernet (RJ45) port 1x USB port (front, library storage - USB key sold separately) 1x USB port (rear, desk light connection only) 1x VGA (1024 x 768) monitor output (monitor not included) 1x DMX512-A in (XLR5M) port 2x DMX512-A out (XLR5F) ports 2x MIDI in / thru ports
DMX512-A control and channels	2,048 DMX channels, 4 universes 500 fixtures 500 groups 500 pre-sets 500 cue lists (each with up to 500 cues in total)	1,024 DMX channels, 2 universes 1 DMX512-A in port 250 intensity channels 30 attributed fixtures (up to 40 attributes) 24 submasters (24 pages) 999 cues
Supply voltage	Universal power supply 100–240VAC	Universal power supply 100–240VAC
Construction	Rigid folded sheet steel and flame retardant ABS controls	Rigid folded sheet steel and flame retardant ABS controls
Operating temperature	0–40°C ambient	0–40°C ambient
Humidity	0–95% non-condensing	0–95% non-condensing
Storage temperature	0–35°C	0–35°C
Weight	20.5kg	8.8kg
Dimensions L x W x H	657 x 489 x 308mm	734 x 324 x 81mm
Warranty	2 years	2 years

200 plus series	100 plus series	Sixer
		
<p>1x Ethernet (RJ45) port, Art-Net™ compatible 1x USB port (library storage - USB key sold separately) 1x VGA monitor outputs (monitors not included) 1x DMX512-A in (XLR5M) port 2x DMX512-A out (XLR5F) ports</p>	<p>1x DMX512-A out (XLR5F) port</p>	<p>5-pin, DMX512-A out</p>
<p>6 available operation modes: single scene, two scene, submaster, moving light, LED and FX playback. 12 pages of submasters. Each submaster page has 24 submasters. 288 total submasters over 24 pages. 12 FX stacks. Each FX stack can have 48 steps. FX stacks can be previewed on system faders. Total of 576 recordable steps. Supports 12 moving lights and 12 LED lighting fixtures.</p>	<p>99 memories. 12 channel 2 scene pre-set, 24 channel single scene pre-set operation with unique hold function in single scene mode. Built-in effect playback.</p>	<p>DC operation by external power adaptor. Possible power by 9V battery. 6 channels manual fader with master. DMX-512(1990) output.</p>
<p>Universal power supply 90-240VAC</p>	<p>Universal power supply 90-240VAC</p>	<p>9VDC (either AC to DC supply - provided with unit or 9V battery - not provided)</p>
<p>Rigid folded sheet steel and flame retardant ABS controls</p>	<p>Rigid folded sheet steel and flame retardant ABS controls</p>	<p>Rigid folded sheet steel. Powder-coat epoxy paint black finish</p>
<p>0-40°C ambient</p>	<p>0-40°C ambient</p>	<p>0-35°C ambient</p>
<p>0-95% non-condensing</p>	<p>0-95% non-condensing</p>	<p>0-95% non-condensing</p>
<p>0-35°C</p>	<p>0-35°C</p>	<p>0-35°C</p>
<p>6.8kg 200 plus 12/24 9.5kg 200 plus 24/48</p>	<p>2.0kg</p>	<p>1.0kg</p>
<p>568 x 318 x 79mm 200 plus 12/24 804 x 319 x 79mm 200 plus 24/48</p>	<p>566 x 365 x 83mm</p>	<p>148 x 166 x 42mm</p>
<p>2 years</p>	<p>2 years</p>	<p>2 years</p>

Controls: 500ML

The Philips Strand 500ML lighting control console is designed to operate dimmers, LED fixtures and moving lights.

An 8-inch TFT color touchscreen allows for fast set up. Backlit command buttons aid in the ease of use. If required, the unit has one external DVI port to add a touch monitor to give even more control.

24 faders, each may be used as a master, submaster or playback. Equipped with backlit play, pause / reverse and bump buttons allowing cue stacks to be triggered as required for busking 'moments'.

Using industry standard methods of control, the user interface is quick to understand, allowing the operation to appeal both to the casual and professional operator alike.

The console's robust construction provides a smart way to create and playback great lighting for events.



Product specification

	Overall dimensions L x W H	Weight	Order Code
500ML Lighting Control Console Includes: Console includes console dust cover, AC power input cables, USB key drive, LED desk lamp, and QuickStart guide. External monitor not included.	657 x 489 x 308 mm	20.5 kg	65354

Accessories

	Order Code
DMX512 control cable 25ft (A5F to A5M)	95090
Ethernet cable 10ft 10/100BaseT (RJ45)	96456
Ethernet cable 25ft 10/100BaseT (RJ45)	96459
USB key drive	67528
21-Inch touchscreen monitor	91021

Features

- 8-inch (800 x 600 pixels) TFT color touch screen.
- 2 DMX out ports.
- 119 backlit keys / 4 rotary encoders / 24 faders / 1 level wheel.
- LCD fader bank information screens.
- Supports up to 500 cue lists of 500 cues.
- 24 faders can be either submasters, playbacks or effects.
- DMX512-A.
- MIDI in / out / thru.
- RJ45 network port (Art-Net™).
- DVI external monitor output.
- 3 USB ports (2 front, 1 rear).
- Supports 3-pin XLR desk lamps.
- Programming / status displays.
- Two year limited warranty.

Suggested uses:



For more information visit philips.com/strandlighting

Controls: 250ML

The Philips Strand 250ML lighting control console is the perfect desk to introduce you to the world of intelligent fixture control. Built for entry level operation and small to medium sized theaters, the 250ML gives you a simple interface, great features and an even better price.

It merges the world of conventional dimmer / channel control using traditional command line operation with an easy-to-use interface for attributed fixtures using a color LCD screen that has soft keys and attribute encoders.

The 250ML console can control 250 channels for dimmers and 30 automated luminaires for moving lights and LEDs. Your looks can be stored as either submasters for easy access or cues for traditional theater playback.

With the 250ML console's extensive and editable fixture library, you'll never be without the tools you need to control your lighting rig.



Product specification

	Overall dimensions L x W H	Weight	Order Code
500ML Lighting Control Console	657 x 489 x 308mm	20.5kg	65354

Included with console: dust cover, AC power input cables, USB key drive, LED desk lamp, and QuickStart guide. External monitor not included.

Accessories

	Order Code
DMX512 control cable 25ft (A5F to A5M)	95090
Ethernet cable 10ft 10/100BaseT (RJ45)	96456
Ethernet cable 25ft 10/100BaseT (RJ45)	96459
USB key drive	67528

Features

- 250 intensity channels.
- 30 automated luminaires.
- 2 DMX ports with 1,024 outputs.
- 1 DMX in port.
- Integrated moving light control with LCD screen, 10 softkeys and 4 encoders.
- 24 submasters with 24 pages.
- 999 cues.
- Faders can be either submasters, playbacks, or effects.
- Cue playback with A / B faders and load / GO buttons.
- DMX512-A.
- MIDI in / thru.
- VGA output.
- Intuitive effects engine.
- Traditional command line entry.
- Multi-color bump buttons.
- Front panel USB port for showfile storage.
- Rear USB port for desk lamp.
- Two year limited warranty.

Suggested uses:



For more information visit philips.com/strandlighting

Controls: 200 plus series

Philips Strand 200 plus series consoles offer you a choice of 24 or 48 submasters plus conventional pre-set operation. Choose either submaster, two scene or expanded single scene operation on the fly to meet the needs of your production.

We did not forget the latest generation of LED luminaires either with a full suite of controls for multi-color LED luminaires. The console will also run up to 24 moving lights allowing you complete control of both conventional dimmers and a host of sophisticated next generation luminaires.

The 200 plus console also features 12 Effects playbacks with each effect having up to 48 steps. Effects are easy to access, record and change dynamically. All show information can be saved to a USB memory device to give you a secure back up of your show.

The 200 plus console has a DMX512-A capture function allowing you to capture up to 512 channels of DMX512-A from a larger console and play them back. There are 12 memories available.

Simple to use and set-up with a wide range of features, the 200 plus series consoles are an ideal choice for facilities that need a compact and effective lighting controller.



Product specification

	Overall dimensions L x W H	Weight	Order Code
200 plus series 12/24 console	568 x 318 x 79mm	6.8kg	64331
200 plus series 24/48 console	804 x 319 x 79mm	9.5kg	64341

Included with console: dust cover, integrated video (VDU) card, universal voltage power supply, and printed installation guide. Monitors not included.

Accessories

	Order Code
DMX512 control cable 25ft (A5F to A5M)	95090
Ethernet cable 10ft 10/100BaseT (RJ-45)	96456
Ethernet cable 25ft 10/100BaseT (RJ-45)	96459
Spare dust cover (200 plus series 12/24)	64335
Spare dust cover (200 plus series 24/48)	64345
USB key drive	67528
20-inch flat panel monitor	95220

Features – 200 plus 12/24 console

- Six available operation modes: single scene, two scene, submaster, moving light, LED and FX playback.
- 12 pages of submasters.
- Each submaster page has 24 submasters.
- 288 total submasters over 24 pages.
- 12 FX stacks.
- Each FX stack can have 48 steps.
- FX stacks can be previewed on system faders.
- Total of 576 recordable steps.
- Supports 12 moving lights and 12 LED lighting fixtures.
- Show files, console contents can be saved on a USB drive.
- Two trigger buttons for external DMX512-A devices.
- You can record a full 512 channels into the DMX512-A base memory.
- 512 total DMX512-A outputs.
- DMX512-A input recorder with 12 memories.
- Integrated video display port.
- Two year limited warranty.

Features – 200 plus 24/48 console

- Six available operation modes: single scene, two scene, submaster, moving light, LED and FX playback.
- 24 pages of submasters.
- Each submaster page has 48 submasters.
- 1152 total submasters over 48 pages.
- 12 FX stacks.
- Each FX stack can have 96 steps.
- FX stacks can be previewed on system faders.
- Total of 1152 recordable steps.
- Supports 24 moving lights and 24 LED lighting fixtures.
- Show files, console contents can be saved on a USB drive.
- Two trigger buttons for external DMX512-A devices.
- You can record a full 512 channels into the DMX512-A base memory.
- 512 total DMX512 outputs.
- DMX512-A input recorder with 12 memories.
- Integrated video display port.
- Two year limited warranty.

Suggested uses:



For more information visit philips.com/strandlighting

Controls: 100 plus series

The Philips Strand 100 plus series console is a small, simple to use, pre-set lighting control desk that also has a theatrical cue stack of 99 memories. It can be operated in 24 channel single scene mode or 12 channel two scene mode. In single scene mode multiple scenes can be set with the Hold feature. The console also has the ability to run a single effect.



Product specification

	Overall dimensions L x W H	Weight	Order Code
100 plus series 12/24 console	566 x 365 x 83mm	2.0kg	61318

Included with console: dust cover, universal voltage power supply, and printed installation guide.

Accessories

	Order Code
DMX512 control cable 25ft (A5F to A5M)	95090
Spare dust cover (100 plus series 12/24)	61315

Features

- Fully digital control console.
- 99 memories.
- 12 channel 2 scene pre-set, 24 channel single scene pre-set operation with unique hold function in single scene mode.
- Built in effect playback.
- Designed for portable or rack mounting applications with removable end caps to facilitate rack mounting.
- Split crossfader with time fade function.
- Bump buttons.
- Grandmaster and black out key.
- DMX512-A output.
- Supplied with 90-240 Volt CE, UL, cUL universal power supply.
- Two year limited warranty.

Suggested uses:



For more information visit philips.com/strandlighting

Controls: Six Control Desk

The Philips Strand Sixer portable DMX512 controller is a small, simple to use, single-preset lighting desk.

The Sixer portable DMX512 control desk offers control of six DMX512 lighting channels through its six channel faders and grandmaster.



Product specification

	Overall dimensions H x W x D	Weight	Order Code
Sixer six channel portable DMX512-A Control Desk for 230/240 VAC operation	148 x 166 x 42mm	1.0kg	75801

Note: All Sixer Control Desks include AC to DC power supply and operations manual.

Features

- Compact size, easy to use.
- Six individual channel faders and one grandmaster.
- Standard 5-pin DMX512 output connector.
- Operates with supplied AC to 9-volt DC adapter or 9-volt battery.
- Supplied power supply is CE marked and UL listed.
- Available in 120 VAC and 230/240VAC markets.
- On-board on / off switch to save battery life when not in use.
- Two year limited warranty.

Suggested uses:



For more information visit philips.com/strandlighting

Controls: Accent DMX Pre-set Control Stations

Designed for the European and Asian markets, Philips Strand Accent DMX stations are simple to use and operate. Each station supports up to 48 DMX dimmers. Room 1 has dimmers 1-48, room 2 has dimmers for 49-96 and each additional room increments in blocks of 48 to a maximum of 8 rooms. Room selection is via dipswitch on the back of each station. A21, Wallrack, and C21/EC21 racks support DMX512-A patching allowing the creation of smaller rooms using their integrated Mux patch functionality.

Each station has a built in IR port for use with the included IR remote programmer. The programmer allows the operator to record, modify and playback presets on each station. Designed to fit in a single gang back box these stations provide a clean simple to use control interface. Pre-sets can be selected at the touch of a button and the integrated raise lower keys allow the operator to master an entire pre-set proportionally.



Accent DMX Pre-set Control Stations

	Finish	Back box size	Order Code
Accent DMX pre-set control stations, with wireless IR remote programmer, 8 push button	White	1-gang	63200
Accent DMX pre-set control stations, with wireless IR remote programmer, 4 push button	White	1-gang	63201

Back boxes for Accent DMX Panels

	Order Code
1-gang masonry back box (A) RACO 695, BWRS 1MB	66801



Accessories

	Order Code
Spare Accent DMX wireless IR remote programmer	63203

Features

- Available in Asian markets.
- Four and eight pre-set control stations with individual pre-set fade times.
- Raise lower mastering.
- Up to 48 dimmers per room, up to 8 stations and 8 rooms per system.
- Room selection by dip switch selection on control station no special programming required.
- Compatible with all Strand dimmer racks DMX512-A.
- Wireless IR remote provided with each station for simple programming and remote pre-set access.
- Secure, fastener-free faceplates.
- Secure digital control wiring system.
- Fits standard U.S. 1-gang deep masonry box.
- DMX512-A (1990) output.
- Two year limited warranty.

Suggested uses:



For more information visit philips.com/strandlighting

Controls: SL SC-DMXrec

The Showline SC-DMXrec is a simple show controller designed to playback DMX information for applications where a full lighting control console is not required. Record up to five hours of show time, or record snapshots of incoming DMX information from a lighting control console. Create scenes, chases and shows for playback as required and assign to one of eight memory slots.

A comprehensive choice of cue/chase/show triggering delivers full flexible solutions for installations where DMX luminaires need to be integrated into a building lighting control system. Recorded data can be easily backed up via the SD card slot, or directly copied to a PC via USB cable. The SC-DMXrec can also be utilized as a simple back up show controller for applications requiring redundant control.

Recorded data can be easily backed up via the SD card slot, or directly copied to a PC via USB cable. The SC-DMXrec can also be utilized as a simple back up show controller for applications requiring redundant control.



Product specification

	Input	Overall dimensions L x H x W	Weight	Order Code
SC-DMXrec playback controller	9VDC, 500mA 5 pin XLR socket for DMX 512 (DMX in) 5 pin DIN socket for MIDI 5 pin XLR socket for SMPTE 8 dry contact closures for memory selection 4 dry contact closures for memory triggering	482 x 44 x 78mm	1.1kg	88-095-3030-00

Features

- Records and outputs one universe of DMX512-A.
- 5 trigger modes: internal timeclock, SMPTE, MIDI, DMX, and manual.
- 8 memories with individual settings for assigning shows, scenes or chases.
- Over five hours of storage for show time.
- 4 recording modes.
- Dry contacts available for each memory and playback controls.
- Terminal connectors for input and output connections.
- Color LCD display for easy configuration.
- Two year limited warranty.

Suggested uses:



For further information visit philips.com/showline

Controls: SL RDM Commander

The Showline RDM Commander is the latest testing, setting and monitoring tool for all DMX and/or RDM capable devices. Aside from the normal characteristics of a standard DMX tester, the unit is equipped with a wide range of additional features for use with RDM ready devices and moving lights; such as address setting, temperature monitoring, group setting, copy and paste and many more. With its in-built rechargeable battery, the RDM Commander is ideal for all on-site or bench testing applications.



Product specification

	Overall dimensions L x W x H	Weight	Order Code
SL RDM Commander	208 x 208 x 75mm	0.6kg	88-095-50000-00

Features

- Lightweight and easy to use.
- Large clear display.
- Built-in rechargeable 4x 1.2V/1600mA batteries for easy use in the field.
- Short cut function available.
- SD card slot for program update.
- Standard DMX512-A and RDM protocol compatible.
- Two year limited warranty.

Suggested uses:



For further information visit philips.com/showline

Data distribution: DMX Networking Nodes

The next generation of DMX512 networking nodes. Following on the heels of the N21 ShowNet nodes, the DMX512 Networking nodes expand the formats supported to include sACN, Art-Net, RDM, ShowNet, Vision.net and more.

Compact and flexible, these networking nodes provide cost-effective network connectivity for facilities of all sizes. Each node can be dynamically configured for input or output operation or Vision.net bridging. Node status, Node ID, port identification, and configuration are available on the integral LCD display (three-port and eight-port models). The display features a full-range of menu options and the backlight are user adjustable.

All Philips Strand Lighting networking nodes feature advanced DMX512 patching, permitting any range of 512 numbers to be selected for each DMX512 port. Priority patching with up to three levels of priority assignments is available.



Product specification

	Ports	DMX	Ethernet	Protocols	Overall dimensions L x W x H	Weight	Order Code
Networking Node	1	1x 5-pin Female XLR	1x RJ45	E1.31 Streaming ACN (sACN) Art-Net™ ShowNet RDM	70 x 95 x 128mm	0.70kg	65161
Networking Node	3	3x 5-pin Female XLR	3x RJ45	E1.31 Streaming ACN (sACN) Art-Net™ ShowNet RDM	115 x 95 x 128mm	0.86kg	65163
Networking Node	8	8x 5-pin Phoenix	2x RJ45	E1.31 Streaming ACN (sACN) Art-Net™ ShowNet RDM	442 x 160 x 44mm	1.86kg	65168
Networking Node	8	8x 5-pin Female XLR	2x RJ45	E1.31 Streaming ACN (sACN) Art-Net™ ShowNet RDM	442 x 160 x 44mm	1.86kg	65168-1

Product specification

	Description	Order Code
Networking Node PCB	Dual Port (includes DMX B RJ45 port), For R21/A21/Contact Systems	74261

Features

- Compact and cost-effective DMX512 nodes.
- Fast 40 Hz DMX512 update rate.
- Ports may be custom configured with any of the DMX512 addresses for complete system flexibility.
- Ports may be configured to support Vision.net control - bridging to Vision.net areas.
- 10/100BT ethernet operation.
- Three-port and eight-port nodes provide an integral LCD display provides node and port labeling, node status and configuration information.
- Integral LCD display (three-port and eight-port models) is user adjustable for dark applications.
- 1U rack mount nodes available with eight DMX512 ports - two models either 5-pin Phoenix or 5-pin XLR connectors.
- Nodes are available in wall mount and 1U rack mount variants.
- Single-port and three-port models include back box (for flush or surface mounting), rubber feet and removable C-clamp.
- Single-port node fits into standard single-gang box and three-port node fits standard two-gang back box.
- Single-port and three-port nodes are fully compliant with IEEE802.3af power over ethernet.
- Compatible with ShowNet, sACN, Vision.net and Art-Net nodes and control systems.
- Two year limited warranty.

Suggested uses:



For more information visit philips.com/strandlighting

Data distribution: Emergency DMX Bypass Switch

The Philips Strand Emergency DMX Bypass Switch provides emergency and panic lighting control solutions for DMX driven house lights and DMX controlled lighting used in emergency and egress lighting.

Each bypass unit handles up to four (4) individual universes of DMX or can be used as a DMX splitter handling 1 in 4 out, or 2 in 2 out routing scenarios.

The bypass handles more than just emergency and has separate triggers for panic situations as well.

Each state – panic or emergency, can be set to trigger “snap shot” loads or can be set to drive all loads on each DMX path to 100%. Each state (panic or emergency) can be triggered via normally open, normally closed dry contacts, or from a 12VDC signal.

Once the state is returned to normal, the bypass returns loads to the DMX controller in a variety of different ways. These return states can be timed at 1 minute, 10 minutes, or can be set to return under intelligent timing when valid DMX inputs are sensed.

This device is a simple affordable solution for all of your DMX emergency and panic system needs.

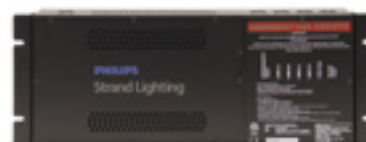

Product specification

	Mounting	Overall dimensions W x H x D	Weight	Order Code
Emergency DMX Bypass Switch	Surface / rack	483 x 178 x 77mm	4.4kg	96250

Features

- Intelligent emergency call and reinstatement modes.
- Accepts up to four (4) DMX universes.
- Emergency input.
- Panic input.
- Integrated DMX splitter with user-selectable operational settings.
- Emergency and panic test buttons.
- Durable, steel construction that easily mounts near lighting control panels or inside 19inch racks.
- Reversible ears for rack or wall mounting.
- Data connectors on screw terminals for ease of installation.
- Two year limited warranty.

Suggested uses:



For more information visit philips.com/strandlighting

Data distribution: RDM-6R Splitter

The Philips Strand RDM-6R Splitter is a 19inch rack mounted DMX/RDM splitter designed for system integration applications, where DMX/RDM distribution tools are needed.

The unit provides 5 pin XLR connectors for DMX/RDM pass-through, supporting bidirectional communications for discovery, addressing and DMX control of devices. The output 5 pin XLR sockets are electronically isolated from the input & RDM-through port, sharing a common ground reference.



Product specification

	Overall dimensions W x H x D	Weight	Order Code
DMX512-A / RDM 6 ports splitter, 1U rack mount	482 x 185 x 44mm	2.0kg	RDM6R

Features

- 19inch rack mount format 1U high.
- Hardwired power input cable to bare ends.
- DMX512-A / RDM and DMX-512(1990) on 5 pin XLR connectors.
- DMX in and thru connections on rear.
- 6 isolated buffered outputs on the front.
- DMX line termination push button.
- Front panel on / off switch.
- Two year limited warranty.

Suggested uses:



For more information visit philips.com/strandlighting

Data distribution: RDM-6TS Splitter

The Philips Strand RDM-6TS Splitter is a truss mounted DMX/RDM splitter, designed for event and touring applications, where DMX/RDM distribution tools are needed close to the light fittings.

The unit provides 5 pin XLR connectors for DMX/RDM pass-through, supporting bidirectional communications for discovery, addressing and DMX control of devices. The output 5 pin XLR sockets are electronically isolated from the input and RDM-through port, sharing a common ground reference.



Product specification

	Overall dimensions W x L x H	Weight	Order Code
DMX512A(RDM) 6 ports splitter, truss mount	264 x 134 x 120mm	1.45kg	RDM6TS

Features

- Truss mounted format.
- Hardwired power input cable to bare ends.
- DMX512-A(RDM) and DMX-512(1990) on 5 pin XLR connectors.
- DMX In and thru connections on one side.
- 6 isolated buffered outputs on the other.
- Two year limited warranty.

Suggested uses:



For more information visit philips.com/strandlighting

Data distribution: RDM-6Wall Splitter

The Philips Strand RDM-6Wall Splitter is a 6-output DMX/RDM wall mounting splitter, designed for system integration applications, where simple DMX/RDM distribution tools are needed.

The unit provides DMX/RDM pass-through, supporting bidirectional communications for discovery, addressing and DMX control of devices. Taking the incoming DMX/RDM signal and splitting the signal into six separate output channels, expanding the number of devices that may be connected to a DMX line.

The output terminals are electronically isolated from the input and RDM-through port and share a common ground reference. All six output ports have an independent output driver to boost the DMX/RDM signal.



Product specification

	Overall dimensions L x H x W	Weight	Order Code
DMX512-A / RDM 6 port splitter, wall mount	195 x 22 x 106mm	0.2kg	RDM6WALL

Features

- Contractor friendly, small compact format.
- Surface or DIN-rail mountable.
- 1:6-way DMX/RDM splitter / booster.
- Isolated DMX/RDM input / outputs.
- Low voltage 24V power input.
- DMX/RDM in / thru connectors with screw terminals.
- Two year limited warranty.

Suggested uses:



For more information visit philips.com/strandlighting

Power controls

Whether your goal is to create a future proof facility using the latest advances in LED and other light source technologies, or you prefer to follow traditional power management designs with a centralised system, Strand Power Management has the solution.

Live performance venues

Quiet, flexible and cost-effective distributed power solutions ideal for theatrical installations of any size.

Easy to install and operate, our eS21 power management system connects seamlessly with our network-based lighting control consoles and Vision.net architectural controls to form fully integrated lighting control systems which freely mix conventional, automated and LED lighting loads.

Broadcast studios

Low-energy studio lighting combining LED luminaires with complete control while significantly reducing your air conditioning costs. Our silent distributed dimming and control systems allow you to create a studio anywhere without worrying about expensive and elaborate dimmer rooms and power systems.

Power controls: EC21 Racks and Processors

The Philips Strand EC21 dimming system represents premium performance and high value for all levels of users. Designed to interface directly with Strand Lighting's ShowNet ethernet, the EC21 system includes an ethernet port and an optional integral 4-port switch and a wide range of inputs. Two DMX512 inputs are standard with the second input available for use as an RS485 port to support our Vision.net architectural system and 128 back-up presets.

All Thyristor dimmers feature highperformance chokes and two levels of rise time filtering. The latest technology IGBT dimmers are available in dual 2.5kW and single 5kW dimmer modules. IGBT dimmers provide virtually silent loads. The EC21 system may be fully populated with IGBT dimmers or mixed with Thyristor dimmers in the same rack offering best value.

EC21 Dimming systems feature a universal 24 or 48-module rack design that provides support for 90–260 volt operation and is CE marked, meeting a wide range of requirements within a single rack.



Product specification

Type	Overall dimensions H x W x D	Weight	Order Code
EC21 advanced technology dimmer rack, 48 module, single top feed	2032 x 623 x 660mm	226kg	75502/230
EC21 advanced technology dimmer rack, 48 module, single top feed with Amp traps	2032 x 623 x 660mm	226kg	75503/230
EC21 advanced technology dimmer rack, 24 module, single top feed	1448 x 623 x 660mm	181kg	75512/230
EC21 advanced technology dimmer rack, 24 module, single top feed with Amp traps	1448 x 623 x 660mm	181kg	75513/230

Housings

	Order Code
EC21 single 96-output rack processor housing with processor	76520-0001/EC
EC21 single 96-output rack processor housing with processor and architectural power supply	76520-0002/EC
EC21 single 96-output rack processor housing with processor and ethernet switch	76520-0003/EC
EC21 single 96-output rack processor housing with processor architectural power supply and ethernet switch	76520-0004/EC
EC21 tracking backup 96-output rack processor housing with two processors, architectural power supply and ethernet switch	76520-0005/EC
96-output spare / backup rack processor module	76522/230

Features

- 24 and 48 module racks with lockable easy view steel doors.
- Plug-in modular dimmer system.
- Advanced technology processor features a built-in ethernet input port.
- An optional plug-in ethernet switch is available to link multiple racks.
- European DIN standard breakers.
- Optional RCD per circuit.
- Ample wire chamber for ease of installation and to accommodate oversize load wiring.
- Fault beacon for easy notification of faults.
- Web browser configuration.
- Vision.net architectural control.
- 128 back-up pre-sets.
- DMX512 input with patch.
- Dual Processor option with full tracking back up available.
- Emergency rack panic feature (hard wired for security of local or remote control).
- Dual 2.5kw and single 5.0kW IGBT dimmer with 650µs rise time.
- Dual 3.0kW and 5.0kW Thyristor dimmer modules with 200µs or 435µs filter chokes.
- Contactor and Fluorescent modules available to control a wide range of loads.
- IGBT and Thyristor modules may be mixed in the same rack.
- Optional Amp traps for full 100,000 AIC fault current rating.
- Two year limited warranty.

Suggested uses:



For more information visit philips.com/strandlighting

Power controls: EC21 Dimmer Modules

The Philips Strand EC21 dimmer rack was developed in response to in-depth market research from key customers and consultants. The EC21 has set an unprecedented industry first by providing the ability to install 96 2.5kW IGBT dimmers in a single rack – greatly increasing dimming density for IGBT users.

The EC21 dimming system allows users to freely mix dimmers of any type (both IGBT and conventional modules) within a single rack. All dual and single dimmer and contactor modules may be ordered with our optional dimmer status reporting electronics, providing system operators with a wide range of dimmer information.

All dimmer status and rack configuration is available via any web browser connected to the lighting network. EC21 dimmer systems feature a universal 24 or 48-module rack design that provides support for 90–260 volt operation and are CE marked.



IGBT dimmer modules

Type	Order Code
EC21 230VAC 2.5kW dual IGBT module, 16A SP	76674
EC21 230VAC 2.5kW dual IGBT module, 16A RCBO	76675
EC21 230VAC 5.0kW dual IGBT module, 16A SP	76676
EC21 230VAC 5.0kW dual IGBT module, 16A RCBO	76677

Constant modules (non-dim)

Dual 3kW SP	76658
Dual 3kW SPN	76659
Dual 3kW RCD	76660
Dual 5kW SP	76664
Dual 5kW RCD	76666
Dual 5kW RCD reporting	76669

Fluorescent modules (3 wire)

Single 3kW FL SP	76643
Single 3kW FL SPN	76644

Contactor modules (non-dim)

Dual 3kW ND SP	76646
Dual 3kW ND SPN	76647
Dual 3kW ND RCD	76648
Dual 3kW ND SP reporting	76649
Dual 3kW ND SPN reporting	76650
Dual 3kW ND RCD reporting	76651
Dual 5kW ND SP	76652
Dual 5kW ND RCD	76654
Dual 5kW ND SP reporting	76655
Dual 5kW ND SPN reporting	76656
Dual 5kW ND RCD reporting	76657

Thyristor dimmer modules - standard dimmers

Type	Order Code
Dual 3kW 200µs SP	76601
Dual 3kW 200µs SPN	76602
Dual 3kW 200µs RCD	76603
Dual 3kW 435µs SP	76604
Dual 3kW 435µs SPN	76605
Dual 3kW 435µs RCD	76606
Dual 5kW 200µs SP	76613
Dual 5kW 200µs SPN	76614
Dual 5kW 200µs RCD	76615
Dual 5kW 435µs SP	76616
Dual 5kW 435µs SPN	76617
Dual 5kW 435µs RCD	76618
Single 10kW 200µs SP	76625
Single 10kW 200µs SPN	76626
Single 10kW 200µs RCD	76627

Thyristor dimmer modules - reporting dimmers

Dual 3kW 200µs SP	76607
Dual 3kW 200µs SPN	76608
Dual 3kW 200µs RCD	76609
Dual 3kW 435µs SP	76610
Dual 3kW 435µs SPN	76611
Dual 3kW 435µs RCD	76612
Dual 5kW 200µs SP	76619
Dual 5kW 200µs SPN	76620
Dual 5kW 200µs RCD	76621
Dual 5kW 435µs SP	76622
Dual 5kW 435µs SPN	76623
Dual 5kW 435µs RCD	76624
Single 10kW 200µs SP	76631
Single 10kW 200µs SPN	76632
Single 10kW 200µs RCD	76633
Single 10kW 435µs SP	76634
Single 10kW 435µs SPN	76635
Single 10kW 435µs RCD	76636

Filler modules (no electronics)

Single filler	76588
Row filler module	76697

Power controls: EC21 Power Through Dimming Modules

Philips Strand EC21 Power Through Modules offer a dual 250uS/400uS (230 VAC) SSR dimmer (Silicon Controlled Rectifier) in conjunction with a mechanical bypass relay for each dimmer. Each module has two individual recess mounted switches that allow for a manual switch control between dimmer, power through and non-dim (relay) so that there is never a mistake about how your system is set up.

Many solid state lighting instruments do not like power from a dimmed circuit. The manual switches on each module ensure that you have complete control of your rig's power with-out any question regarding remote activation or deactivation of your EC21 Power Through Module settings.

In dimmer (DIM) mode, the SSR will work exactly the same way that EC21 dimmers have worked for years.

In power through (BP-constant) mode the circuit will completely bypass the choke and SSR giving you clean power to your lighting devices and power supplies that require a constant power feed. In non-dim mode (ND) the delivery of full power to the load is controlled via the console.



240VAC - 16A, 3.0kW, dual SSR dimmers

Type	Order Code
EC21 dual 3kW Dim/BP module with RCBO 250µs	76603BP
EC21 dual 3kW Dim/ND/BP module with RCBO 250µs	76603BPR
EC21 dual 3kW Dim/BP module with RCBO 400µs	76606BP
EC21 dual 3kW Dim/ND/BP module with RCBO 400µs	76606BPR
EC21 dual 3kW Dim/BP module with RCBO 250µs with reporting	76609BP
EC21 dual 3kW Dim/ND/BP module with RCBO 250µs with reporting	76609BPR
EC21 dual 3kW Dim/BP module with RCBO 400µs with reporting	76612BP
EC21 dual 3kW Dim/ND/BP module with RCBO 400µs with reporting	76612BPR

240VAC - 25A, 5.0kW, dual SSR dimmers

Type	Order Code
EC21 dual 5kW Dim/BP module with RCBO 250µs	76615BP
EC21 dual 5kW Dim/ND/BP module with RCBO 250µs	76615BPR
EC21 dual 5kW Dim/BP module with RCBO 400µs	76618BP
EC21 dual 5kW Dim/ND/BP module with RCBO 400µs	76618BPR
EC21 dual 5kW Dim/BP module with RCBO 250µs with reporting	76621BP
EC21 dual 5kW Dim/ND/BP module with RCBO 250µs with reporting	76621BPR
EC21 dual 5kW Dim/BP module with RCBO 400µs with reporting	76624BP
EC21 dual 5kW Dim/ND/BP module with RCBO 400µs with reporting	76624BPR

Features

- Future proofing your lighting system for both incandescent, LED, or moving lights.
- Flexible loading – when the lighting plot is consistently hanging due to performance needs allowing for “mixed” circuiting between dimmed or relay controlled circuit.
- When using a hybrid lighting plot of traditional fixed and moving lights or LED luminaires that need a relay controlled straight power circuit.
- Any application that utilizes both standard forward phase dimming and contact relay straight power.
- Two year limited warranty.

Power controls: Wallrack Dimming Panels

Designed for the 230/240V markets, Philips Strand Wallrack digital dimming panels define the new standard in permanent installation dimming for small/medium entertainment and architectural venues, the Wallrack digital dimming panels are available in three sizes. Wallrack digital dimming panels are convection cooled (no fans) and yet extremely compact – great for distributed dimming schemes or just to get a lot of dimmers into a small space!

All versions of the Wallrack digital dimming panel are provided with plug-in control processors – stylish, easy to use, and very easy to maintain. Wallrack digital dimming panels have dual DMX512 inputs, so you can use a Philips Strand lighting console on one input and a DMX architectural control network on the other.

Wallrack digital dimming panels offer a simple panic feature too, for connection to emergency systems, or just for cleaners' lights. All Wallrack digital dimming panels may be upgraded to earth-leakage protection at installation, using standard 4-pole RCDs.

Use two 4-pole 60 Amp DIN rail mounting RCD, with DC pulse rating to upgrade the 24 x 2.5kW Wallrack digital dimming panel at time of installation.



Product specification

	Overall dimensions H x W x D	Order Code
Wallrack Dimming Panel, 24 x 2.5kW 230V	870 x 549 x 164mm	75356
Wallrack Dimming Panel, 6 x 2.5kW 230V	507 x 351 x 158mm	75357

Features

- Available in 24 x 2.5kW and 6 x 2.5kW configurations.
- 220-240VAC, 3-phase/single phase operation.
- MCB (SPN) protection for each channel.
- Field-upgradeable to RCD protection.
- Easy installation/compact size.
- Convection cooled – no fans.
- Substantially overrated power devices.
- Dual DMX512-A input, DMX512-A patch and DMX512-A output.
- Powerful patch, with user-selectable curves and non-dims.
- 8 remote pre-set closures and panic input.
- Up to 6 analogue outputs for external fluorescent or contactor operation.
- Plug-in control electronics for easy maintenance.
- Ample cable space for top or bottom entry.
- Simple and intuitive software configuration.
- LED indicators for 3 phases, DMX A and B, and over-temperature.
- Integral power supply for up to eight Accent DMX architectural control stations.
- Two year limited warranty.

Suggested uses:



For more information visit philips.com/strandlighting

Power controls: Relayrack

The Relayrack relay panel is a simple to install, program and use 12-channel relay panel. Each channel is rated for 220~240VAC, 2kW / 10 Amp output (single or 3-phase star) and is the perfect solution for any space or where reliable circuit switching is required.

The Relayrack relay panel is controlled either by RDM (E1.20-2006), DMX512, or Vision.net protocols making it adaptable to small or large-scale systems.



Product specification

	Overall dimensions H x W x D	Weight	Order Code
Relayrack Relay Panel, 12 channel	475 x 332 x 137mm	9.4kg	76412

Features

- 12-channel relay panel.
- Supports RDM (E1.20-2006), DMX512-A, and Vision.net control protocols.
- Local control for each channel located on the panel for easy setup and installation.
- Single panic input for fire alarms.
- Separate DMX512-A addressing for each channel.
- 10 Amps output on each circuit for resistive loads (8 Amps per circuit for inductive loads) in single or 3-phase.
- 2 line, 8 character LCD display to view current operational status and channel states.
- Over-current protection – 10 Amp circuit breaker for each channel.
- Maximum power – 120 Amps at 230VAC single phase or 40 Amps per phase in 3-phase applications.
- Two year limited warranty.

Suggested uses:



For more information visit philips.com/strandlighting

Power controls: eS21 Dimmer Strips

The eS21 Dimmer Strips are a range of portable dimmers that can be mixed and matched as needed to create a completely flexible lighting system to meet the needs of any installation. The dimmer strips feature quiet convection cooled IGBT dimming for low lamp noise and reliable operation. These modular raceways are assembled to order with a choice of any combination of 3 power modules.

The IGBT dimmer module features an Insulated Gate Bipolar Transistor power device that works in tandem with a dedicated microprocessor to control almost any type of lighting load required. The relay module features two switched circuits each with a DMX output designed to power range of LED lighting luminaires and automated sources. Each relay can be individually controlled to “Power down” the lighting rig when it is not in use.

The eS21 dimmer strips are ideal for smaller systems and may be used in any facility or situation that does not have space for conventional dimmer racks, or where relayed and constant power is required. eS21 dimmer strips are easy to install and can be fed from standard breaker panels.

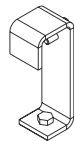

Hook clamp

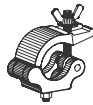

Cheeseboro clamp

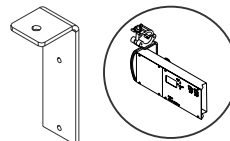

Pipe mount bracket

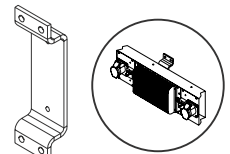

Wall mount bracket

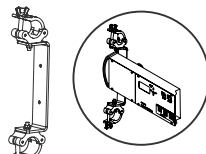

Dual clamp mount hanging bracket

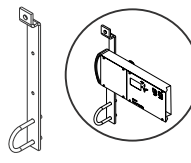

Single pipe mount hanging bracket

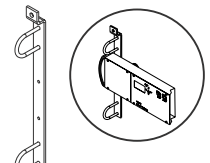

Double pipe mount hanging bracket

Features

- Fully digital dimmer strip with forward / reverse phase dimming (automatic or user-selectable) and mains input breaker.
- Compatible with new LED luminaires that require reverse phase operation.
- DMX512 I/O.
- Quiet convection cooled dual IGBT dimmers.
- No dimmer room required and no added cooling needed.
- Energy efficient – only a 2.5 volt insertion loss.
- Dimmer strip features 6 dimmers packaged in three dual modules.
- Solid-state dimming technology with adjustable transition (rise) time up to 650ms for quiet operation.
- Low Harm™ mode to reduce neutral harmonics.
- Automatic overload short circuit protection.
- Local focus buttons and LED status indicators.
- Simple set-up with back lit LCD display and easy button access. LCD blacks out when not in use.
- Choice of 3 power input locations - top, bottom and back.
- Wide range of load connector options.
- Available with RCBO load protection on CEE17 connector model.
- Compact size for easy installation.
- Integrates with Strand EC21 dimmers.
- Hangers available for wall and pipe mount applications.
- Two year limited warranty.

Suggested uses:



For more information visit philips.com/strandlighting

Power controls: eS21 Dimmer Strips

eS21 Dimmer Strips, 230/240 Volt

Type	Order Code
3, dual 2.5kW (max.) dimmer modules, 650ms transition time, eS21 Dimmer Strip with with powerCON connectors and main breaker (no load breakers)	71600
3, dual 2.5kW (max.) dimmer modules, 650ms transition time, eS21 Dimmer Strip with CEE17 connectors and main breaker (with RCD load breakers)	71601
3, dual 2.5kW (max.) dimmer modules, 650ms transition time, eS21 Dimmer Strip with CEE17 connectors and main breaker (no load breakers)	71602

NOTE: Each eS21 IGBT dual module contains two dimmers and is fully rated at 2.5kW per module.
 The 2.5kW rating of the module may be split evenly across both dimmers at 1.25kW,
 used on a single dimmer at 2.5kW, or any combination of loads on either dimmer that does not exceed
 2.5kw per module.
 eS21 Dimmer Strips do not include input power cables.

To build your custom eS21 Dimmer Strip choose any combination of module options below for each module position and Strand Lighting will construct the eS21 Dimmer Strip to your specification.

Example configuration:

eS21 LED Raceway product number: 71900 - DB-RC-DB

This configuration has two Dual 2.5kW dimmer modules with CEE17 connectors and one relay module for switched power luminaires and DMX.

eS21 Dimmer Strip

Type	Order Code	Add suffix
	71900	
Module 1		-XX
Module 2		-YY
Module 3		-ZZ

eS21 Dimmer Strip module options

	Order Code
Dual 1.2kW dimmer module with CEE17 connectors	DA
Dual 2.5kW dimmer module with CEE17 connectors	DB
Single 5.0kW dimmer module with CEE17 connectors	DC
Relay module with CEE17 output connectors	RC
Relay module with powerCON output connectors	RD
Blank panel – no power, no connectors	BP

NOTE: eS21 Dimmer Strip do not include input power cables.

Accessories – clamps / mounting / hangers

Hook clamp	71729
Cheeseboro clamp	71351
Pipe mount bracket (for use with Cheeseboro or Hook clamps - metric)	71726
Dual clamp mount hanging bracket (for use with Cheeseboro or Pipe clamps)	71510
Wall mount bracket (metric)	71728
Single pipe mount hanging bracket	71732
Double pipe mount hanging bracket	71733
DMX terminator	71346

Spare modules

Spare 230V / 240V dimmer module	71700
Spare processor / LCD display unit	71701

Power controls: SD6 Dimmer Pack

Specifically designed for 230 / 240 volt dimming markets, the Philips Strand SD6 digital dimmer pack offers user-friendly controls in a portable, rack mount package.

The SD6 digital dimmer pack contains six 13 Amp (2.5kW) 230 / 240 volt dimmers. Each dimmer can be configured directly from the unit's on-board LCD menu for dimming or non-dim operation, minimum / maximum output levels, dimming curves, and more.



Product specification

Type	Overall dimensions W x H x D	Weight	Order Code
SD6 Digital Dimmer Pack, 6 x 13A (2.5kW) 230/240VAC, terminal strip	483 x 88 x 395mm	12kg	75400

Accessories

	Order Code
SD6 back panel with 6 x 15A sockets	75411
SD6 back panel with 6 x Schuko sockets	75412
SD6 back panel with 6 x CEE 17 sockets	75413

Features

- Six 13 Amp (2.5kW) dimmers for 230/240 volt operation.
- Main circuit breaker for each dimmer.
- Designed for single or three-phase supplies.
- Fully digital control electronics.
- DMX512-A in/out.
- Simple set-up using front panel keypad and LCD display.
- 24 back-up cues with backup link to connect multiple dimmer packs.
- Chase and scene pattern library for standalone operation.
- Individual settings for minimum / maximum output levels for each dimmer.
- Individual dimming curve selection for each dimmer.
- DMX512-A addressing with individual patching for all dimmers.
- Two year limited warranty.

Suggested uses:



For more information visit philips.com/strandlighting

Power controls: LightPack

Philips Strand LightPack LED Controller delivers power and control to Philips Color Kinetics Color Blast wash lights.

Smart addressing technology simplifies set-up and allows users to quickly address any luminaire regardless of type. Users set an address, select an operating mode and press a button to set up any connected luminaire. Each output is configured to match the luminaire regardless of the number of colors the unit supports and delivers exactly the right number of control channels needed. An intensity channel set up option is also available to make your luminaires even easier to use and program.

Ideal for a wide range of applications from special events to theaters and television studios the LightPack LED Controller delivers power and control anywhere you need it.

With the LightPack portable IGBT dimmers you can have our most advanced IGBT dimming technology in the palm of your hand. The new 750 watt and 1200 watt LightPack individual dimmers provide the ultimate in control flexibility, allowing you to have a dimmer right at your light source wherever and whenever you need it.

Quiet and reliable, the LightPack features easy to use DMX512-A addressing and DMX in / out connectivity. All LightPacks are convection cooled and very quiet so they can be placed anywhere. A wide range of hangers makes mounting your LightPack a snap.



Product specification

	Overall dimensions H x W x D	Weight	Order Code
LightPack LED Controller, bare leads, 230V	83 x 106 x 244mm	1.90kg	71364
LightPack Dimmer, 750W 800µs, bare leads	173 x 114 x 74mm	0.91kg	71320
LightPack Dimmer, 1200W 800µs, bare leads	173 x 114 x 81mm	1.02kg	71321

Accessories

	Order Code
LightPack LED controller C-clamp	SC
LightPack LED controller Cheeseboro clamp	71351
LightPack dimmer yoke mount bracket	71340
LightPack dimmer wall mount bracket	71341
LightPack dimmer pipe mount bracket	71342
LightPack dimmer pipe clamp	USCLAMP
LightPack dimmer network coupler, 5-pin turn F to F turnaround	71345
DMX512-A terminator	71346

Features – LightPack LED Controller

- Simple, intuitive user interface.
- DMX input or local on / off / color select button.
- Status indicators.
- Two addressable outputs with tool free set up.
- Auto luminaire ID.
- DMX512-A in / out (thru).
- Universal operating voltage, 100 to 240 VAC.
- 8 or 16-bit operating modes allows users to choose fade resolution by luminaire.
- Intensity channel selection can add an intensity channel to any luminaire.
- Support for tunable white, RGB and RGBAW luminaires.
- Includes wall mount and pipe mount brackets (C-clamp sold separately).
- Rugged enclosure with integrated heat sinks for silent fan free operation.
- Integrated safety cable.
- Two year limited warranty.

Features – LightPack Dimmer

- Quiet IGBT dimming technology – user-selectable dimming or non-dim modes.
- Less than 1.5V insertion loss.
- 750W or 1200W dimmers for 230V applications.
- Fully short-circuit, thermal and overload protection.
- DMX512-A in / out.
- Local control for easy set-up.
- 450µs or 800µs transition time (user selectable).
- Forward or reverse phase operation – rated to control any dimmable load such as incandescent, fluorescent, or general inductive (FPC only).
- Integrates with all Strand dimming systems.
- Nine built-in, preprogrammed dimmer effects – bounce up, bounce down, bump, sawtooth, blink on, blink off, strobe, flame flicker and bell curve.
- Optional wall, yoke, and pipe mounts (all mounts are sold separately).
- Two year limited warranty.

Suggested uses:



For more information visit philips.com/strandlighting

Power controls: Dim 1

The Philips Strand Dim 1 is a single channel portable dimmer, rated at 10 Amps (2.3kW) and is perfect for rental, small drama spaces, or anywhere where accurate and adaptable dimming is needed.

This DMX512-A controlled, convection cooled (no fans) dimmer comes with an external remote fader as well as an on-board external HTP slider, allowing users to manipulate the output of the attached fixture either separately or in conjunction with a larger system.



Product specification

Type	Overall dimensions W x H x D	Weight	Order Code
Dim 1 10 Amp dimmer (UK 15A connector)	93 x 185 x 80mm	1.3kg	75821
Dim 1 10 Amp Dimmer (Schuko connector)	93 x 185 x 80mm	1.3kg	76574

Note: All Dim 1 dimmers include external remote slider fader.

Features

- Wide range of socket options including UK 15A, Schuko, and Australian.
- Suitable for portable or wall mount operations
- On-board and external HTP (Highest Takes Precedence) slider.
- External remote supplied with single fader.
- DMX512-A in / out.
- Digital DMX512-A addressing.
- Capacity to set a dimmer pre-set value.
- Fan free convection cooling for quiet operation.
- Ability to select a maximum dimmer level.
- Simple setup through the LED display.
- Maximum power - 10 Amps / 2300 Watts.
- Two year limited warranty.

Suggested uses:



For more information visit philips.com/strandlighting

Power controls: SD-DRIVE 1, SD-DRIVE 3 & SD-DRIVE 4

The Philips Showline SD-DRIVE 1, SD-Drive 3 and SD-Drive 4 are single, three and four channel dimmers respectively. Available in DMX control mode, manual mode. DMX address can be addressed by flipping the dip-switches.

A maximum 6 Amps are allowed.



Product specification

	Overall dimensions H x W x D	Weight	Order Code
SD-DRIVE 1 single channel	20 x 90 x 40mm	0.15kg	88-095-0200-00
SD-DRIVE 3 three channels	23 x 115 x 54mm	0.65kg	88-095-2170-00
SD-DRIVE 4 four channels	23 x 115 x 54mm	1.00kg	88-095-2040-00

Features

- DMX controlled.
- LED drivers in three versions: single channel, three channel and four channel.
- Up to 6A output capacity.
- Start-DMX address setting.
- DMX control mode or manual mode.
- 12-24V input power supply not provided.
- Two year limited warranty.

Suggested uses:



For further information visit philips.com/showline

NEO Consoles control new LED illumination at Niagara Falls

On December 1, 2016, the Niagara Falls Illumination Board debuted the new energy efficient LED illumination of the Falls controlled by two Philips Strand Lighting NEO lighting control consoles. These new lights provide more than twice the previous lighting levels, a wider spectrum of color and allowed for programmable lighting through the flexible NEO system.

Lighting effects such as sunrise, sunset and the Aurora Borealis can be easily displayed on the Falls nightly using the NEO Consoles. The new lights also provide a more consistent lighting effect on both sides of the Falls.

Comprised of several prominent lighting and construction industry leaders, the team represents local, Canadian and American companies on this international endeavor.

While the NEO Consoles provide the dynamic fade engine for the Falls, the triggering is done by touchscreen interfaces build from NEO's Mobile Interface Builder. This is the new user configurable interface that triggers any available NEO command

and became available on NEO software version 3.7. These Mobile Interface Builder files live on 2 separate PCs that each have a 22inch touchscreen monitor. Activating any button or slider on the touchscreen in turn will activate the appropriate command on the NEO Playback Controller. The touchscreens are run by volunteer operators so they had to be simple to use. There is even a touchscreen layout that the operators make available to public tours so that the public can trigger colors on the Falls themselves. There is one touchscreen for the American Falls and one for the Canadian Falls so they can be triggered separately from different cue lists on the NEO.

Niagara Falls

Photography: Bobby Harrell



AMERICAS

Philips Entertainment U.S.
10911 Petal Street
Dallas, TX 75235
Tel: +1 214647 7880
Fax: +1 214647 8039

ASIA

Philips Entertainment Lighting Asia Limited
Unit C, 14/F, Roxy Industry Centre
No. 41 - 49 Kwai Cheong Road
Kwai Chung, N.T. Hong Kong
Tel: +852 27969786
Fax: +852 27986546

BEIJING

Room 1201, Free Town D Tower,
58 South 3rd Ring Road East
Chaoyang District
Beijing, China
Tel: +8610-58674776
Fax: +8610-58674775

MALAYSIA

B-1-27, Dataran Cascades, No. 13A,
Jalan PJU 5/I, Kota Damansara,
47810 Petaling Jaya, Selangor Darul Ehsan, Malaysia
Tel: +603 7611-7302
Fax: +603-76294192

AUSTRALIA and NEW ZEALAND

Philips Entertainment New Zealand
14H Vega Place, Rosedale
Auckland 0632, New Zealand
Tel: +64 9475 0031

EUROPE

Philips Entertainment Group Europe
Rondweg Zuid 85
Winterswijk 7102 JD Netherlands
Tel: +31 543-542343
Fax: +31 53 4500425

UNITED KINGDOM

Philips Entertainment Group Europe
Unit 24, Sovereign Park
Coronation Road, Park Royal
London
NW10 7QP

