

**PHILIPS**

Urban lighting

Heritage range



# Heritage range

In the heart of the city



# In the heart of the city

Cities are often challenged with the desire to move toward the future, while still preserving the past. As many cities around the globe transform into new and more modern ways of living, maintaining a city's original charm is important to citizens and tourists alike. While Philips Lighting is constantly striving to innovate new and future-proof technologies, we understand the significance of paying homage to a city's history. Street lighting solutions from Philips Lighting marry old and new, combining intelligent LED technology, with historic and charismatic luminaires. With Philips Lighting heritage range luminaires, city streets are current and stylish, with a traditional nod to the past. Our luminaires are a natural fit for city centers and produce day and night-time ambiances that are both distinctive and warm. Our heritage lighting solutions contribute to enhancing well-being and making cities more livable.

“

Beautify historical city centers, villages as well as residential areas at day and nighttime”



A young man and woman are embracing on a city street. The man is wearing a blue sweater and has his arm around the woman's shoulder. The woman is wearing a white sweater. They are standing behind a low, mossy stone wall. In the background, there are buildings, trees, and a street lamp. The scene is bathed in warm, golden light, suggesting late afternoon or early morning.

“Creation of  
distinctive and  
warm ambiences”

# Historic lanterns and contemporary reinterpretation

At Philips Lighting, we understand that different cities have different needs. Some may want to remain traditional, while others may want to become contemporary.

For this reason, we offer three different architectural styles within our heritage range: heritage, classic, and modern. Each elicit a different emotion for its city's streets. Heritage focuses on tradition, luminaires are timeless, and represent a city's history.

The classic style combines elegance and style, creating a warm and inviting feel for all citizens and tourists to enjoy. Finally, our modern styles are perfect for cities that are looking to break the mold. They are compatible with historically important architecture, but provide a fresher, up-to-date look. Regardless of your city's needs, Philips Lighting heritage range luminaires have something for every taste.



CityTouch Ready luminaire



LED retrofit kit available



Jargeau 400 LED  
P 12



Villa LED  
P 14



□ Heritage

# “Addressing different architectural contexts”



Classic

Modern

# “Heritage

Lighting solutions that  
enhance our heritage”





Evoking a certain period,  
culture and style



# “Classic

Combining Classic design with modern technology”







ClassicStreet

Harmony Classic LED



Micenas LED

Creation of distinctive,  
elegant and warm  
ambiences

# “Modern

The luminaires’ styling is not only suitable for historical and traditional architectural settings, but feels equally at home in more modern urban environments”





Reinventing future with  
prints of the history



ClassicStreet





# Villa LED

## Traditional Iberian four-sided luminaires

Villa LED retains the specific proportions and shape of the traditional four-sided luminaires originally used in 19<sup>th</sup> century Madrid (Kenneth Gilbert). Villa LED allows a remarkable balance between performance and heritage preservation. A luminaire which is now widely used in cities and villages across the Iberian Peninsula, Villa LED is suitable for lighting historical environments and traditional villages. Villa LED can also enable the benefits of the latest technologies developed by Philips Lighting, including CityTouch connected lighting system.



# Jargeau 400 LED

## The european archetypal four sided street luminaire

Jargeau 400 LED combines the symbolic features of the first four-sided street lamps of the 19th century with the technical performance of 21st century luminaires. For heights of 4-6 meters, this luminaire is well-suited to urban landscapes and ideal for illuminating city centers, historical areas, old villages, streets, alleys, squares and parks. Jargeau 400 LED can also enable the benefits of the latest technologies developed by Philips Lighting, including CityTouch connected lighting system.



“Iconic design for a perfect integration in emblematic city areas”









# Micenas LED

## Contemporary aesthetics and classical inspiration

Combining contemporary aesthetics and classical inspiration, Micenas fits elegantly in both city centres and areas where varied urban identities exist. Micenas benefits from the latest technologies developed by Philips Lighting, including CityTouch technology. Recommended for mounting heights of 4 - 6 meters, this eco-designed luminaire provides comfortable ambience lighting to urban roads, pedestrian and shopping areas, historic centres, residential areas, newly developed areas, parks and promenades. Micenas LED can also enable the benefits of the latest technologies developed by Philips Lighting, including CityTouch connected lighting system.





# Harmony Classic LED

## A timeless classic luminaire

Harmony Classic draws its inspiration from the street lamps of the early 20<sup>th</sup> century, which combined a conical bowl with a suspended canopy. Harmony Classic LED provides versatility, both in terms of supporting brackets and poles as accessories. Designed for heights of 4-8 meters, it's ideal for lighting village and city centers, urban main roads, side roads, pedestrian areas and squares.

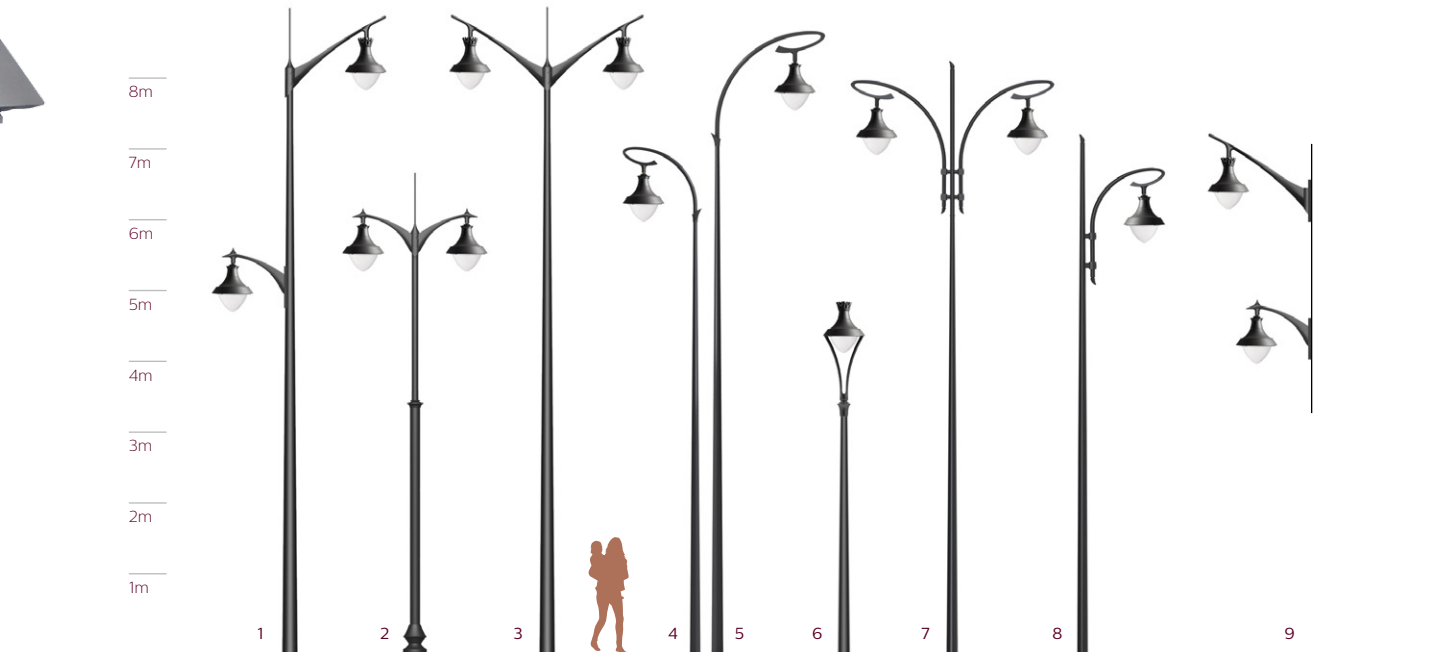

“Modern re-interpretation  
of the suspended  
luminaire archetype”







# ClassicStreet

Echoing the past, shaping the future

ClassicStreet combines elegant design with the subtle details of heritage luminaires while meeting today's functional public lighting requirements. Though it echoes the past, our ClassicStreet luminaire is very much shaped for the future. Its gently curved design, together with dedicated brackets and poles, creates a contemporary look that beautifies cities and creates distinctive and warm night and daytime ambiances. It's appropriate for both historical and traditional architectural settings, and more modern, urban environments. Designed around its LED engine, ClassicStreet delivers outstanding levels of lighting and energy performance.

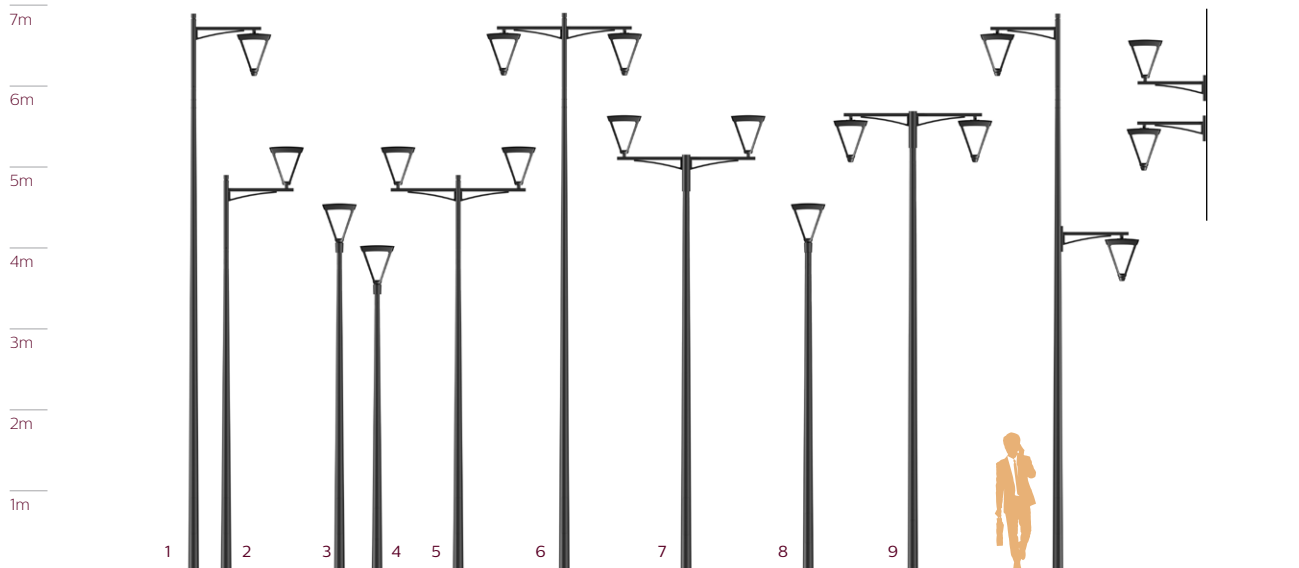



# Heritage LED retrofit kit\*



Future-proof and energy-efficient LED alternative for upgrading your traditional luminaire

Ideal for switching from conventional luminaires or first LED generations to a highly efficient LED solution, our heritage LED retrofit kit is based on a simple idea: use the latest LED technology while preserving the original form of the lighting.

#### **Future - proof solution**

Designed to last over time and able to accommodate technological change

#### **Energy efficient luminaire**

Benefit from energy savings of an estimated 40 - 60% compared to old conventional luminaires

#### **Increased lifetime**

Reduced maintenance costs thanks to a longer lifetime - up to 100,000 hours

#### **Easy to install**

On site, the simple construction allows quick installation (under 10 minutes) in an existing luminaire

\* Available for Villa, Micenas luminaire.

For Jargeau 400 please contact your sales representative.

# Customized heritage LED retrofit kit

Philips Lighting offers the skills of its Special department dedicated to developing customized. Its missions revolve around the complete management of your requests specific, providing on request solutions helping the city to stay at the leading edge of the technology and deliver innovative solutions.

For more information please contact your local sales representative.



Standard retrofit kit solution



Customized retrofit kit solution

# Light in control

Lighting city streets, roads and public spaces presents many challenges. Due to traffic density and different traffic levels, the dynamics of city life change constantly.

To respond to those changes and make the city feel safe, attractive and inviting, you need the right levels of lighting. But urban planners are also under pressure to reduce energy costs and maximize the city's green credentials. Philips Lighting offers you a complete intelligent lighting controls range that helps you overcome all those problems and makes the city more livable and sustainable.

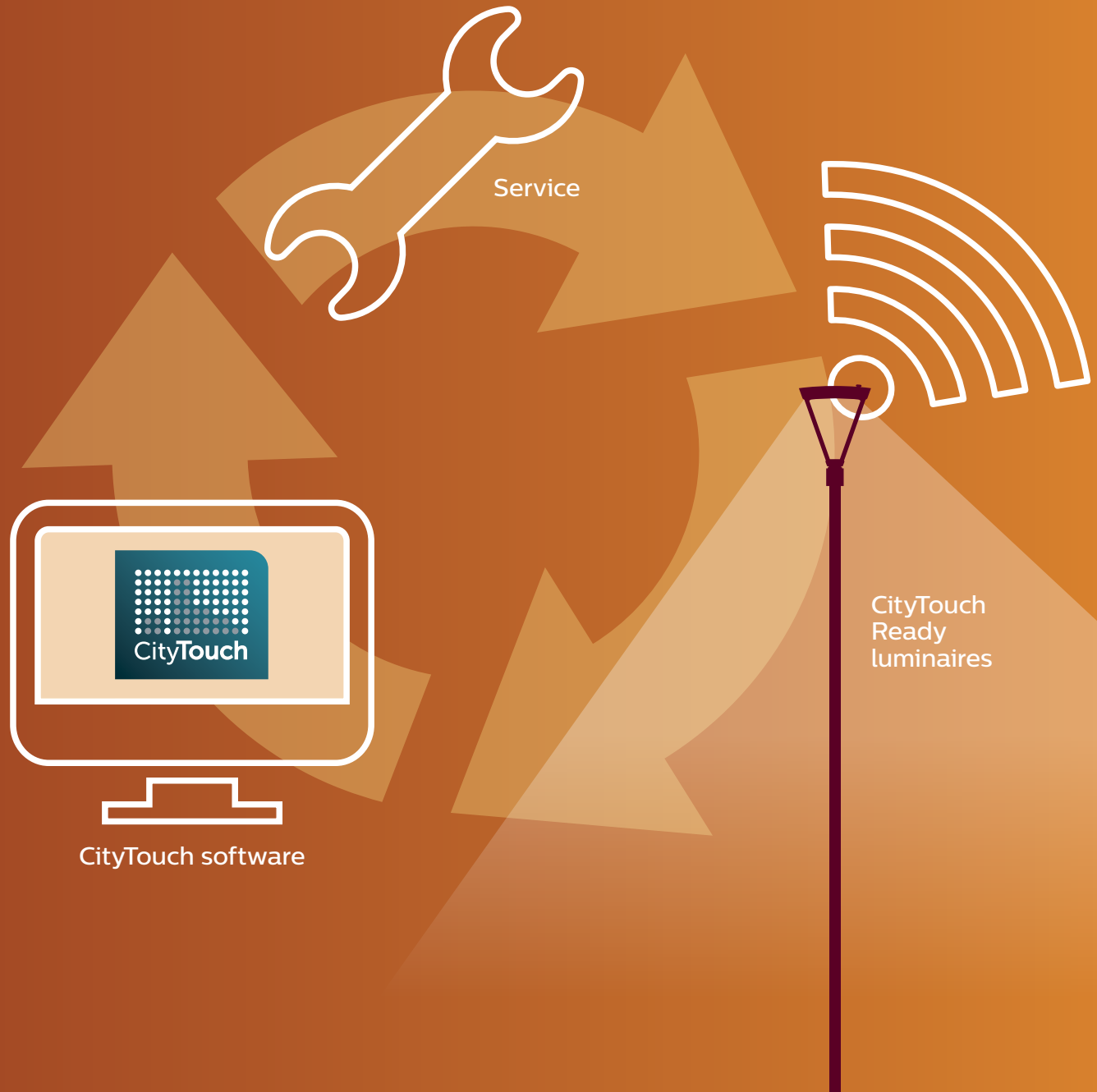



# Connected Lighting

## CityTouch Ready luminaires

The classic range can be seamlessly connected to CityTouch software via CityTouch connect app (remote management), with all the intelligence being integrated into the luminaire without the need for any additional hardware. Communication runs directly via the public mobile network. An additional advantage is that you are not required to perform any maintenance. Furthermore, the entire connectivity management is covered by the service we provide, ensuring there is no hassle for you, the customer. Once connected to the power supply, a light point automatically appears on the CityTouch map at the right location – with all the relevant technical parameters imported into the system.

CityTouch connect app is an intelligent, interactive remote management solution for street lighting. It brings your city lighting to life and offers you flexibility, information and accuracy. The system's flexibility enables you to respond easily to expected and unexpected situations by dimming or brightening any of the areas within your city to ensure safety and well-being. Information keeps you up to date on the current status of every single luminaire, facilitating more effective maintenance and faster repairs. And accurate energy metering gives you a precise overview of actual energy consumption.



## CityTouch connect app key features

### Control of each individual light point

You have the flexibility to adjust every single luminaire to changing situations or requirements at any time. You can adjust calendars to suit your individual needs simply by changing the switching points of each dimming profile via drag and drop.

### Fault detection and notification

Faster and better provision of information about the current status of the lighting infrastructure enables you to address maintenance issues more quickly and to improve the maintenance service level.

### Accurate energy metering

Accurate energy metering for each individual luminaire enables you to monitor your energy bills and to identify potential new savings.

# Heritage brackets and contemporary re-interpretations

Combining different brackets and luminaires, you will have a toolbox to create your own stylish installation. Whether it is an urban area full of history, or one more contemporary, you can design your environment how you see fit.

From simple to more sophisticated shapes, curves and curls, our bracket collection offers a wide range of designs that will echo your environment, amplifying the feeling of its atmosphere.



Beaugency / Wy / Ourcelles / Tradition  
P 28



## Heritage

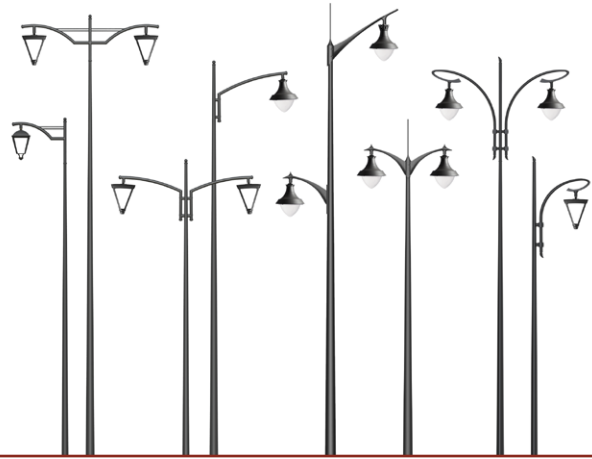

Reverbere / Aurore / Notre-Dame / Solis  
P 30

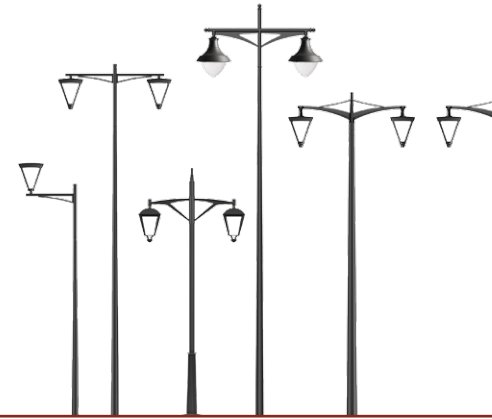

Faro / Century / Kastle / ClassicStreet  
P 32

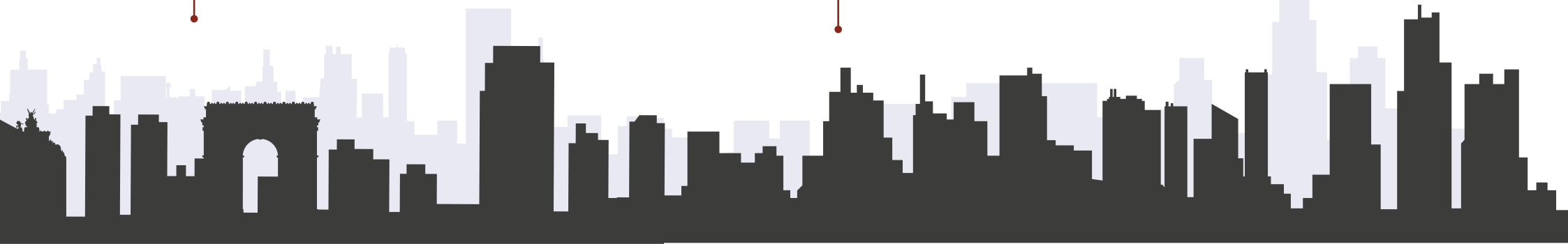

Classic

Modern

# Heritage brackets

Particularly adapted for historical city centers and picturesque villages, the traditional shapes of these heritage brackets inspire the values of the past



Wy



## Wy

Combining straight lines and curls, Wy can be associated with luminaires like Jargeau or Mienas, and fit perfectly in places full of history. It is available in several bracket lengths, single arm, double arm and rear arm bracket, as well as wall mounting bracket.

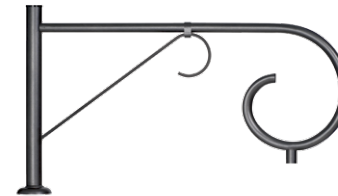

## Beaugency

With its straight lines and curvature ending Beaugency is quite adaptative to several environments. It is available in several bracket lengths, single arm, double arm and rear arm bracket, as well as wall mounting bracket.

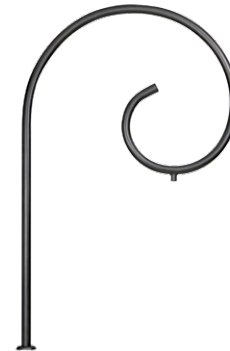

## Ourcelles

The authentic Ourcelles draws charming curls in the streets and avenues while respecting the historical environment. It is available in several bracket lengths, single arm, double arm and rear arm bracket, as well as wall mounting bracket.



## Tradition

Tradition bracket is one of the typical shapes of historical light points. Its design echoes perfectly these environments where the past still has a strong footprint. It is available in several bracket lengths, single arm, double arm and rear arm bracket, as well as wall mounting bracket.



Ourcelles



Tradition

Beaugency

Curves and curls respecting historical environments



# Classic brackets

The timeless appearance of the classic brackets enables them to fit in many architectural context depending on their associations with luminaires

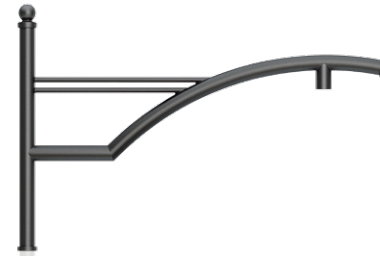

## Reverbere

The reassuring design of Reverbere will connect very well with urban and rural landscapes. The presence of the complete sets will be completed with the luminaire to adapt to each place. It is available in several bracket lengths, single arm, double arm and rear arm bracket, as well as wall mounting bracket.



## Aurore

The Aurore bracket fit with harmony in different environments, from city centers to authentic residential areas. It is available in several bracket lengths, single arm, double arm and rear arm bracket, as well as wall mounting bracket.



## Notre-Dame

Notre-Dame has typically been designed along with Harmony classic luminaire, the first one highlighting the shapes of the second one. It will fit with other luminaires to create different styles and ambiances. It is available in several bracket lengths, single arm, double arm and rear arm bracket, as well as wall mounting bracket.



## Solis

Contemporary re-interpretation of one of the typical shapes of heritage brackets, Solis has an elegant and timeless design that will enhance places and streets full of history. It is available in two bracket lengths, single arm, double arm and rear arm bracket, as well as wall mounting bracket.



Timeless solutions  
between modern and  
heritage lighting



# Modern brackets

The contemporary re-interpretation of heritage brackets fit in modern as well as classical urban landscapes



## Faro bracket & pole

The Faro range is our modern re-interpretation of heritage style total light points, from the pavement, up to the luminaire. The picturesque, yet simple design will respect both modern and classical environments. The Faro bracket is available in several bracket lengths, for pole mounting bracket, and wall mounting bracket.

The Faro poles are available in several pole heights. Faro top pole is meant to be used with one luminaire in post top situations, whereas the Faro applique pole will be completed with one or several Faro brackets.

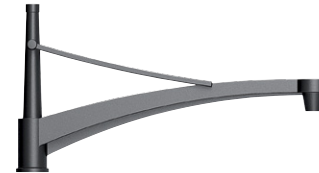

## Century

Century reboots with a real touch of modern, some of the typical heritage bracket designs. It is available in several bracket lengths, single arm, double arm and rear arm bracket, as well as wall mounting bracket.



## Kastelle

With its ball-shaped end caps, Kastelle proposes a stylish touch to underlign the architectural background where it is installed. It is available in several bracket lengths, single arm, double arm and rear arm bracket, as well as wall mounting bracket.



## ClassicStreet

ClassicStreet bracket has been designed along with the ClassicStreet luminaire to propose a dedicated aerial and light complete set range. The dedicated interface enables perfect design integration with the luminaire, whether it is in post top or suspended situations. It is available in one bracket length, single arm, double arm and rear arm bracket, as well as wall mounting bracket.





ClassicStreet

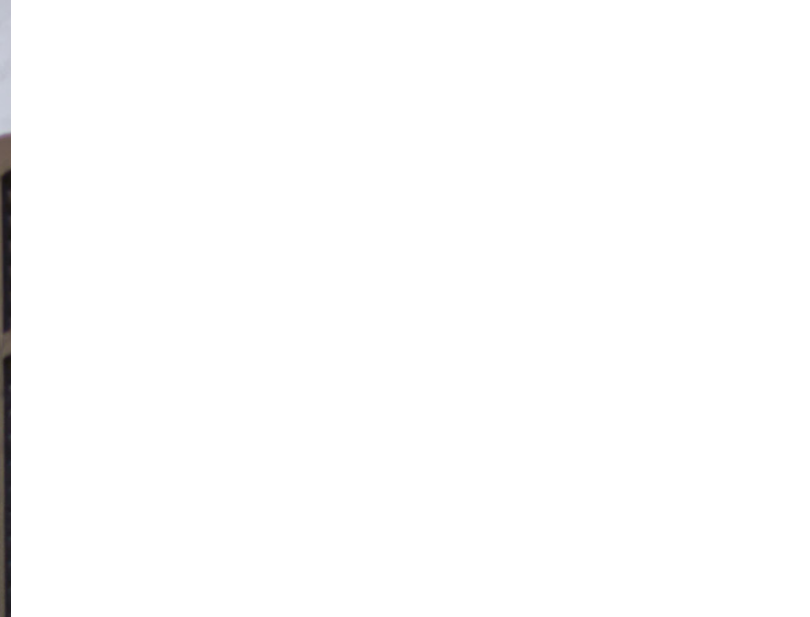

Kastelle



A contemporary design  
that respects architectural  
environments from the past



Faro bracket and pole

# Luminaire specifications

## Villa LED

<b>Type</b>	BDP765 (post-top version) BSP765 (suspended version)
<b>Correlated Color Temperature</b>	3,000 K (warm white) 4,000 K (neutral white)
<b>Color Rendering Index</b>	80 (warm white) - 70 (neutral white)
<b>Luminous flux</b>	500 - 6800 (warm white), 500 - 7700 (neutral white) depending on configuration
<b>Power</b>	9W - 79W (warm white), 9W - 69W (neutral white) depending on configuration
<b>Luminaire efficacy</b>	Up to 122 lm/W
<b>Lifetime (Maintenance of Lumen Output L80B10)</b>	Up to or > 100 000 hours
<b>Optic</b>	Distribution Medium (DM,DN), Pedestrian Crossing, Symmetrical, Wide & extra Wide, Louver
<b>Optical cover</b>	Polycarbonate bowl, clear or opal - tempered flat glass, clear or frosted
<b>Warranty</b>	Silver 5 years
<b>Installation</b>	Post top: 60 and 76mm spigot, solid & open frog Suspended 3/4 or 1'G
<b>CLO</b>	Available
<b>Control systems Input</b>	DALI CityTouch Ready (only for post top version)
<b>Intelligence Control</b>	LumiStep (LS), DynaDimmer (DDF), LineSwitch (D11), Starsense RF Wireless and CityTouch Ready, Photocell, MiniCell (35, 55, 75 lux),
<b>Driver</b>	Philips Xitanium Driver
<b>Operating temperature range</b>	-20 °C < Ta < 35 °C
<b>Mains voltage</b>	220-240 V / 50-60 Hz
<b>Electrical class</b>	Class I and Class II
<b>Color</b>	Black N9 (MN332L) Other RAL and AKZO Futura colors available on request
<b>IP rating</b>	IP44 (luminaire) - IP66 (glass)
<b>IK rating</b>	IK09 clear flat glass
<b>Surge protection</b>	6 kV (standard) - 10 kV (optional)
<b>Certification</b>	CE - ENEC

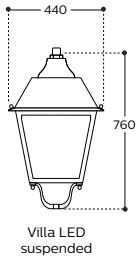
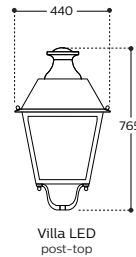

## Jargeau 400 LED

<b>Type</b>	BPP641 (post-top version) BSP641 (suspended version)
<b>Correlated Color Temperature</b>	3,000 K (warm white) 4,000 K (neutral white)
<b>Color Rendering Index</b>	80 (warm white) 70 (neutral white)
<b>Luminous flux</b>	1000 - 7100 (warm white & neutral white) depending on configuration
<b>Power</b>	14W - 75W ( warm white & neutral white) depending on configuration
<b>Luminaire efficacy</b>	Up to 117 lm/W
<b>Lifetime (Maintenance of Lumen Output L80B10)</b>	Up to 100,000 hours
<b>Optic</b>	OFR2 Optiflux narrow for ME-class, OFR4 Optiflux Narrow for S-class, OFR6 Optiflux very Wide for S-Class, OFR7 Optiflux Narrow for S-Class, DS Distribution Symmetrical
<b>Optical cover</b>	Polycarbonate bowl, clear or opal - tempered flat glass, clear or frosted
<b>Warranty</b>	Bronze 3 years
<b>Installation</b>	Post top: 60 and 76mm spigot, solid & open frog Suspended 3/4 or 1'G
<b>CLO</b>	Available
<b>Control systems Input</b>	DALI CityTouch Ready (only for Post-Top version)
<b>Intelligence Control</b>	LumiStep (LS), DynaDimmer (DDF), LineSwitch (D11), Starsense RF Wireless and CityTouch Ready, Photocell, MiniCell (35, 55, 75 lux),
<b>Driver</b>	Philips Xitanium Driver
<b>Operating temperature range</b>	-20 °C < Ta < 35 °C
<b>Mains voltage</b>	220-240 V / 50-60 Hz
<b>Electrical class</b>	Class I and Class II
<b>Color</b>	Black N9 (MN332L) Other RAL and AKZO Futura colors available on request
<b>IP rating</b>	IP65 (Bowl) - (Led Board IP66)
<b>IK rating</b>	IK09 clear flat glass IK10 clear polycarbonate bowl
<b>Surge protection</b>	6 kV (standard) - 10 kV (optional)
<b>Certification</b>	CE - ENEC - CEE eligible certificate on request

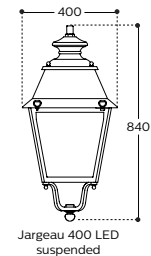
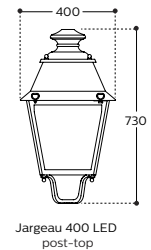

# Micenas gen2 LED

<b>Type</b>	BDP791 (post-top version) BSP791 (suspended version)
<b>Correlated Color Temperature</b>	3,000 K (warm white) 4,000 K (neutral white)
<b>Color Rendering Index</b>	80 (warm white) - 70 (neutral white)
<b>Luminous flux</b>	810 - 6280 (warm white), 890 - 7250 (neutral white) depending on configuration
<b>Power</b>	13W - 87W depending on LED configuration
<b>Luminaire efficacy</b>	Up to 98 lm/W
<b>Lifetime (Maintenance of Lumen Output L80B10)</b>	Up to 92,000 hours
<b>Optic</b>	OFR2 Optiflux narrow for ME-class, OFR4 Optiflux Narrow for S-class, OFR6 Optiflux very Wide for S-Class, OFR7 Optiflux Narrow for S-Class, DS Distribution Symmetrical
<b>Optical cover</b>	Tempered flat glass, clear or frosted
<b>Warranty</b>	Bronze 3 years
<b>Installation</b>	Post top: 60 and 76mm spigot, solid & open frog Suspended 3/4 or 1'G
<b>CLO</b>	Available
<b>Control systems Input</b>	DALI CityTouch Ready
<b>Intelligence Control</b>	LumiStep (LS), DynaDimmer (DDF), LineSwitch (D11), Starsense RF Wireless and CityTouch Ready, Photocell, MiniCell 35, 55, 75 lux),
<b>Driver</b>	Philips Xitanium Driver
<b>Operating temperature range</b>	-20 °C < Ta < 35 °C
<b>Mains voltage</b>	220-240 V / 50-60 Hz
<b>Electrical class</b>	Class I and Class II
<b>Color</b>	Black N9 (MN332L) Other RAL and AKZO Futura colors available on request
<b>IP rating</b>	IP44 - (Led Board IP66)
<b>IK rating</b>	IK09 clear flat glass
<b>Surge protection</b>	4 kV (standard) - 10 kV (optional)
<b>Certification</b>	CE - ENEC - CEE eligible certificate on request

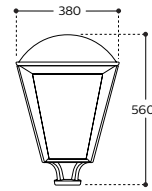

Micenas gen2 LED post-top

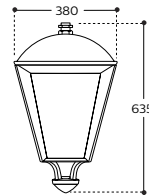

Micenas gen2 LED suspended

# Harmony Classic LED

<b>Type</b>	BDP670 (post-top version) BSP670 (suspended version)
<b>Correlated Color Temperature</b>	3,000 K (warm white) - 4,000 K (neutral white)
<b>Color Rendering Index</b>	80 (warm white) - 70 (neutral white)
<b>Luminous flux</b>	1170 - 6977 (warm white), 1383 - 8030 (neutral white) depending on LED configuration
<b>Power</b>	13W - 88W depending on LED configuration
<b>Luminaire efficacy</b>	up to 140 lm/W
<b>Lifetime (Maintenance of Lumen Output L80B10)</b>	up to 100 000 hours
<b>Optic</b>	OFR2 Optiflux Narrow for ME-class, OFR4 Optiflux narrow for S-class, OFR6 Optiflux very Wide for S-Class, OFR7 Optiflux Narrow for S-Class, DS Distribution Symmetrical
<b>Optical cover</b>	Polycarbonate bowl, clear
<b>Warranty</b>	Bronze 3 years
<b>Installation</b>	Top mounting with Lyre Suspended 1'G
<b>CLO</b>	Available
<b>Control systems Input</b>	DALI
<b>Intelligence Control</b>	LumiStep (LS), DynaDimmer (DDF), LineSwitch (D11), Starsense RF Wireless and CityTouch Ready, Photocell, MiniCell 35, 55, 75 lux),
<b>Driver</b>	Philips Xitanium Driver
<b>Operating temperature range</b>	-20 °C < Ta < 35 °C
<b>Mains voltage</b>	220-240 V / 50-60 Hz
<b>Electrical class</b>	Class I and Class II
<b>Color</b>	Gray Other RAL and AKZO Futura colors available on request
<b>IP rating</b>	IP65
<b>IK rating</b>	IK10 clear polycarbonate bowl
<b>Surge protection</b>	6 kV (standard) - 10 kV (optional)
<b>Certification</b>	CE - ENEC - CEE eligible certificate on request

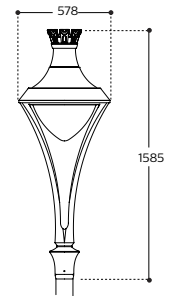

Harmony Classic LED + Classic Lyre

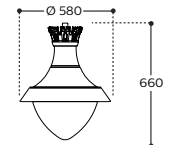

Harmony Classic LED

# ClassicStreet

<b>Type</b>	BDP794 (post-top version) BSP794 (suspended version) BPP794 (post-top version for dedicated bracket) BVP794 (suspended version for dedicated bracket)
<b>Correlated Color Temperature</b>	3,000 K (warm white) 4,000 K (neutral white)
<b>Color Rendering Index</b>	80 (warm white) - 70 (neutral white)
<b>Luminous flux</b>	1041 - 7046 (warm white), 1065 - 7032 (neutral white) depending on configuration
<b>Power</b>	12W -82W (warm white), 12W-73W (neutral white) depending on configuration
<b>Luminaire efficacy</b>	Up to 98 lm/W
<b>Lifetime (Maintenance of Lumen Output L80B10)</b>	Up to 100,000 hours
<b>Optic</b>	Distribution Medium (DM), Wide (DW), Residential Wide (DRW), Symmetrical (DS)
<b>Optical cover</b>	Tempered flat glass clear (FG), diffusing flat glass (GF) (optional)
<b>Warranty</b>	Silver 5 years
<b>Installation</b>	Post top: 60 and 76mm, Suspended 1'G
<b>CLO</b>	Available
<b>Control systems Input</b>	DALI
	CityTouch Ready
<b>Intelligence Control</b>	LumiStep (LS), DynaDimmer (DDF), LineSwitch (D11), CityTouch Ready, Photocell, MiniCell (35, 55, 75 lux)
<b>Driver</b>	Philips Advance Xitanium SR Driver
<b>Operating temperature range</b>	-20 °C < Ta < 50 °C
<b>Mains voltage</b>	220-240 V / 50-60 Hz
<b>Electrical class</b>	Class I and Class II
<b>Color</b>	Black N9 (MN332L) or Philips ultra-dark grey
	Other RAL and AKZO Futura colors available on request
<b>IP rating</b>	IP66
<b>IK rating</b>	IK09 clear flat glass, IK08 diffused flat glass
<b>Surge protection</b>	6 kV (standard) - 10 kV (optional)
<b>Certification</b>	CE - ENEC - CEE eligible certificate on request

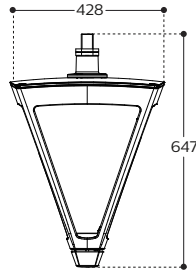

ClassicStreet suspended

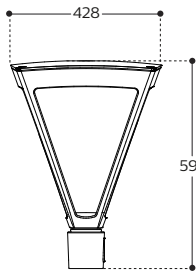

ClassicStreet post-top

# Heritage LED retrofit kit

For all heritage LED retrofit kit technical specifications pls refer to each product and their latest development. To date Villa LED and Micenas LED are available.

## Easy to install

On site, simple construction allows for quick installation (under 10 minutes) in existing luminaire

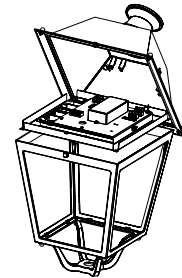
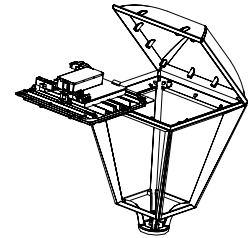

# Luminaires / Brackets compatibility

Luminaires	Villa LED	Jargeau 400 LED	Micenas gen2 LED	Harmony Classic	ClassicStreet
<b>BRACKETS</b>					
<b>Wy</b>	post top or suspended (34 Pdg)	post top or suspended (34 Pdg)	suspended (34 Pdg)	suspended (34 Pdg)	suspended retrofit (34 Pdg)
<b>Beagency</b>	suspended (34 Pdg)	suspended (34 Pdg)	suspended (34 Pdg)	suspended (34 Pdg)	suspended retrofit (34 Pdg)
<b>Ourcelles</b>	suspended (34 Pdg)	suspended (34 Pdg)	suspended (34 Pdg)	suspended (34 Pdg)	suspended retrofit (34 Pdg)
<b>Tradition</b>	suspended	suspended	suspended	suspended	suspended retrofit
<b>Reverbere</b>	suspended	suspended	suspended	suspended	suspended retrofit
<b>Aurore</b>	suspended	suspended	suspended	suspended	suspended retrofit
<b>Notre-Dame</b>	suspended	suspended	post top or suspended	suspended	suspended retrofit
<b>Solis</b>	suspended	suspended	suspended	suspended	suspended retrofit
<b>Faro</b>	post top or suspended	post top or suspended	post top or suspended	suspended	post top or suspended retrofit
<b>Century</b>	suspended	suspended	suspended	suspended	suspended retrofit
<b>Kastelle</b>	suspended	suspended	suspended	suspended	suspended retrofit
<b>ClassicStreet</b>	X	X	X	X	post top or suspended
<b>CristalCity</b>	X	X	X	X	X

# Bracket specifications

## Wy

<b>Material</b>	Steel
<b>Configuration</b>	Single, double, rear bracket, wall bracket
<b>Bracket lengths</b>	450 mm (wall bracket) 750 mm and 1 000 mm
<b>Mounting to luminaire</b>	Suspended and post-top Ø27 pdg (3/4")
<b>Mounting to support</b>	Post-top: tenon mounting. Compatible with Accante conical steel pole or Aloa conical aluminum pole (top Ø 90 mm with inserts)  Rear bracket / wall bracket: mounting with 2 points, fixing center 350 mm (S450), 420 mm (S750) & 560 mm (S1000).
<b>Tilt angle</b>	0°
<b>Colour</b>	Black N9 (MN332L) or Philips Ultra Dark Grey. Other RAL and Futura AKZO colours available on request
<b>Certification</b>	CE certification in accordance with standard EN40

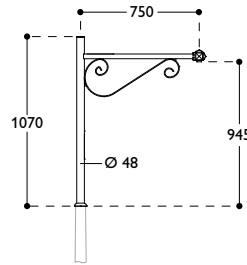

## Beagency

<b>Material</b>	Steel
<b>Configuration</b>	Single, double, rear bracket, wall bracket
<b>Bracket lengths</b>	750 mm, 900 mm and 1100 mm
<b>Mounting to luminaire</b>	Suspended Ø27 pdg (3/4")
<b>Mounting to support</b>	Post-top: tenon mounting. Compatible with Accante conical steel pole or Aloa conical aluminum pole (top Ø 60 mm with inserts)  Rear bracket/wall bracket: mounting with 2 points
<b>Tilt angle</b>	0°
<b>Colour</b>	N9 (MN332L) or Philips Ultra Dark Grey. Other RAL and Futura AKZO colours available on request
<b>Certification</b>	CE certification in accordance with standard EN40

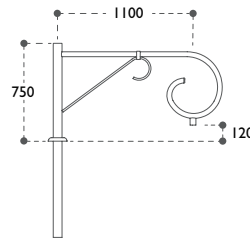

## Ourcelles

<b>Material</b>	Extruded steel
<b>Configuration</b>	Single, double, rear bracket, wall bracket
<b>Bracket lengths</b>	450 mm, 750 mm and 1000 mm
<b>Mounting to luminaire</b>	Suspended Ø 27 pdg (3/4"G) or Ø 34 pdg (1"G) with AD accessory
<b>Mounting to support</b>	Post-top: tenon mounting. Compatible with Accante conical steel pole with 2 x 4 threaded holes) or Aloa conical aluminum pole (top Ø 90 mm with 2 x 4 inserts)  Side and wall: mounting with 2 points, fixing center 450 mm (S450), 750 mm (S750) & 1000 mm (S1000).
<b>Tilt angle</b>	0°
<b>Colour</b>	Black N9 (MN332L) or Philips Ultra Dark Grey. Other RAL and Futura AKZO colours available on request
<b>Certification</b>	CE certification in accordance with standard EN40

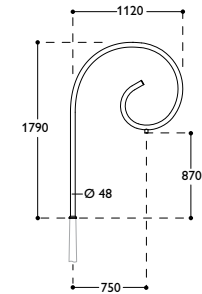

## Tradition

<b>Material</b>	Aluminium
<b>Configuration</b>	Single, double, rear bracket, wall bracket
<b>Bracket lengths</b>	630 mm, 700 mm and 880 mm
<b>Mounting to luminaire</b>	Suspended Ø 34 pdg (1"G)
<b>Mounting to support</b>	Post-top: tenon mounting. Compatible with Accante conical steel pole with Post-top cap compatible with conical range poles in steel Accante or in aluminium Aloa  Side mounting: with brace or tradition satellite with 2 points  Rear bracket: mounting with 2 points  Wall bracket: mounting with 3 points
<b>Tilt angle</b>	0°
<b>Colour</b>	Black N9 (MN332L) or Philips Ultra Dark Grey. Other RAL and Futura AKZO colours available on request
<b>Certification</b>	CE certification in accordance with standard EN40

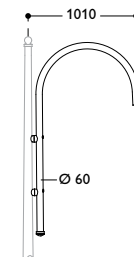

# Reverbere

<b>Material</b>	Aluminium
<b>Configuration</b>	Single, double, rear bracket, wall bracket
<b>Bracket lengths</b>	900 mm and 1150 mm
<b>Mounting to luminaire</b>	Suspended Ø 34 pdg (1" G)
<b>Mounting to support</b>	Post-top: tenon mounting. Compatible with Accante conical steel pole (top 60 mm) with 2 x 4 threaded holes) or Aloa conical aluminum pole (top Ø 90 mm with 2 x 4 inserts)  Rear bracket/wall bracket: mounting with 2 points
<b>Tilt angle</b>	0°
<b>Colour</b>	Black N9 (MN332L) or Philips Ultra Dark Grey. Other RAL and Futura AKZO colours available on request
<b>Certification</b>	CE certification in accordance with standard EN40

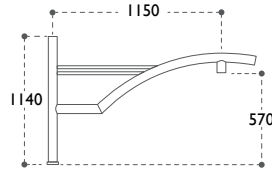

# Notre-dame

<b>Material</b>	Aluminium
<b>Configuration</b>	Single, double, rear bracket, wall bracket
<b>Bracket lengths</b>	730 mm and 1050 mm
<b>Mounting to luminaire</b>	Suspended Ø 34 pdg (1" G)
<b>Mounting to support</b>	Post-top: tenon mounting. Compatible with Accante conical steel pole (top Ø 89 mm with 2 x 4 threaded holes) or Aloa conical aluminum pole (top Ø 90 mm with 2 x 4 inserts)  Wall bracket: mounting with 3 points, fixing center 110 x 500 mm
<b>Tilt angle</b>	0°
<b>Colour</b>	Black N9 (MN332L) or Philips Ultra Dark Grey. Other RAL and Futura AKZO colours available on request
<b>Certification</b>	CE certification in accordance with standard EN40

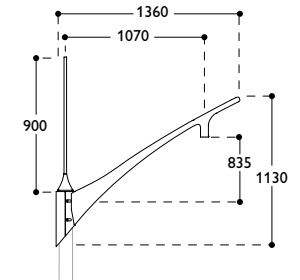

# Aurore

<b>Material</b>	Aluminium
<b>Configuration</b>	Single, double, rear bracket, wall bracket
<b>Bracket lengths</b>	840 mm and 1300 mm
<b>Mounting to luminaire</b>	Suspended Ø 34 pdg (1" G)
<b>Mounting to support</b>	Post-top: tenon mounting. Compatible with Accante conical steel pole (top 60 mm) with 2 x 4 threaded holes) or Aloa conical aluminum pole (top Ø 90 mm with 2 x 4 inserts)  Rear bracket/wall bracket: mounting with 2 points
<b>Tilt angle</b>	0° (PM) and 2° (GM)
<b>Colour</b>	Black N9 (MN332L) or Philips Ultra Dark Grey. Other RAL and Futura AKZO colours available on request
<b>Certification</b>	CE certification in accordance with standard EN40

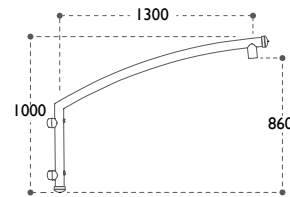

# Solis

<b>Material</b>	Extruded cast aluminium
<b>Configuration</b>	Single, double, rear bracket, wall bracket
<b>Mounting to luminaire</b>	Suspended Ø 34 pdg (1" G)
<b>Bracket lengths</b>	700 mm and 1100 mm
<b>Mounting to support</b>	Post-top: tenon mounting. Compatible with Accante conical steel pole (top Ø 60 or 62 mm with 2 x 4 threaded holes)  Rear bracket: mounting with 2 points, fixing centre 400 mm. Compatible with Accante conical steel pole or Aloa conical aluminium pole (top Ø 90 mm with inserts)  Wall bracket: mounting with 3 points, fixing centre 110 x 500 mm
<b>Tilt angle</b>	0°
<b>Colour</b>	Black N9 (MN332L) or Philips Ultra Dark Grey. Other RAL and Futura AKZO colours available on request
<b>Certification</b>	CE certification in accordance with standard EN40

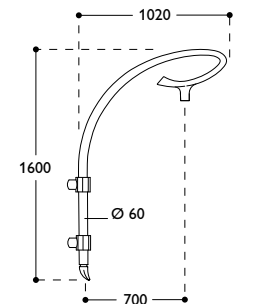
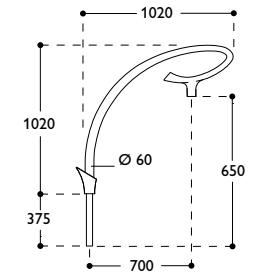

# Faro

<b>Material</b>	Cast aluminium
<b>Mounting to luminaire</b>	Post-top or suspended Ø 34 pdg (1" G)
<b>Bracket lengths</b>	400 mm, 700 mm and 900 mm
<b>Mounting to support</b>	Rear bracket / wall bracket: mounting with 2 points, fixing center: 200 mm (Faro S400), 430 mm (Faro S700), 525 mm (Faro S900)
<b>Tilt angle</b>	0°
<b>Finish</b>	Satin Silver Grey (close to RAL 9006) Philips Ultra Dark Grey (close to RAL 7043). Other RAL or Akzo Nobel Futura colors are available on request
<b>Certification</b>	CE certification in accordance with standard EN40

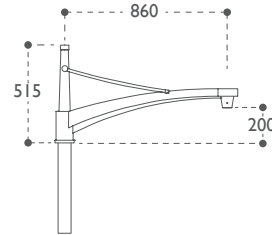
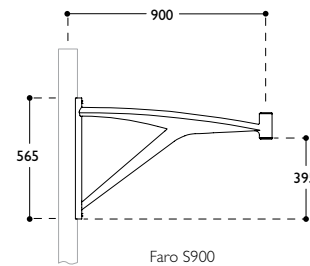
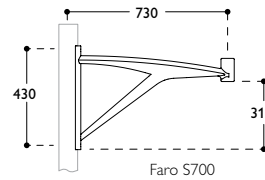
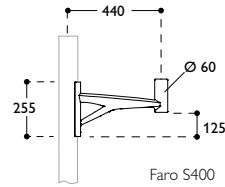

# Faro poles

<b>Material</b>	Aluminium
<b>Hauteurs</b>	Faro Applique pole: 4,7 m - 5,5 m Faro top pole: 3,5 m - 4 m - 4,5 m - 4,8 m
<b>Mounting to luminaire</b>	Post top Ø 60 mm
<b>Fixation du mât au sol</b>	Base plate 200 x 200 mm
<b>Tilt angle</b>	0°
<b>Colour</b>	Satin Silver Grey (close to RAL 9006) Philips Ultra Dark Grey (close to RAL 7022) Other RAL or Akzo Nobel Futura colors available on request
<b>Certification</b>	CE certification in accordance with standard EN40

# Century

<b>Material</b>	Aluminium
<b>Configuration</b>	Single, double, wall bracket
<b>Bracket lengths</b>	860 mm
<b>Mounting to luminaire</b>	Suspended Ø 34 pdg (1" G)
<b>Mounting to support</b>	Post-top: tenon mounting. Compatible with Accante conical steel pole (top Ø 90 mm) or Aloa conical aluminum pole (top Ø 90 mm with inserts) Rear bracket/wall bracket: mounting with 2 points
<b>Tilt angle</b>	0°
<b>Colour</b>	Black N9 (MN332L) or Philips Ultra Dark Grey. Other RAL and Futura AKZO colours available on request
<b>Certification</b>	CE certification in accordance with standard EN40

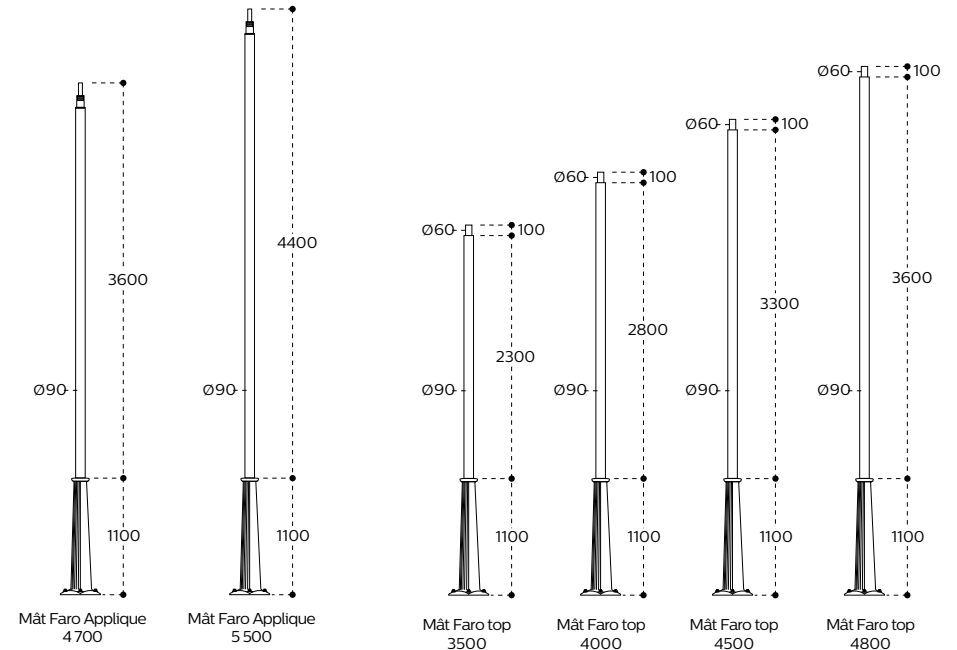



## ClassicStreet bracket 60

<b>Material</b>	Steel
<b>Configuration</b>	Single, double, rear bracket, wall bracket
<b>Bracket lengths</b>	750 mm
<b>Mounting to luminaire</b>	Dedicated interface post top or suspended
<b>Mounting to support</b>	Single or double arm bracket tenon for pole top top Ø 60 mm
	Pole mounting bracket mounting with 2 points and fixing center 240 mm
<b>Tilt angle</b>	0°
<b>Finish</b>	Black N9 or Philips Ultra Dark Grey, other RAL colors available on request
<b>Certification</b>	CE certification in accordance with standard EN40

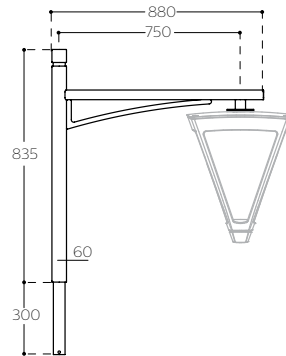

## ClassicStreet bracket 76

<b>Material</b>	Steel
<b>Configuration</b>	Single, double, rear bracket, wall bracket
<b>Bracket lengths</b>	750 mm
<b>Mounting to luminaire</b>	Dedicated interface post top or suspended
<b>Mounting to support</b>	Single or double arm bracket cap for pole top Ø 76 mm
	Pole mounting bracket mounting with 2 points and fixing center 240 mm
<b>Tilt angle</b>	0°
<b>Finish</b>	Black N9 or Philips Ultra Dark Grey, other RAL colors available on request
<b>Certification</b>	CE certification in accordance with standard EN40

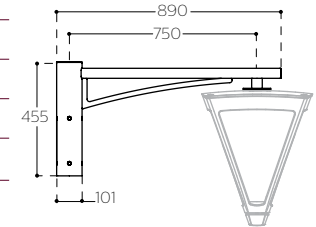

## Kastelle

<b>Material</b>	Extruded aluminium
<b>Bracket lengths</b>	800 mm and 1110 mm
<b>Mounting to luminaire</b>	Suspended Ø 34 pdg (1" G)
<b>Mounting to support</b>	Post-top: tenon mounting. Compatible with Accante conical steel pole (top Ø 60 or 62 mm with 2x4 threaded holes)
	Wall bracket: mounting with 3 points, fixing centre 110 x 500 mm
	Rear bracket: mounting with 2 points, fixing centre 400 mm
<b>Tilt angle</b>	0°
<b>Finish</b>	Polyester coating in RAL colours or Akzo Nobel Futura colours
<b>Certification</b>	CE certification in accordance with standard EN40

