

**PHILIPS**

Sensors

EasySense

Fixture-Mount



# Single, compact cost-effective fixture control

Philips EasySense Fixture-Mount Sensors

# Your easy path to adding controls to every fixture

Until now, it hasn't been simple or cost-effective to add sensors to every luminaire in order to meet stringent customer energy-saving requirements or to address code-compliance strategies. Most sensors use a bulky two-box system that is expensive and cumbersome to design-in and install. The sensors are also typically remote mounted from the fixtures, installed in the ceiling and unsightly to occupants.



However, the Philips EasySense fixture-mount sensor, with an exceptional single-box format, makes it easy to save both time and cost when integrating occupancy sensing and daylight harvesting to every luminaire. EasySense fixture-mount sensors are connected to Philips Advance Xitanium SR LED drivers with two simple wires to reduce design-in complexity and facilitate installation while becoming an integral part of energy-saving and code-compliance strategies.

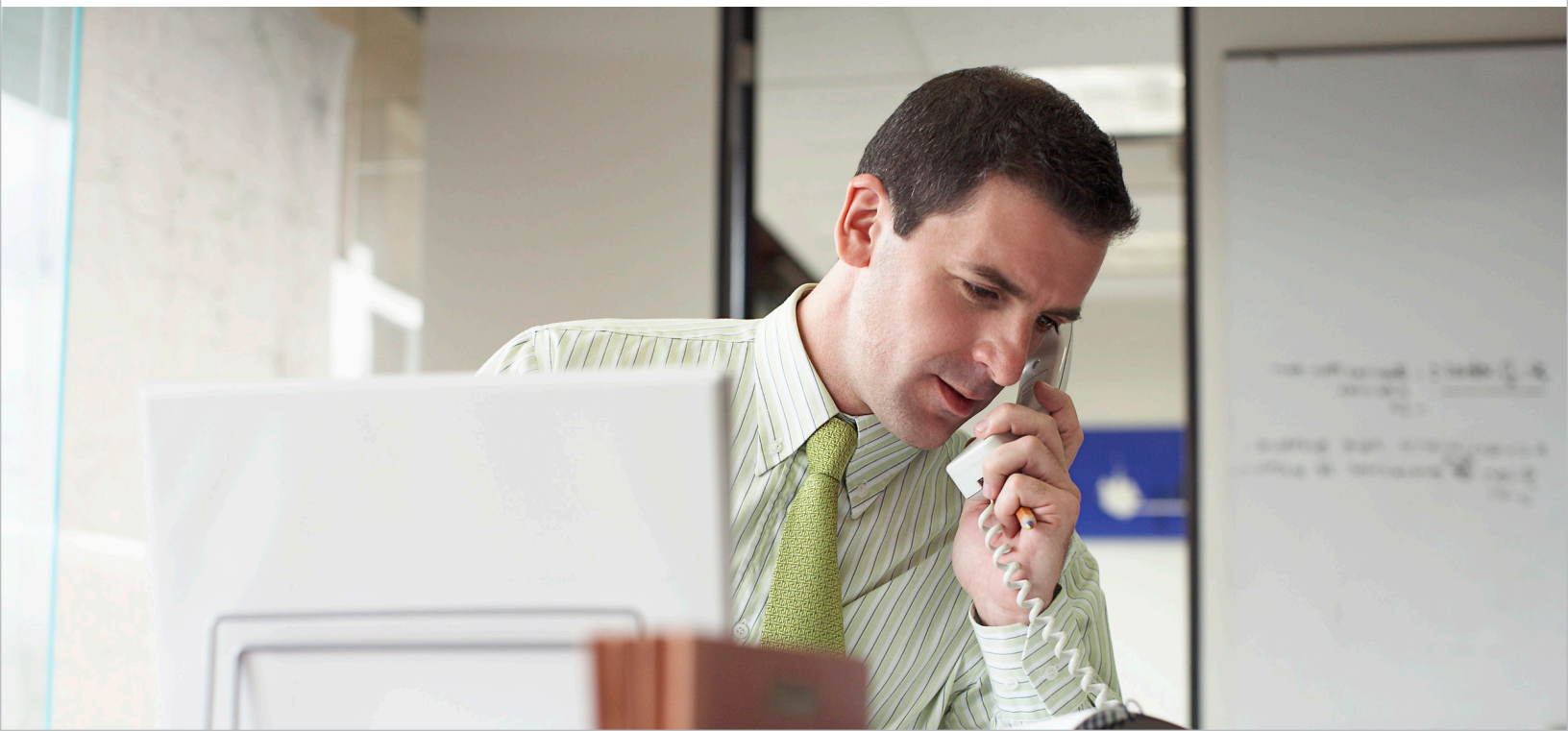

### EasySense and Specifiers: Increase project efficiency

Specify Philips EasySense fixture-mount sensors as part of energy-saving and code-compliance strategies without hindering project time or aesthetics:

- Single-box format reduces installation time and eliminates the need to wire sensors outside the fixture in the ceiling, so projects can be completed quickly and with reduced chance of errors.
- Integrated sensors blend within the luminaire, leaving the ceiling uncluttered.

### EasySense and OEMs: Increase speed to market

Incorporate Philips EasySense fixture-mount sensors as part of a standard fixture portfolio while saving design time and money:

- Compatibility with Philips Advance Xitanium SR LED drivers eliminates the need for auxiliary devices and alleviates time-consuming configuration issues.
- Simple two-wire connection from driver to sensor reduces design-in complexity and additional components that add to overall costs.
- Streamlined process allows products to be brought to market quickly.

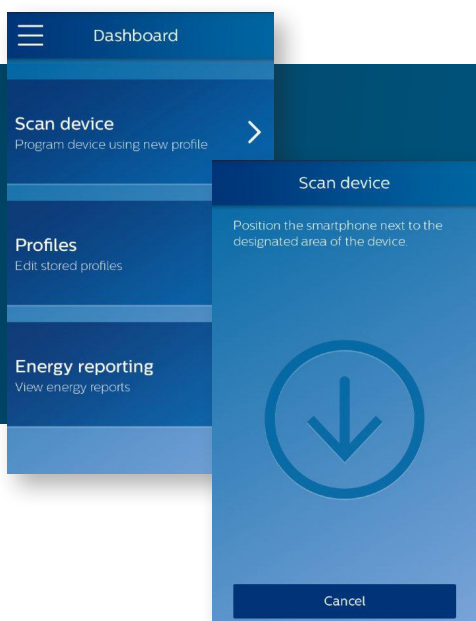

**Convenient smartphone-based app** allows programming of occupancy/daylight sensing parameters, fine-tuning of lumen levels during installation and readout of final fixture power.

**For additional information on how EasySense fixture-mount sensors can quickly and easily facilitate code requirements, go to [www.philips.com/easysense](http://www.philips.com/easysense) or contact your local Philips sales representative.**



©2015 Koninklijke Philips N.V. All rights reserved. Philips reserves the right to make changes in specifications and/or to discontinue any product at any time without notice or obligation and will not be liable for any consequences resulting from the use of this publication.

PLT-1589BR 08/15 [philips.com/easysense](http://philips.com/easysense)

Philips Lighting  
North America Corporation  
10275 W. Higgins Road  
Rosemont IL 60018  
Tel: 800-322-2086  
Fax: 888-423-1882  
Customer/Technical Service:  
800-372-3331  
OEM Support: 866-915-5886

Imported by: Philips Lighting,  
A division of Philips Electronics Ltd.  
281 Hillmount Rd,  
Markham, ON, Canada L6C 2S3  
Tel. 800-668-9008