

# Installation Notes for

## Philips M2740A #C05, FM20/30-System-Cart



### Contents



Antenna Holder Kit  
angle mounted

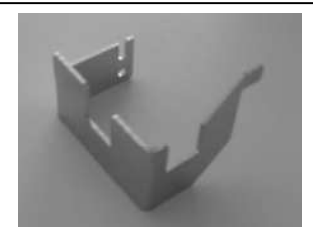

Pull relief sheet

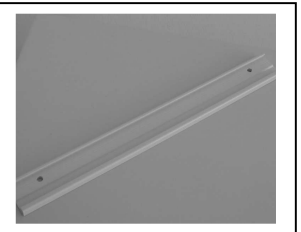

Pair of runners for Foot-Location

- Screws :
- M3,5x10 (4x) for Avalon CTS
  - M4x20 (4x) incl. washers for display
  - M4x16 (4x)
  - M12x30 (2x) incl. lock washer for monitor column
  - M4x10 (4x) bolts for FM20/30-monitor
  - M6x12 (4x) bolts for runner for Foot-Location

Caps for D6,5 mm (2x)

#### Attached tools

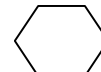
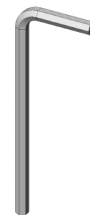

Size:  
3  
4  
5  
10

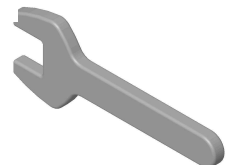

## Unlocking rear panel

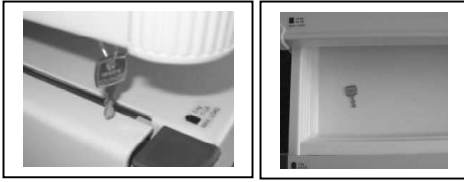

Key 1 placed at shelf  
Key 2 placed in drawer (in plastic bag)

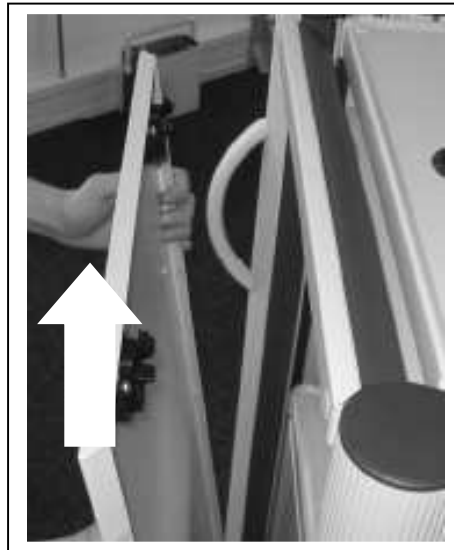
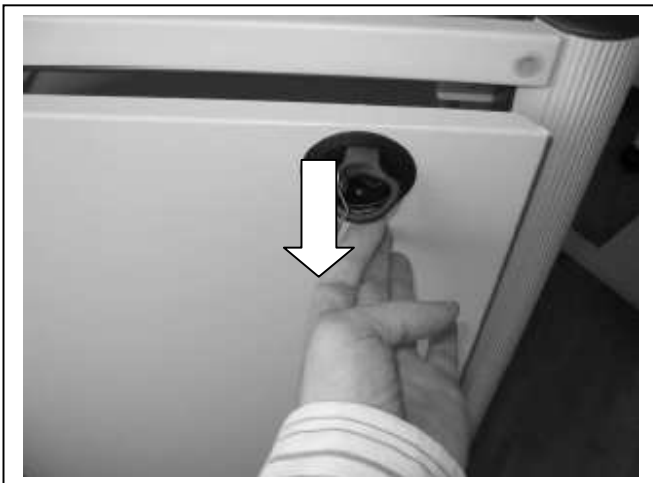

Remove flat bin pushing before removing panel

## Mounting of monitor column

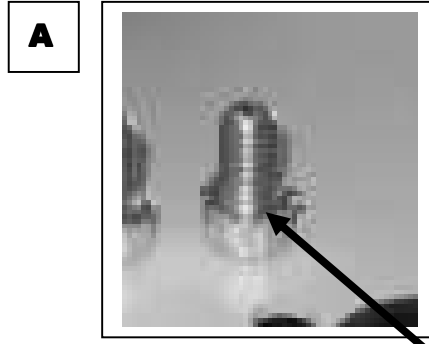
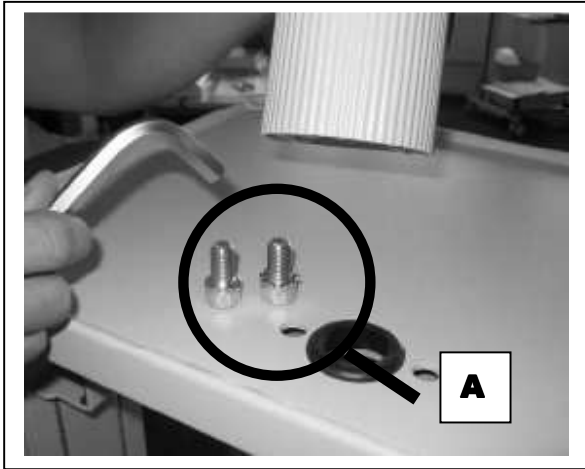

Use lock washer (1x)

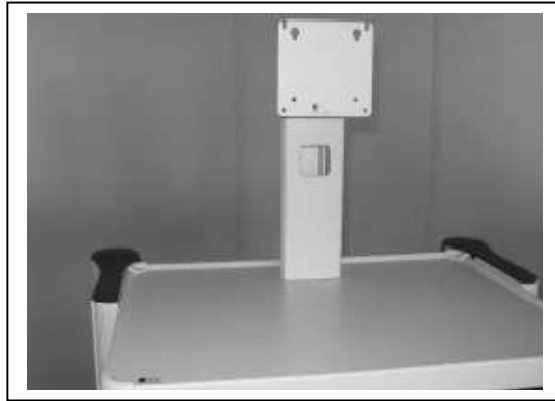

Attach column with  
screws: **M12x30 (2x)**

---

## Demounting of front lower shelf

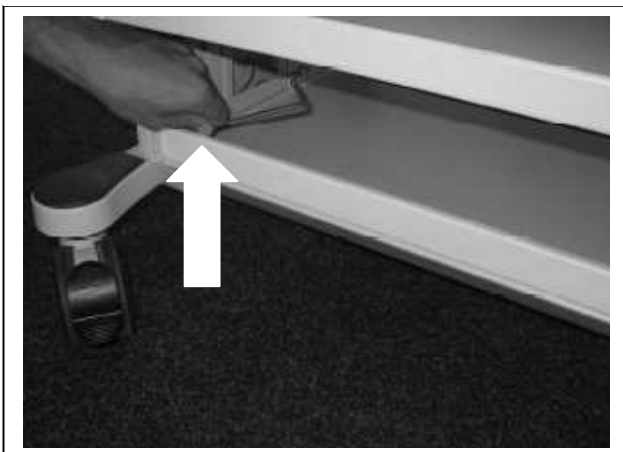

## Placing of transformator and power supply



Mount bar after placing equipment



---

## Placing of PC-housing



## Placing of Avalon CTS

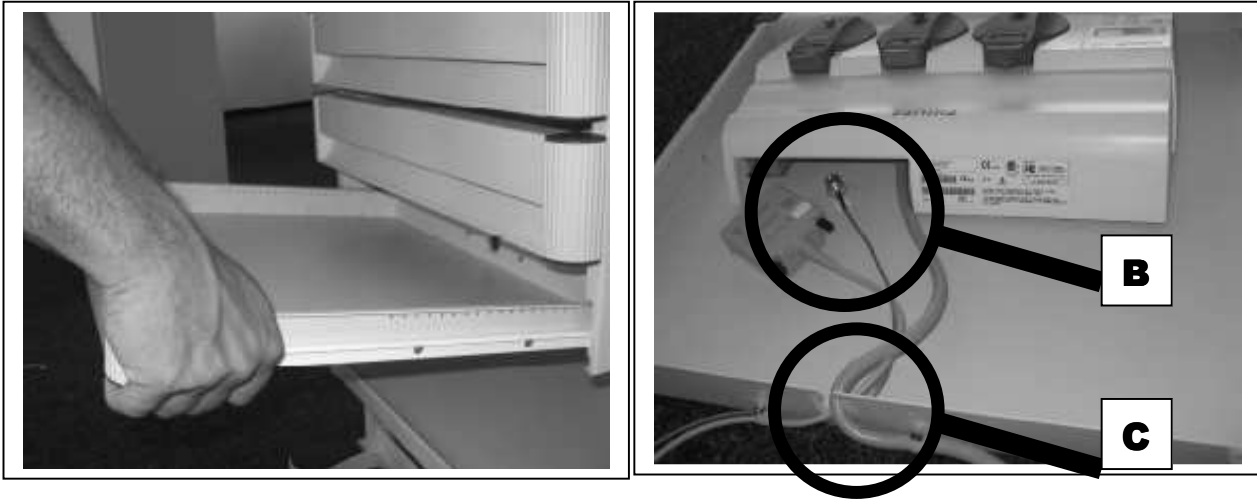

Remove Avalon drawer

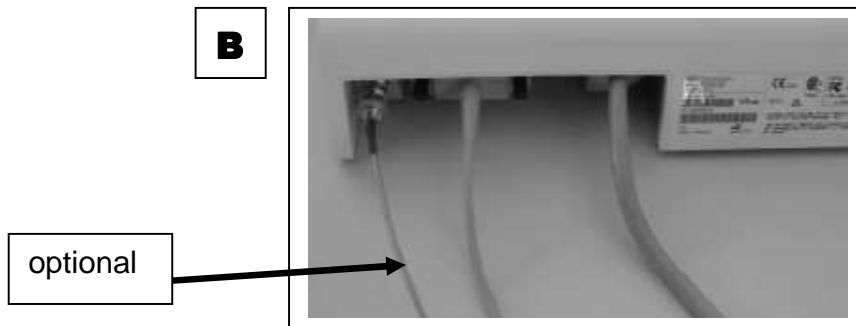

### Using the pull relief sheet

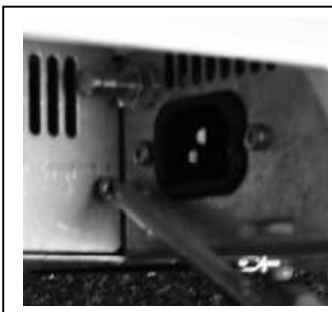

Remove screw with TORX T10

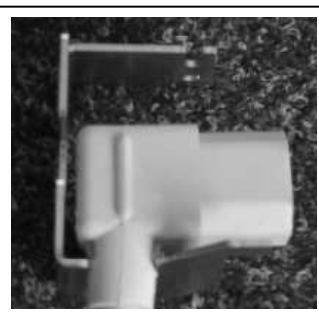

Place IEC 320 in sheet

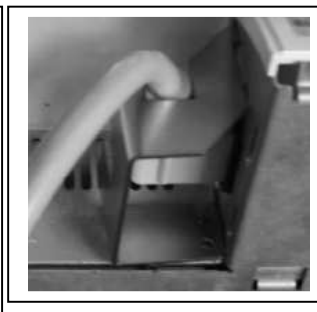

Place sheet an IEC 320 in Avalon CTS



Fix screw with TORX T10



**C**

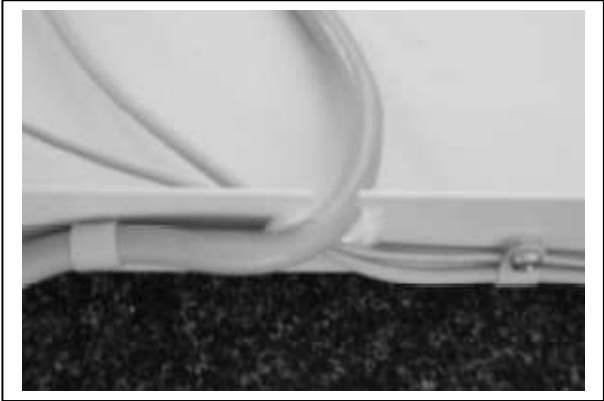

Screw Avalon CTS with  
**M3,5 x 10 (4x)**

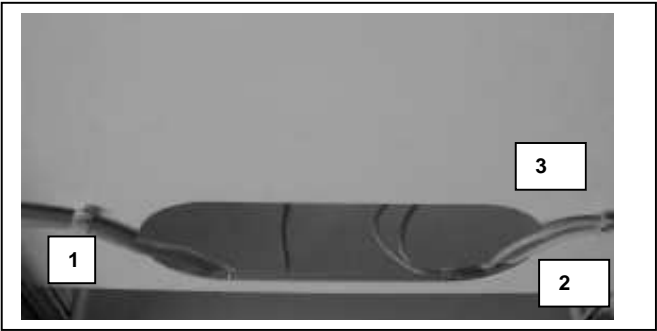
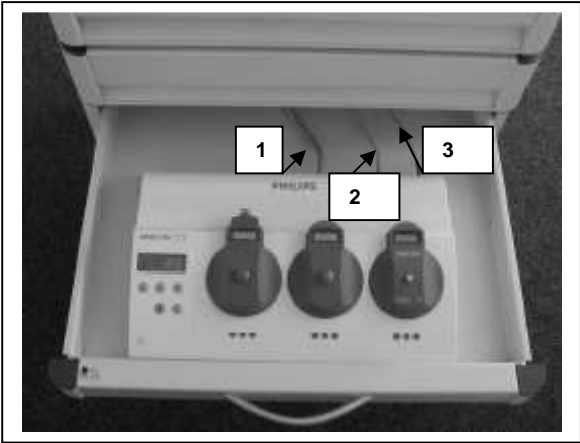

Cable "3" optional

### Mounting of display

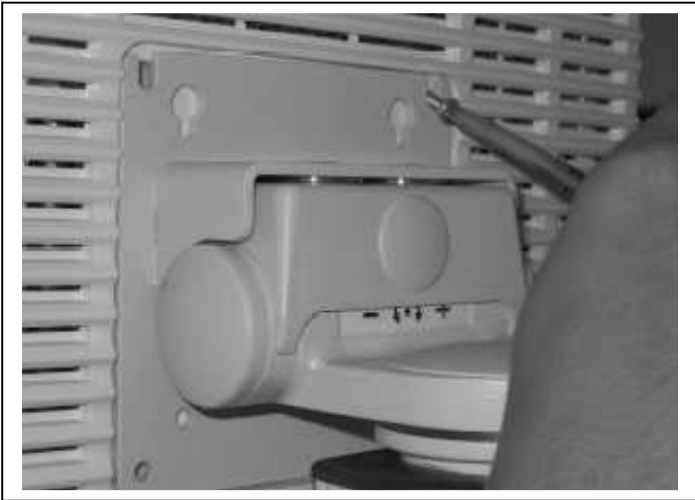

Fix display with 2. hand while screwing  
screws: **M4x20 (4x)**  
**M4x16 (4x)**  
**depending on flat screen**

Optional: M4 washers

## Placing of the keyboard



---

## Placing of FM20/30-monitor

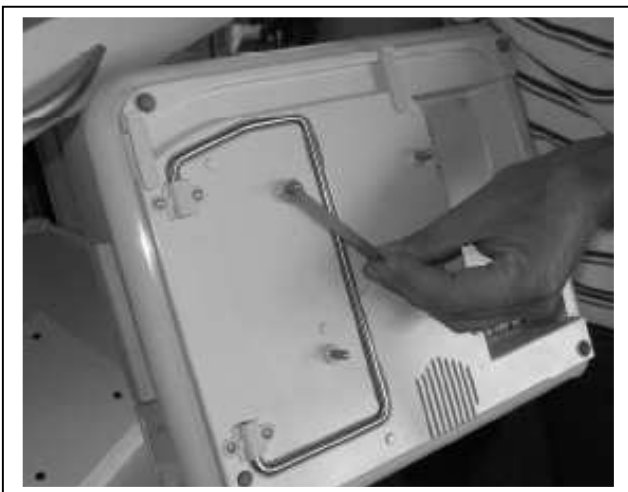

**CLICK!!!**

## Preparing cart for FM40/50-monitor

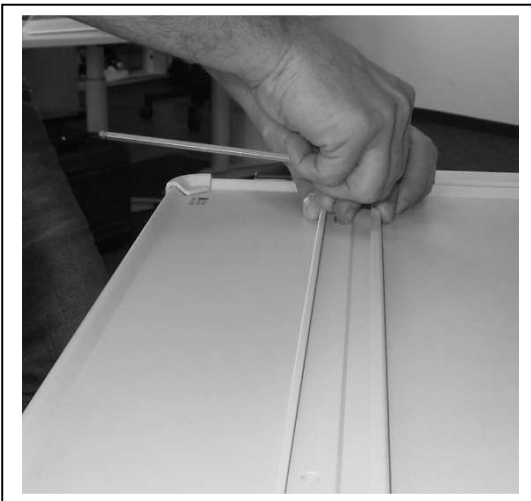

Attach runners with  
screws: **M6x12 (4x)**

Cap drillings with **caps**  
**6,5mm (2x)**



# Locking rear panel

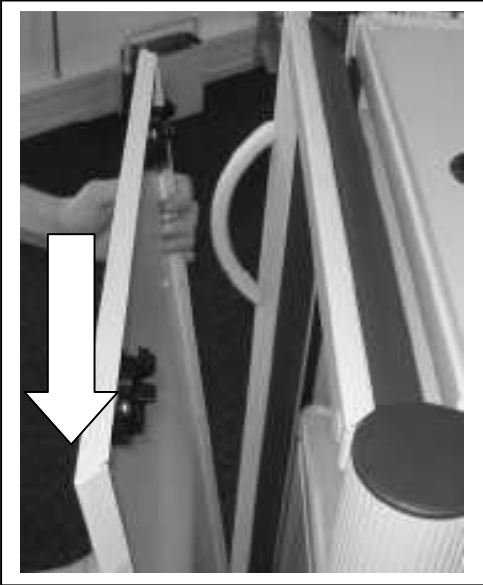

Fix flat bin pushing before placing panel

Lock rear panel and keep key in a secure place

## Option: Mounting of antenna holder

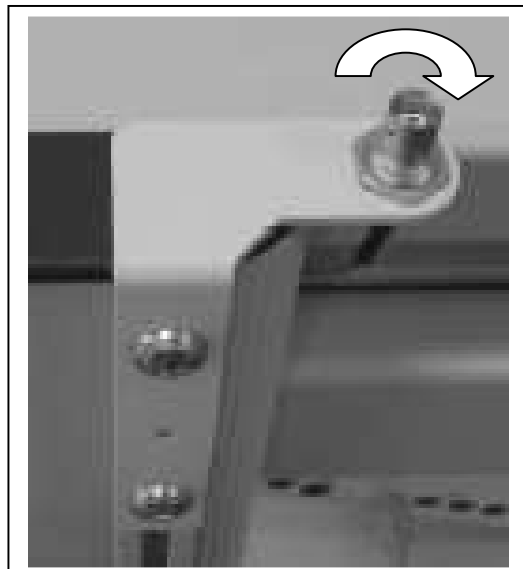
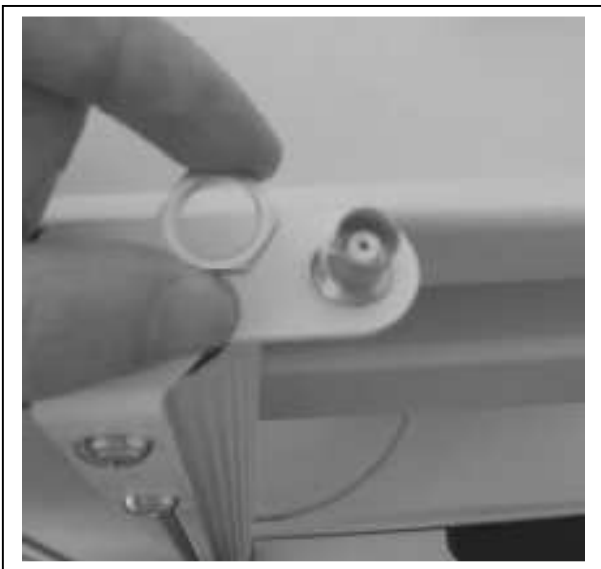
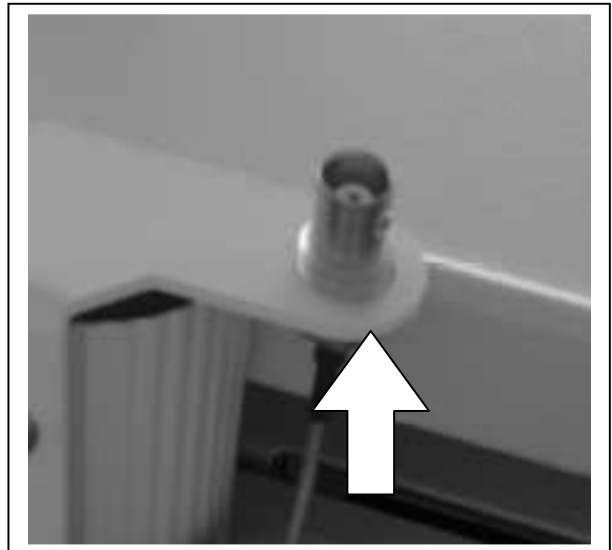

Fix antenna cable with cable winder

Cut off cable winder

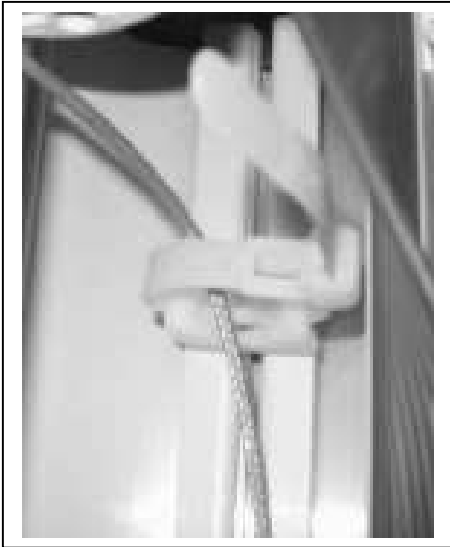

Use cable winder in power column to fix antenna cable