



DUS30-LHB-DALI Multifunction Sensor

Long-range high bay DALI network sensor

The DUS30-LHB-DALI is a multifunction sensor that combines motion detection (PIR) and ambient light level detection (PE) in one device. The sensor uses the DALI protocol for power and communications to a network control system, eliminating the need for additional network field wiring. This sensor is useful for long-range and trip detection.

- MultiMaster compatible — Fully compatible with a Philips Dynalite DALI MultiMaster controller, such as the DDBC120-DALI.
- Motion detection feature — Detects the presence or absence of motion and triggers a programmed action.
- Ambient light level detection — In applications where it is critical to maintain precise lighting levels, the PE function reads ambient levels and adjusts artificial light accordingly.
- Daylight harvesting — When used in conjunction with networked open loop day lighting sensor.
- Infrared receive capability — Enables sign-in identification to the networked system.
- Additional networking advantages — Including reporting and monitoring software tools.
- Targeted positioning — Directional wall-mounting block allows sensors to be easily mounted and directed to the required area.

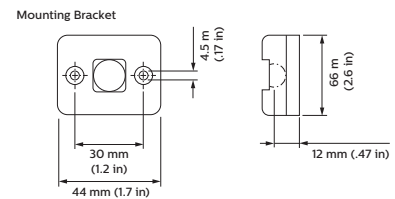
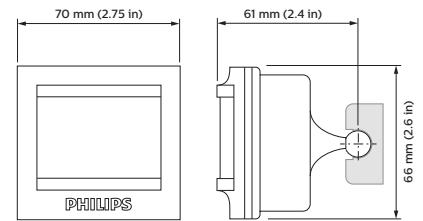

For detailed product information, please refer to the product information pages at www.philips.com/dynalite and follow the links.

Specifications

Due to continuous improvements and innovations, specifications may change without notice.

Item	Specification	Details
Sensor	Motion Detector	Standard sensitivity Maximum detection range: 30.5 m Detection pattern: 3 x 25 m Detection zones: 30° wide angle lens with 14 beams in 4 detection layer. LED activation indicator Sensor: Dual element pyroelectric
	PE Cell	Range 5 lux to 10,000 lux (incident on sensor) Range 5 lux to 10,000 lux (illumination of non-reflective surface in sensor field of view)
	IR Receiver	Philips RC5 codes Network sign-on functionality only 12 m max range
Interface	Controls	Walk test, IR received, LED indicator, & Service pushbutton
Network	Connection	30 cm fly lead
	DALI Power Consumption	9 mA
	DALI Supply Requirements	9.5 - 22.5 VDC
	Control Bus	DALI bus with a Philips Dynalite MultiMaster controller
	Configurations	All functions remotely programmable
Physical	Dimensions (H x W x D)	66 mm x 70 mm x 61 mm (2.6" x 2.75" x 2.4")
	Packed Weight	0.116 kg (0.26 lbs)
	Construction	Polycarbonate White (RAL 9010)
	Operating Conditions	Temperature: -5 to 50°C ambient Humidity: 10 to 90% non-condensing
	Storage & Transport	Temperature: -25 to 60°C ambient Humidity: 0 to 90% non-condensing
Certification	Certification	CE, C-Tick
Options & Ordering	Standard Product	DUS30-LHB - DALI (Philips 12NC - 913703015609)

Lens Pattern

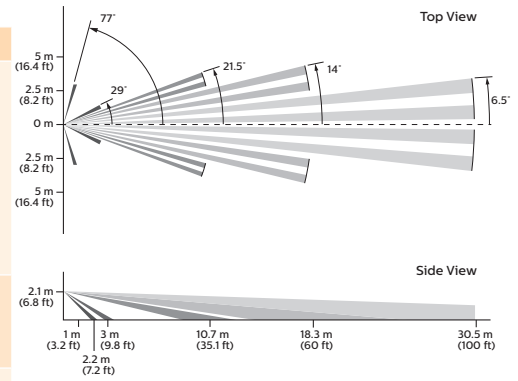

Philips Dynalite
6 / 691 Gardeners Road
Mascot, NSW 2020
Australia
Tel: +61 2 8338 9899
Email: dynalite.info@philips.com
Web: www.philips.com/dynalite

Specifications subject to change without notice. ©WMGD Pty Ltd Trading as Dynalite. Unit 6, 691 Gardeners Road Mascot 2020 Australia. ABN 33 097 246 921. All rights reserved. Dynalite, DyNet and associated logos are the registered trademarks of WMGD Pty Ltd. Not to be reproduced without permission.