

Title: InstantFit LED Lamp Installation Tips
Date: December - 2014
Contact: Philips Customer Care

For a successful installation of Philips InstantFit T8 LED lamps, Philips recommends the following steps:

1. Determine the ballast installed in the field.
2. Check the InstantFit compatibility list at www.philips.com/instantfit for Instant-Start, programmed-start and emergency ballasts compatible with the InstantFit T8 LED lamps.
3. If the ballast is not on the compatibility list, contact your Philips representative.

When installing LED T8 lamps that are compatible with the existing fluorescent ballast, the following steps are recommended:

1. Damaged lamp holders must be replaced before installing LED T8 Lamps

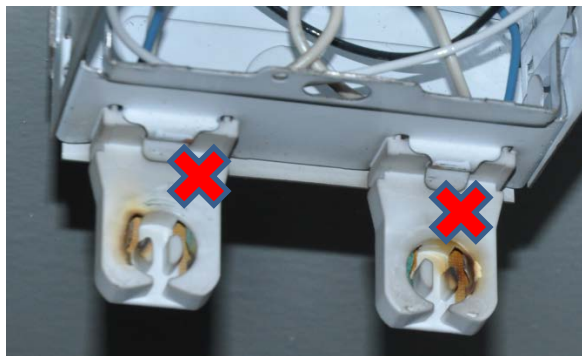

Figure 1: Damaged Lamp Holders must be replaced

2. Ensure that lamp sockets are clean and free from any debris or contamination. If lamp holders are contaminated, it is recommended to replace the lamp sockets

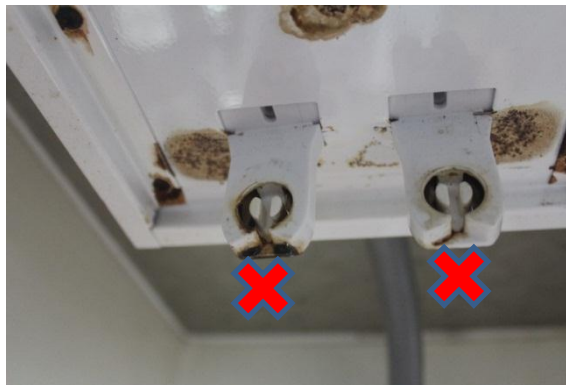

Figure 2: Lamp sockets must be free from debris or contamination

Title: InstantFit LED Lamp Installation Tips
Date: December - 2014
Contact: Philips Customer Care

- Lamp holders must be secured firmly to the fixture. Use the lamp holders that are recommended by the fixture manufacturer.

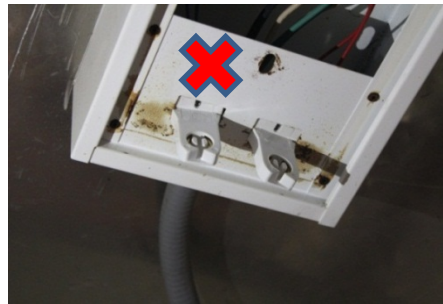

Figure 3: Incorrect lamp holder for the fixture

- Verify the alignment of the sockets along the length of the fixture to ensure that the T8 LED lamp is making a good snug contact with their respective lamp holders. Over time, an incorrect alignment can cause the lamp to come loose. A tight fit is better than a loose one.

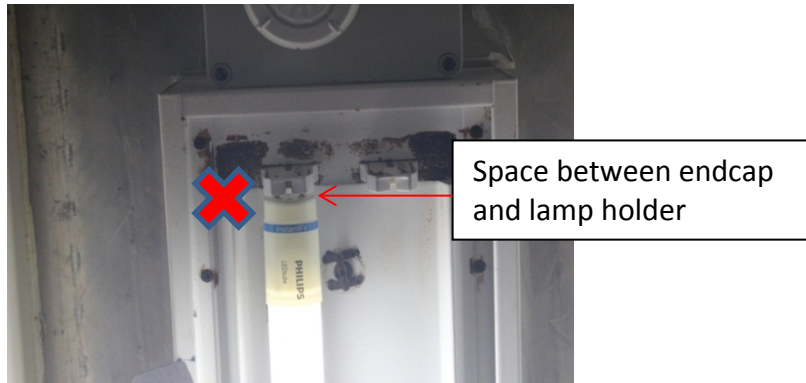

Figure 4: No space should exist between the lamp end cap and the socket

- Ensure that the T8 LED lamp is seated (secured) properly in their respective lamp holders.

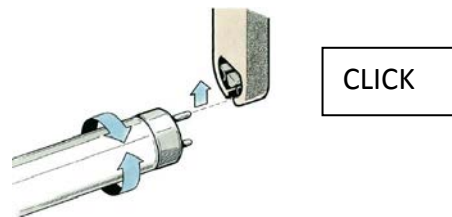

Figure 5: Lamp must be seated properly into the lamp holder

Title: InstantFit LED Lamp Installation Tips
Date: December - 2014
Contact: Philips Customer Care

Frequently asked questions:

1. When do I use a shunted socket and when do I use an unshunted socket?

Use unshunted sockets (see figure 6 for example) for rapid-start ballasts and shunted sockets (see figure 7 for example) for instant-start ballasts



Figure 6: Example of Unshunted Socket (provision for two wires)



Figure 7: Example of Shunted Socket (no opening on one side)

2. I have an industrial application where there is a lot of vibration. Does Philips have any recommendations for such an application?

Industrial equipment could cause high and low frequency vibrations in the structure of the building. In such applications use “rotor-lock” lamp holders (figure 8) to secure the lamp in the socket.

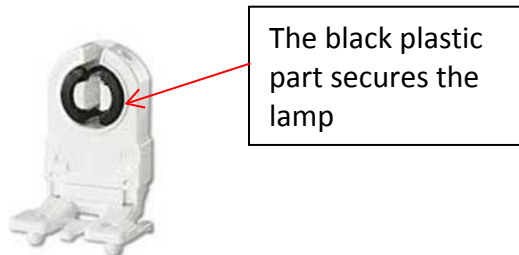

Figure 8: Example of a "Rotor-Lock" lamp holder

